



CAD-Bibliothek
CAD Library

Stahl-Systeme
Türsysteme

Jansen-Economy 60 – ungedämmt

Steel Systems
Door Systems

Jansen-Economy 60 – non insulated

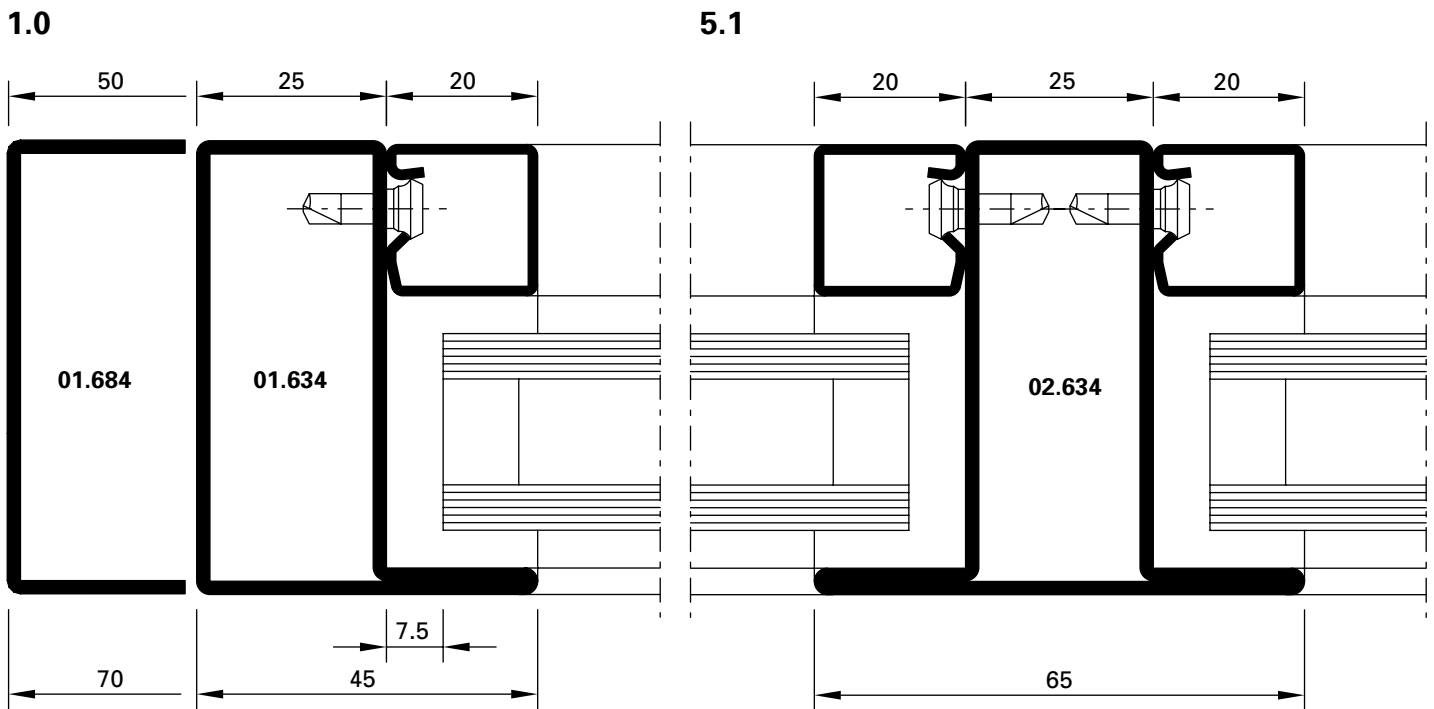
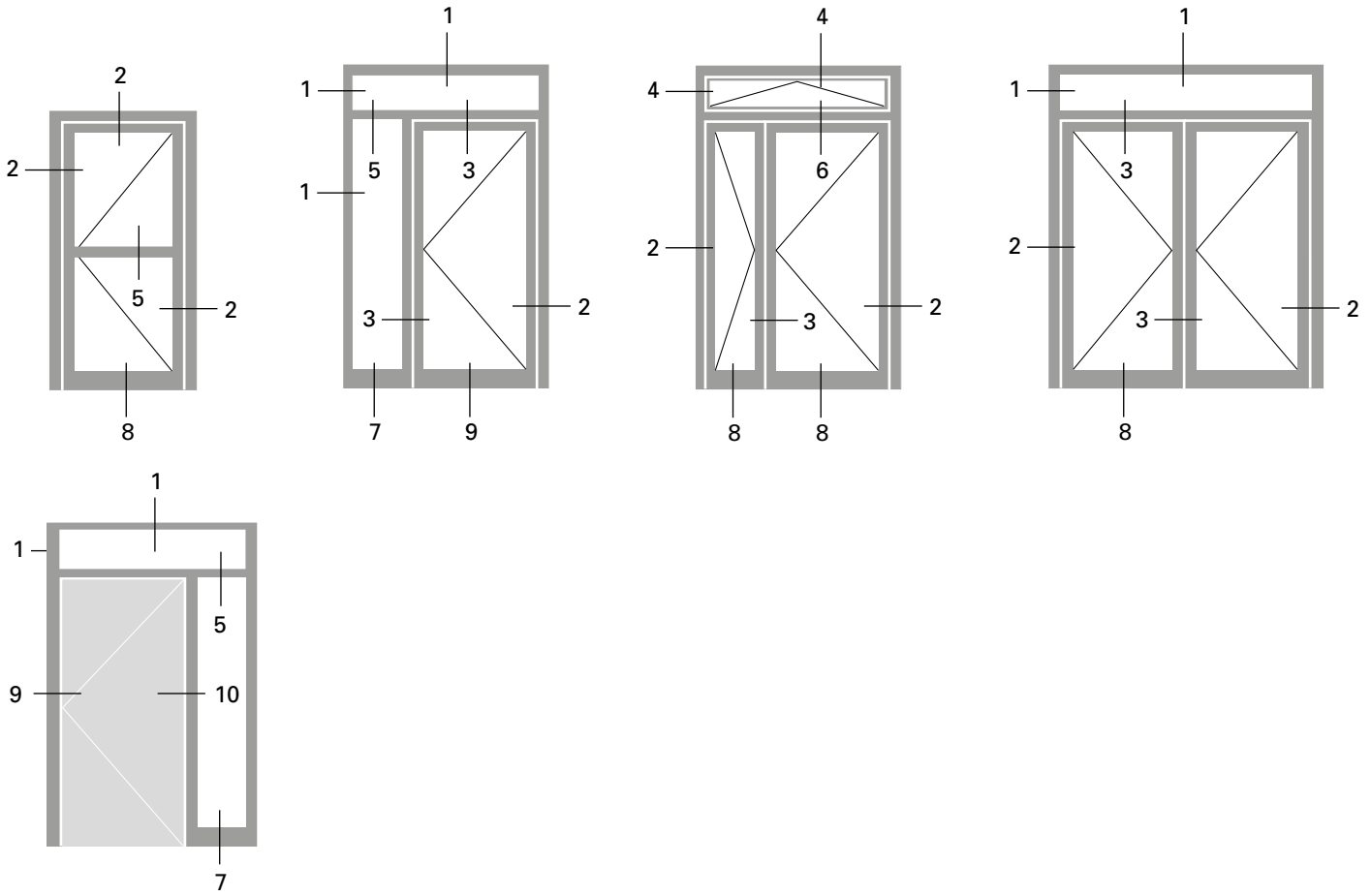

DXF DWG D-250-C-001

DXF DWG D-250-C-032

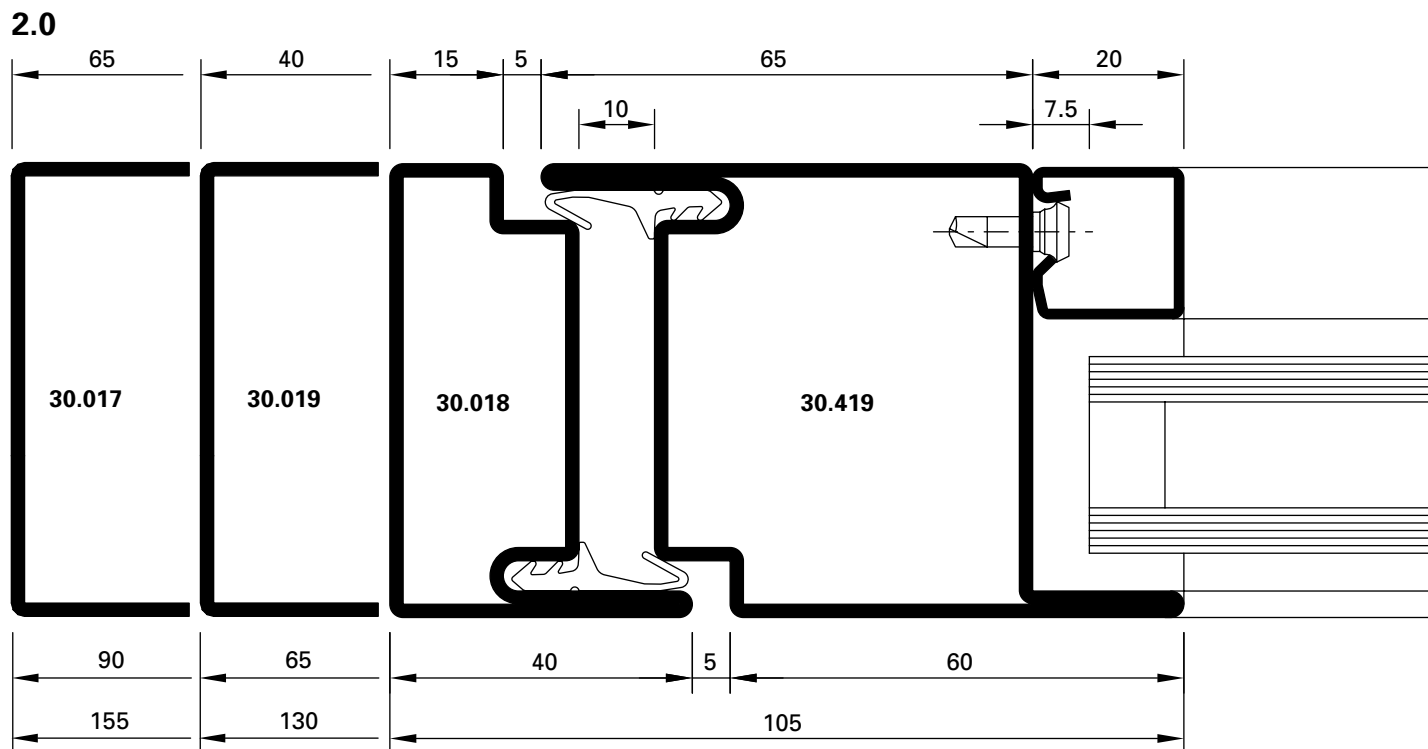

DXF **DWG** D-250-C-002

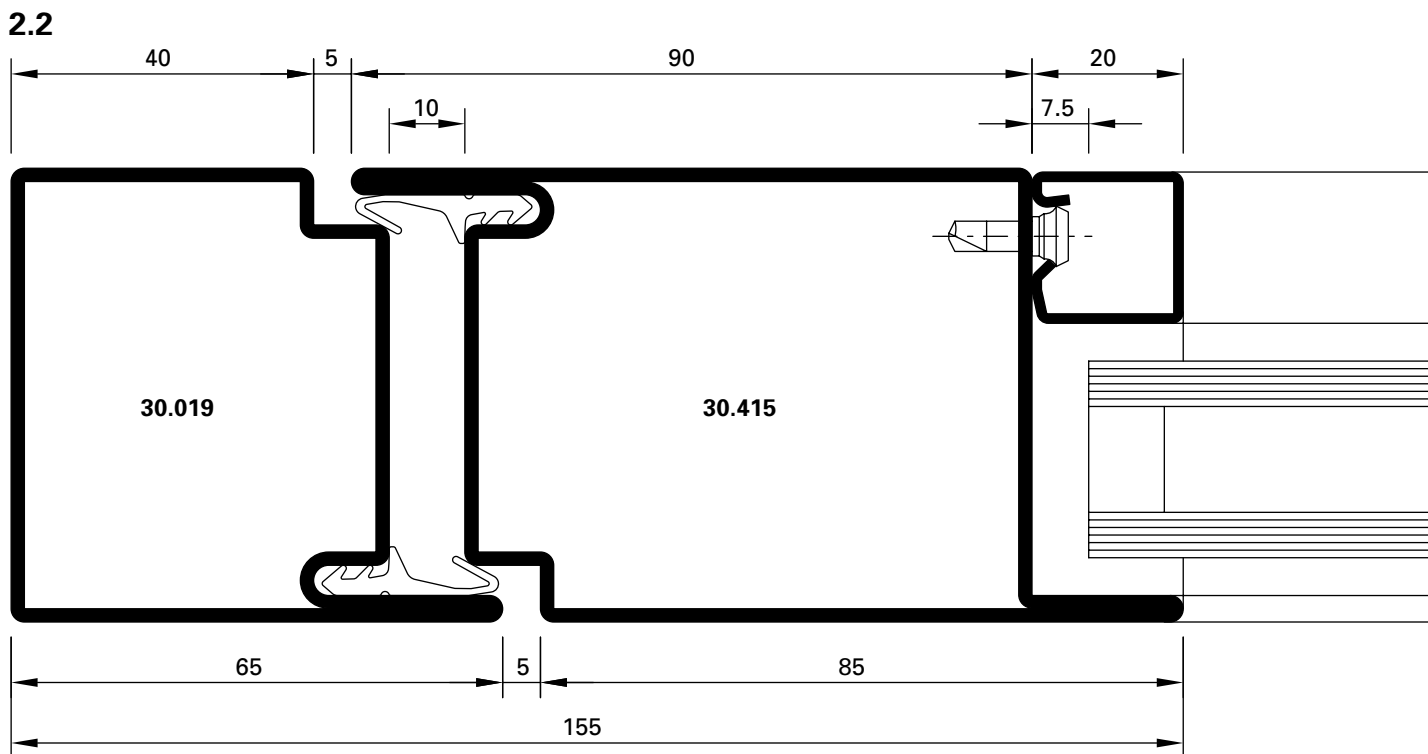

DXF **DWG** D-250-C-005

Schnittpunkte im Massstab 1:1
Coupe de détails à l'échelle 1:1
Section details on scale 1:1

Jansen-Economy 60 Türen
Jansen-Economy 60 portes
Jansen-Economy 60 doors

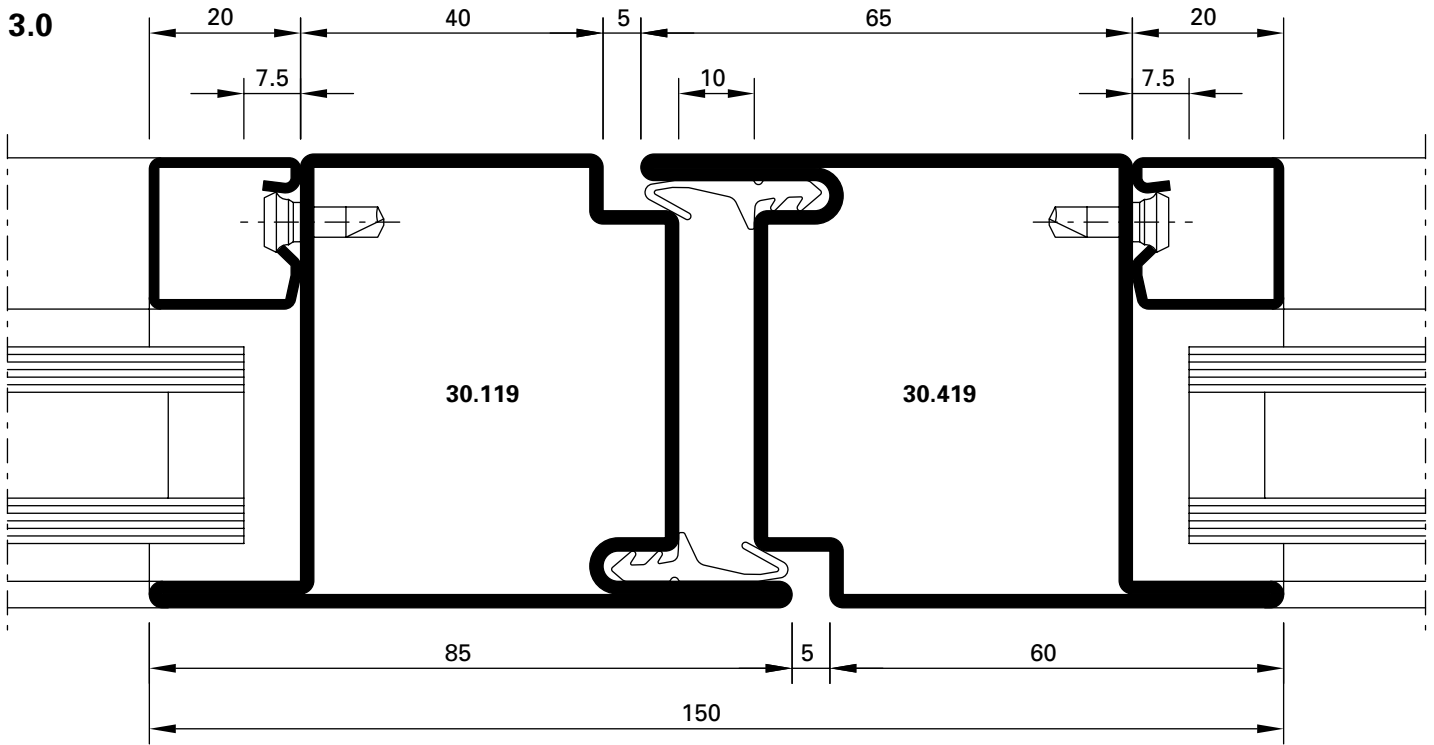

DXF DWG D-250-C-003

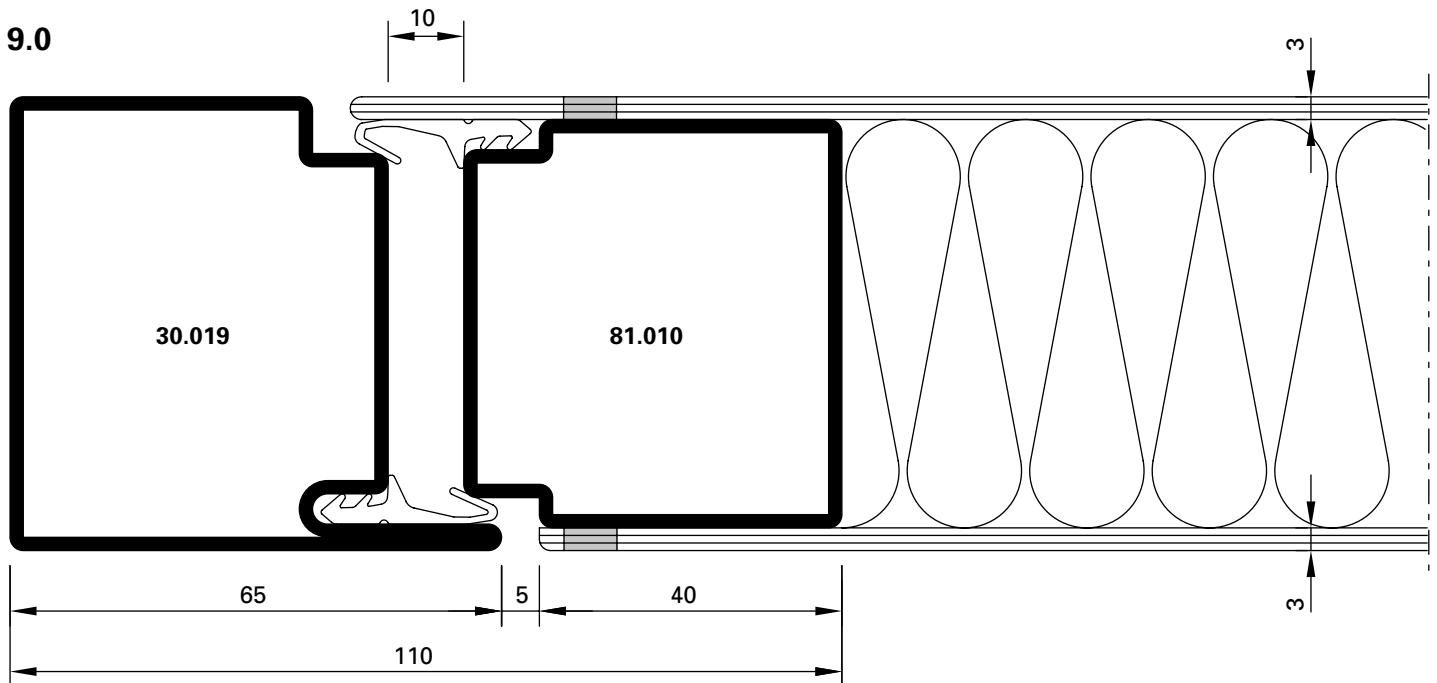

DXF DWG D-250-C-013

4.0

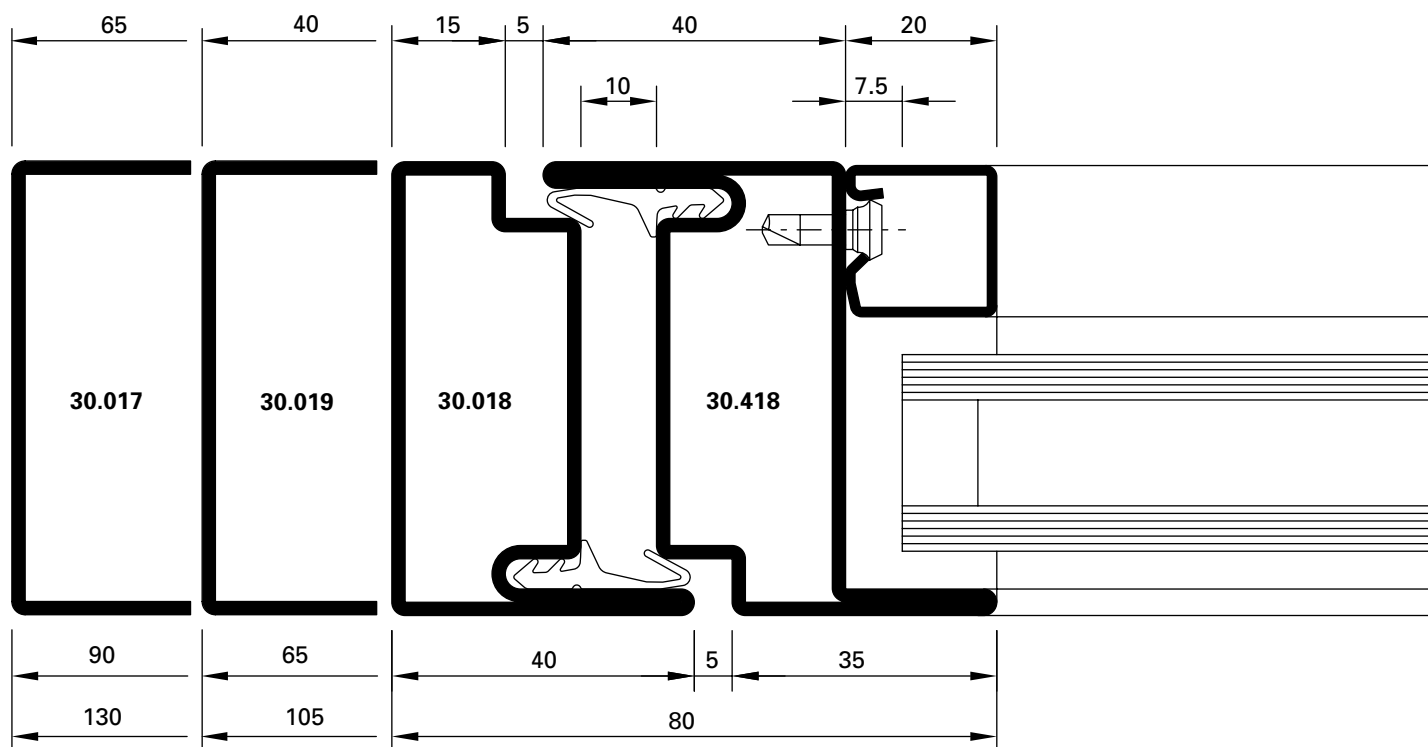

DXF **DWG** D-250-C-010

5.0

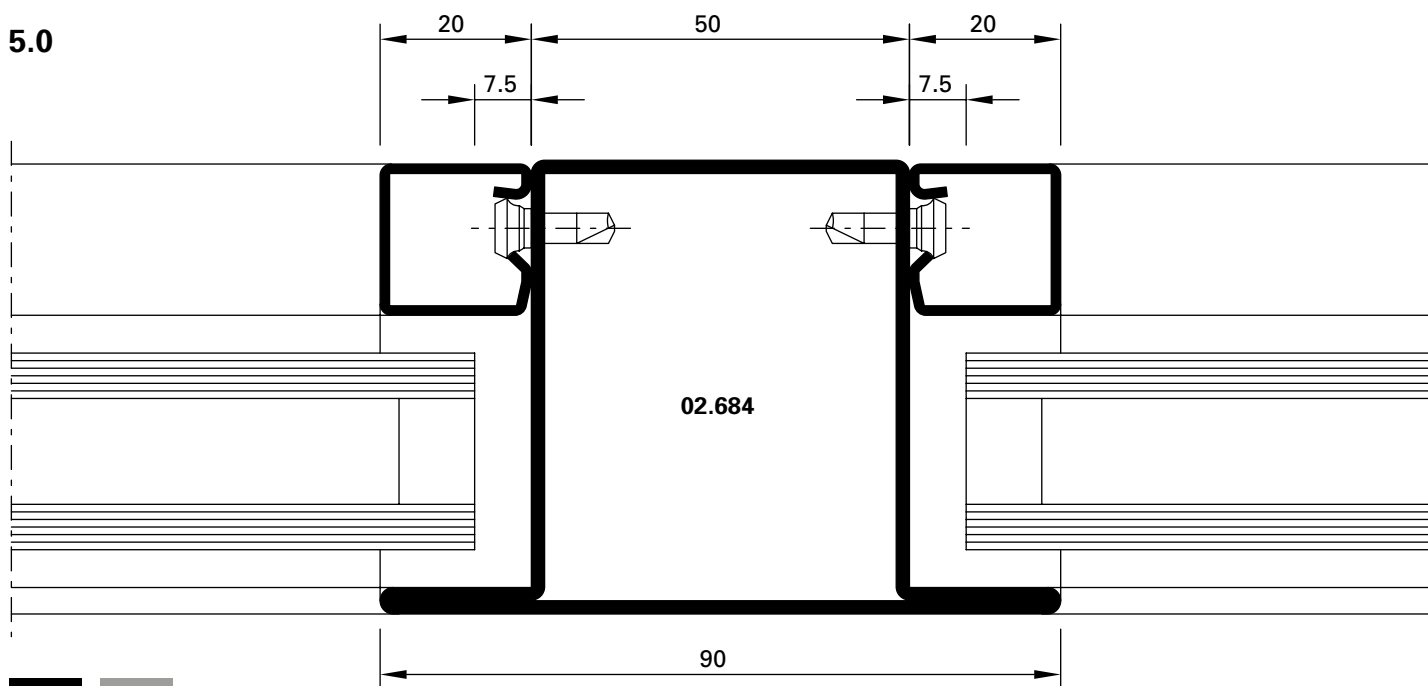

DXF **DWG** D-250-C-012

8.0

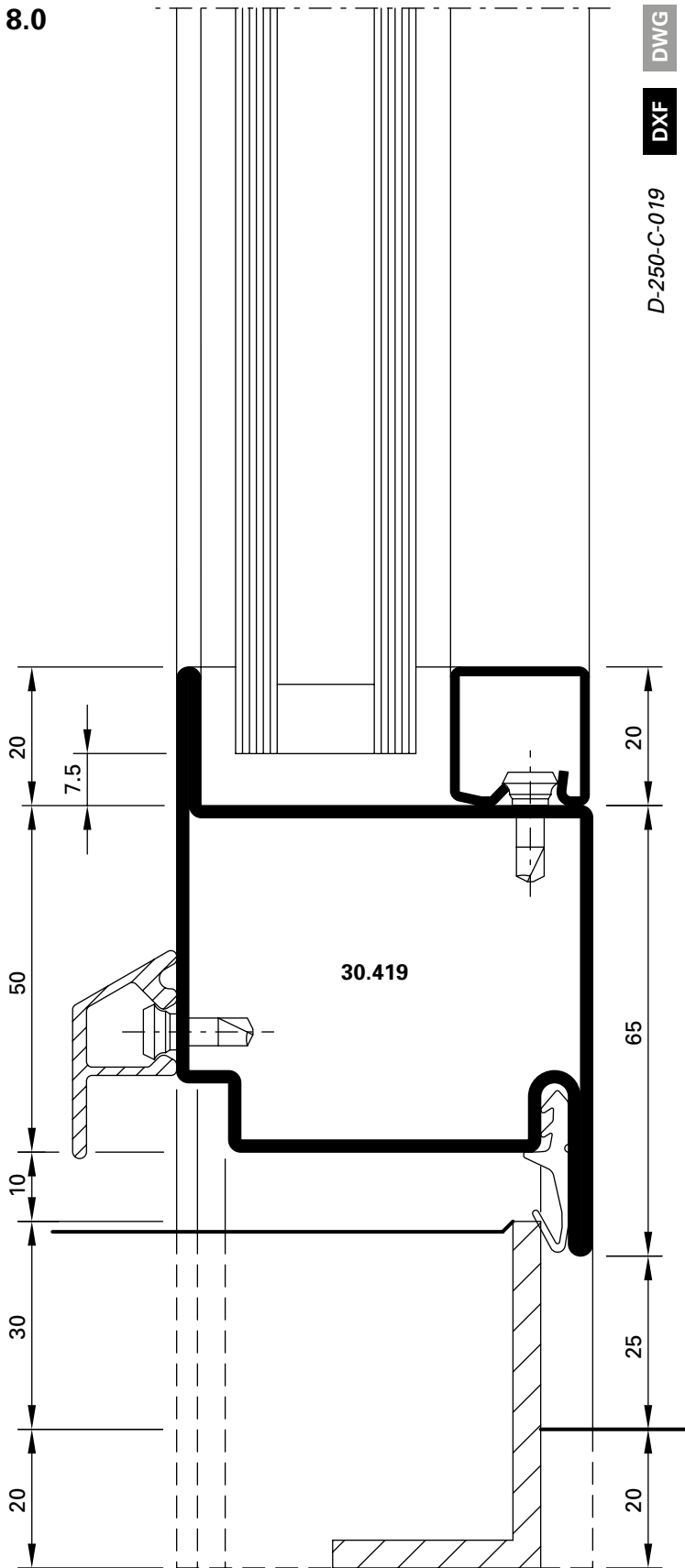

8.1

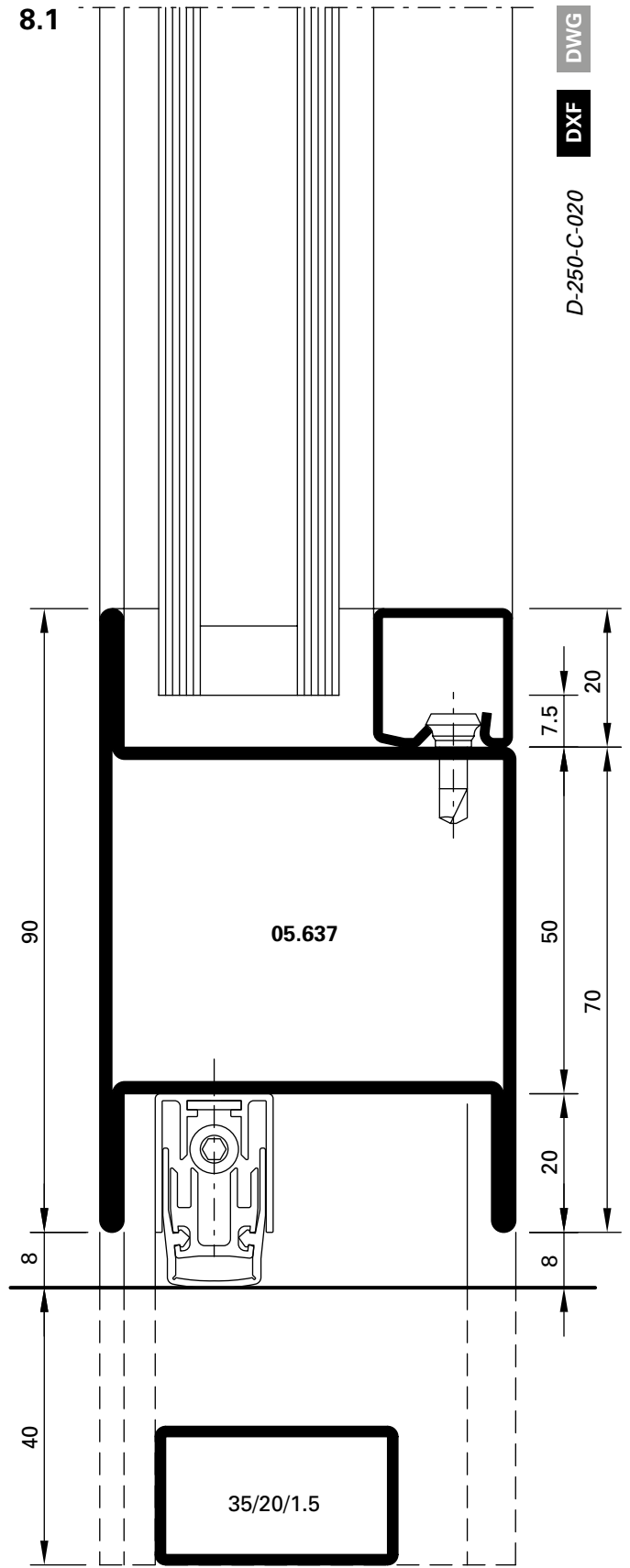

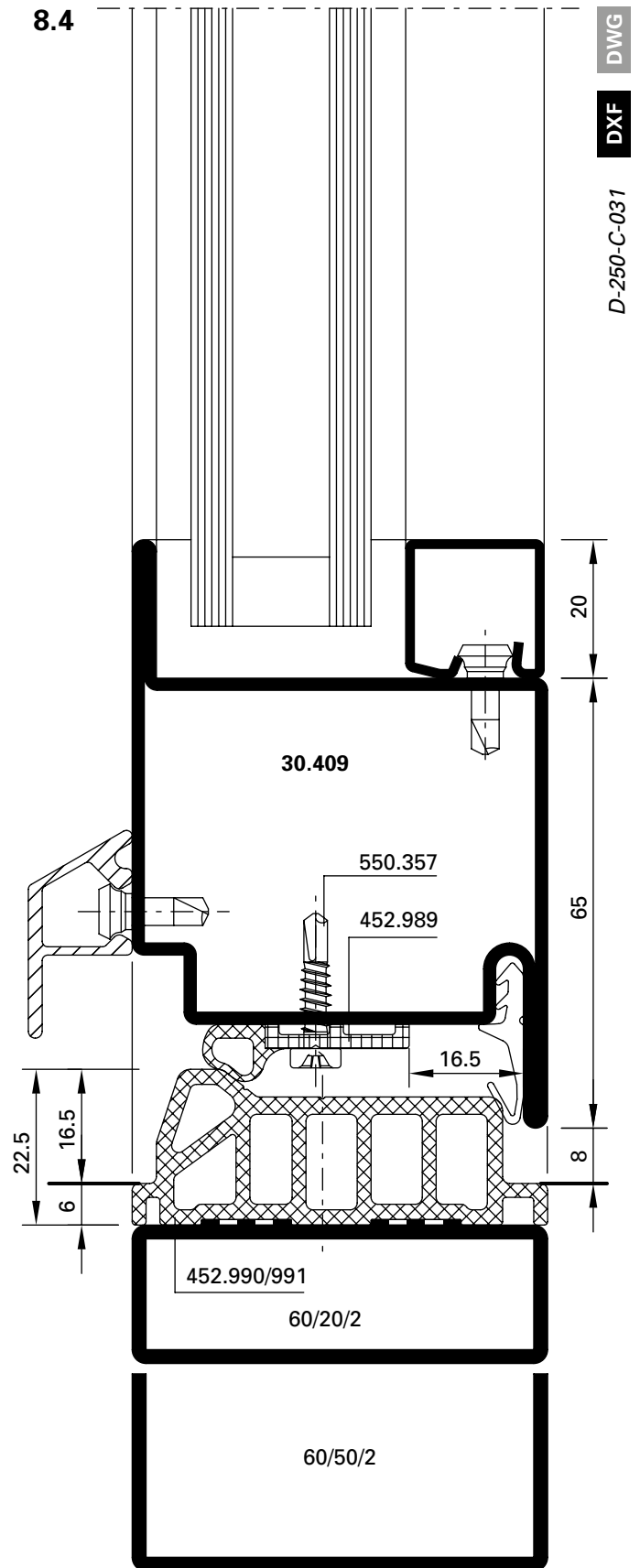
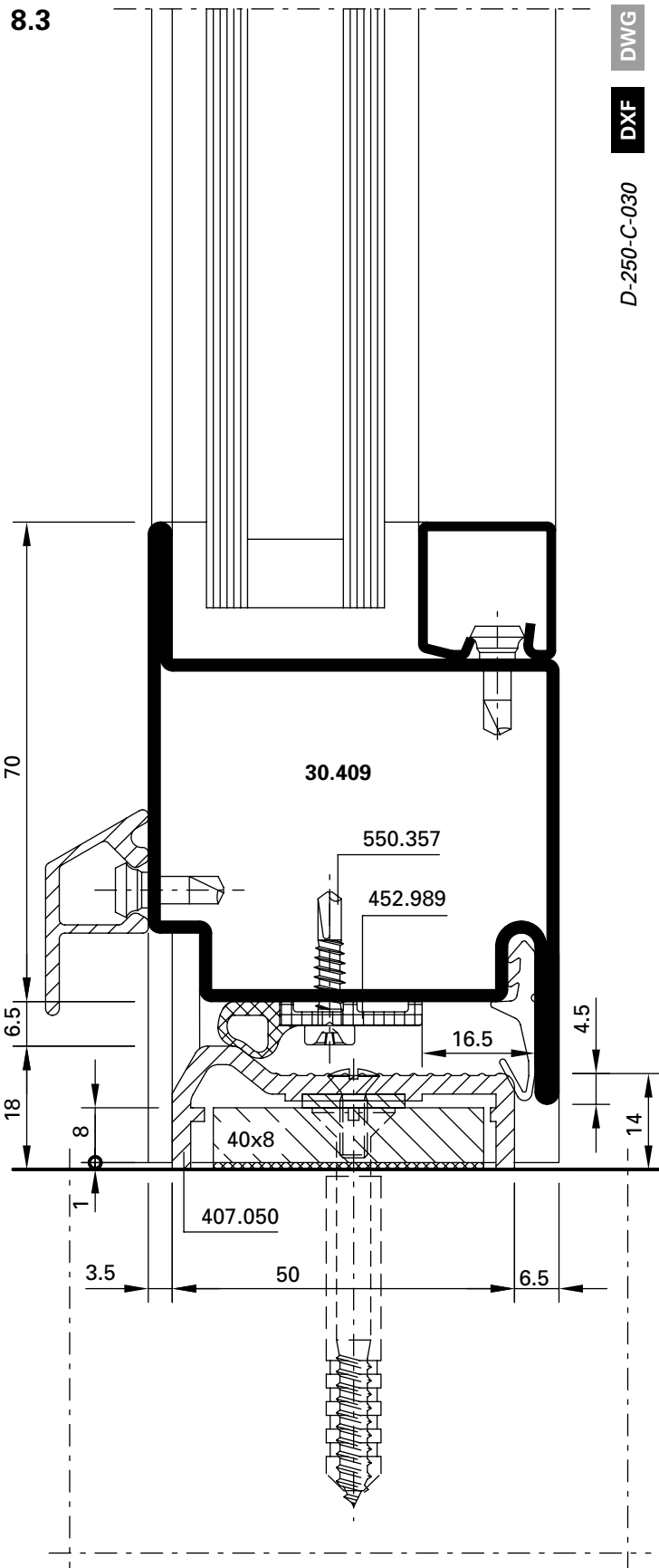

2.1

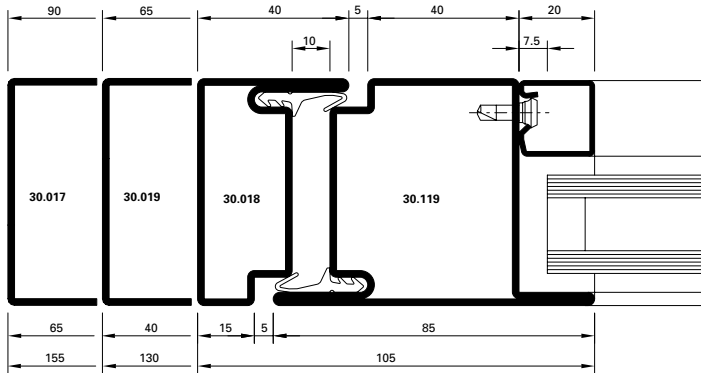

DXF DWG D-250-C-004

4.1

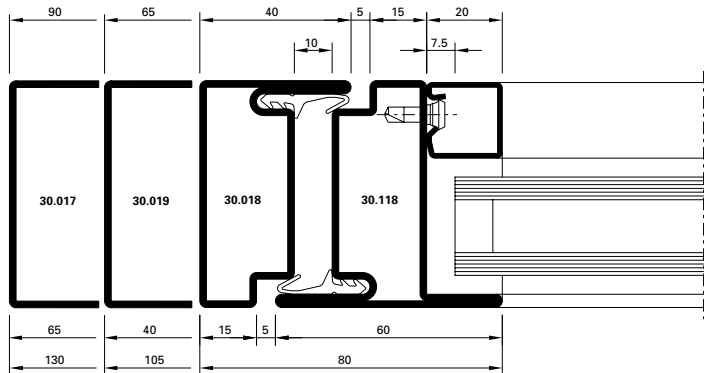

DXF DWG D-250-C-011

2.3

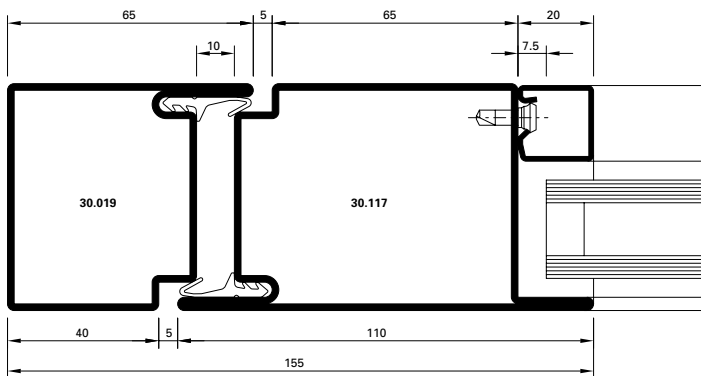

DXF DWG D-250-C-006

3.1

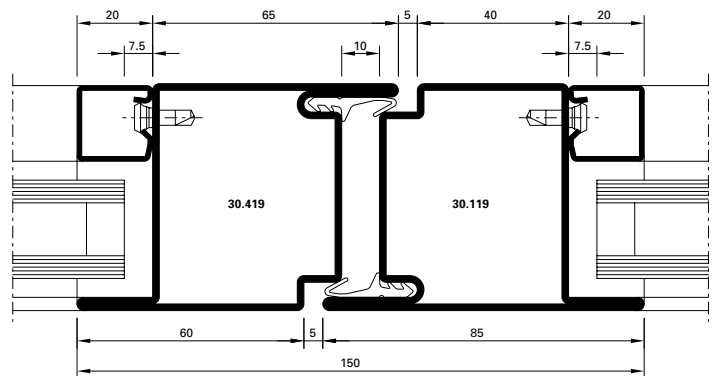

DXF DWG D-250-C-007

3.2

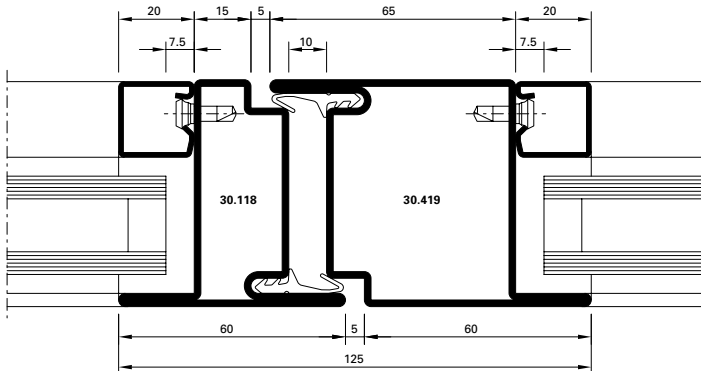

DXF DWG D-250-C-008

3.3

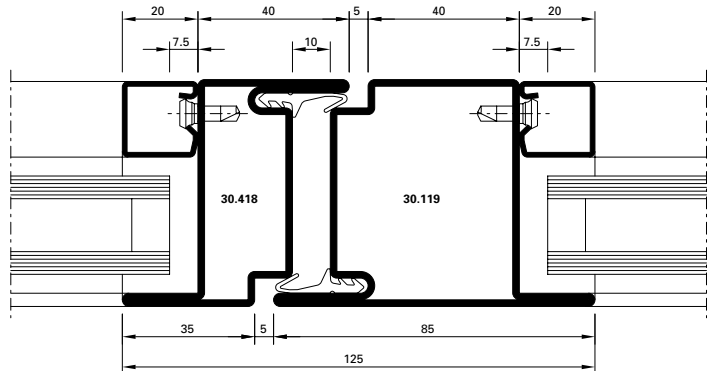

DXF DWG D-250-C-009

9.1

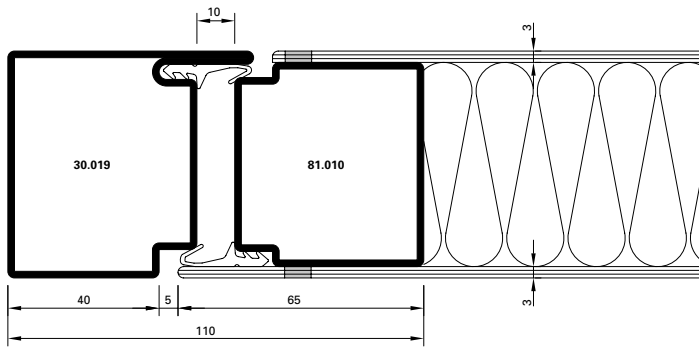

DXF **DWG** *D-250-C-014*

10.0

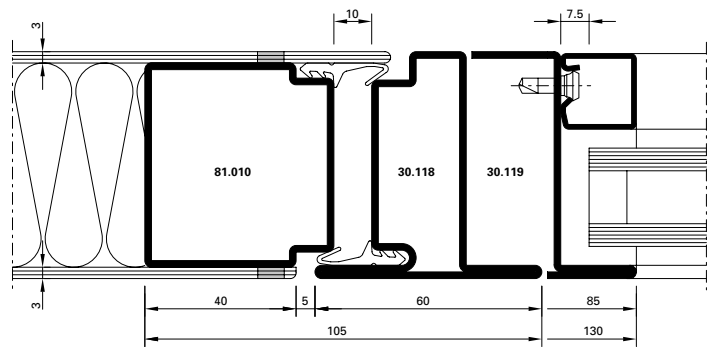

DXF **DWG** *D-250-C-015*

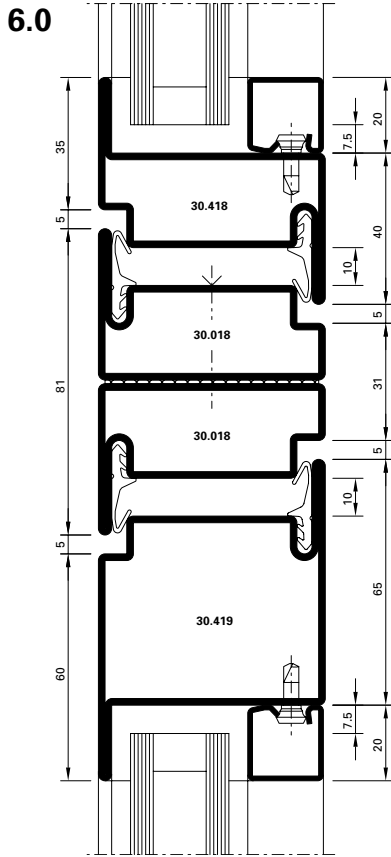

DWG
 DXF
 D-250-C-016

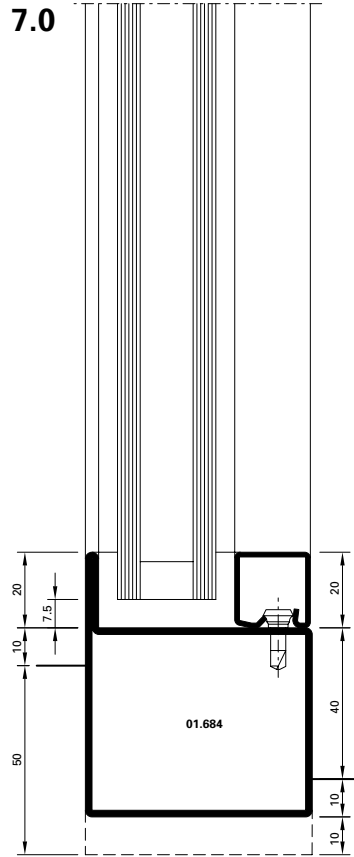

DWG
 DXF
 D-250-C-017

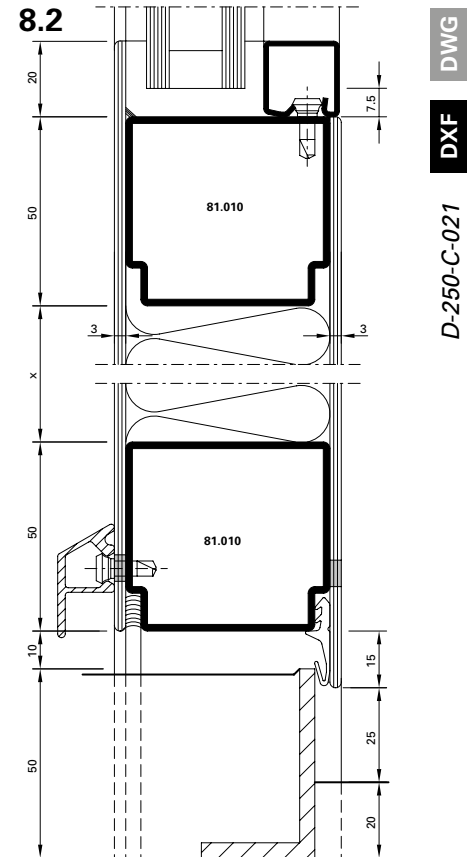

DWG
 DXF
 D-250-C-021

5.1

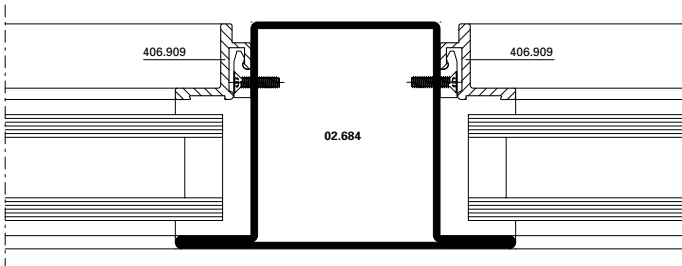

DXF **DWG** *D-250-C-022*

5.2

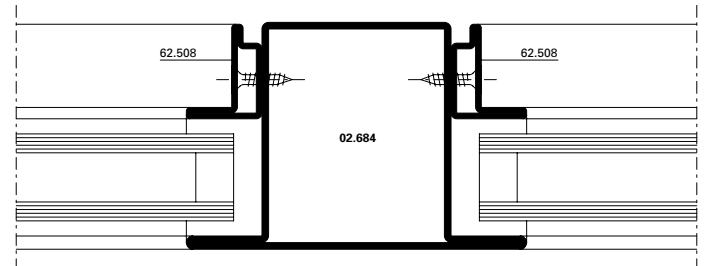

DXF **DWG** *D-250-C-023*

5.3

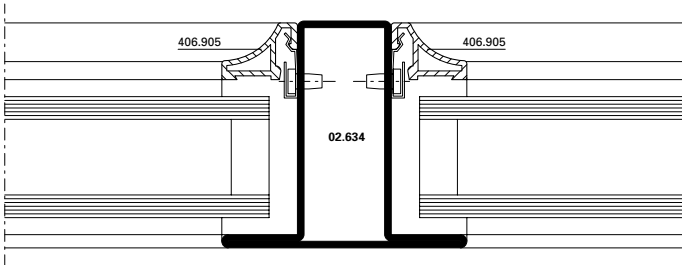

DXF **DWG** *D-250-C-024*

5.4

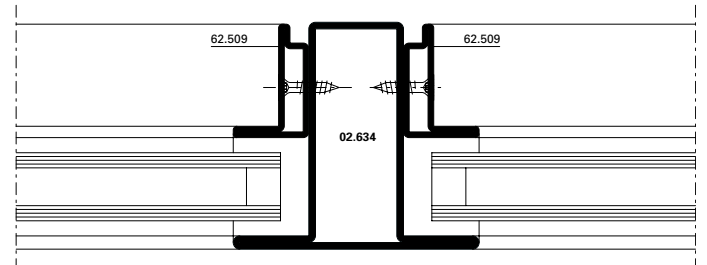

DXF **DWG** *D-250-C-025*

5.5

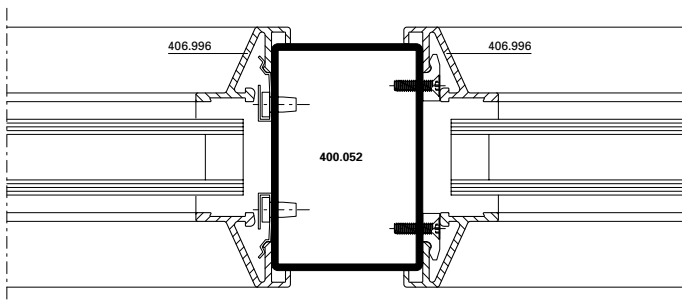

DXF **DWG** *D-250-C-026*

5.6

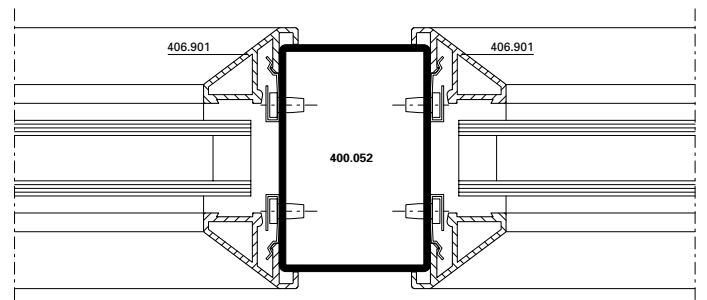

DXF **DWG** *D-250-C-027*

5.6

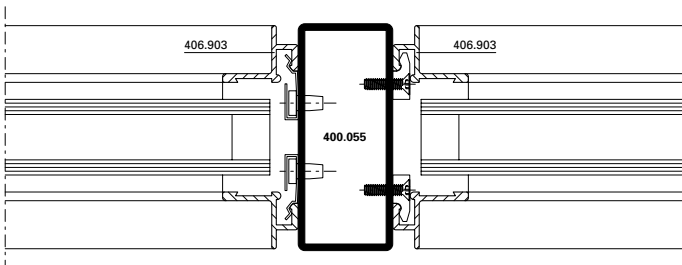

DXF **DWG** *D-250-C-028*

5.8

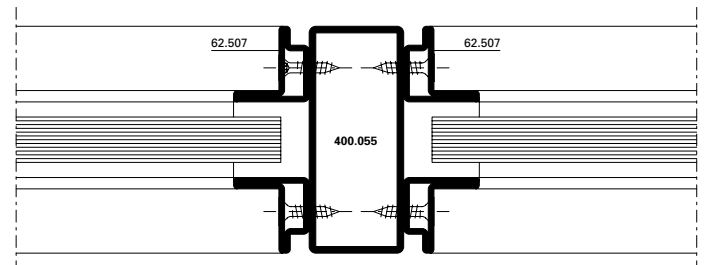

DXF **DWG** *D-250-C-029*

B-B

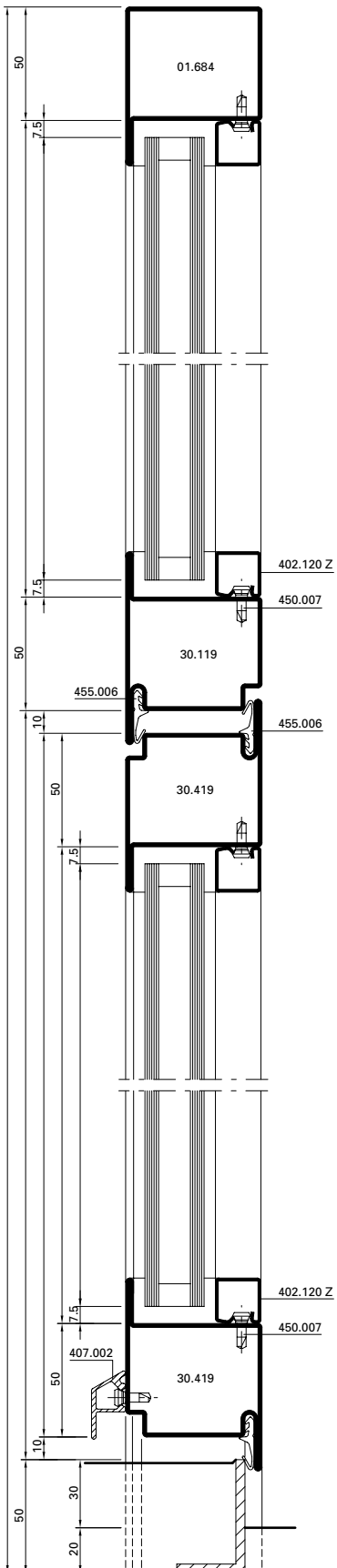

D-D

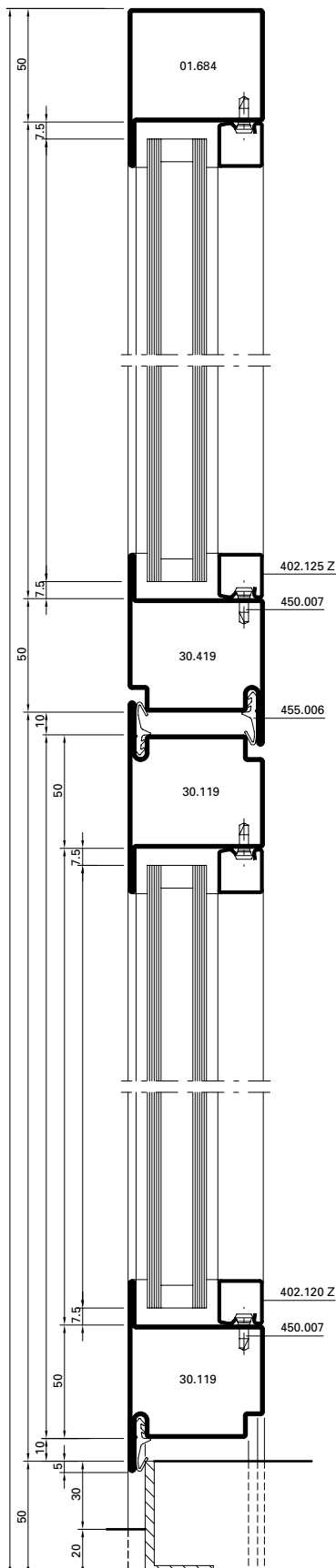

E-E

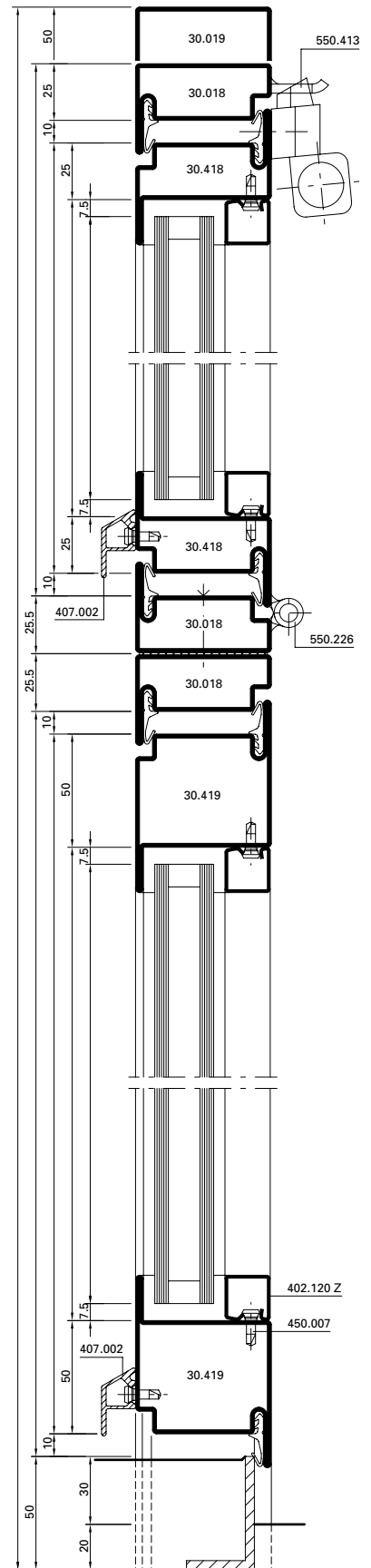

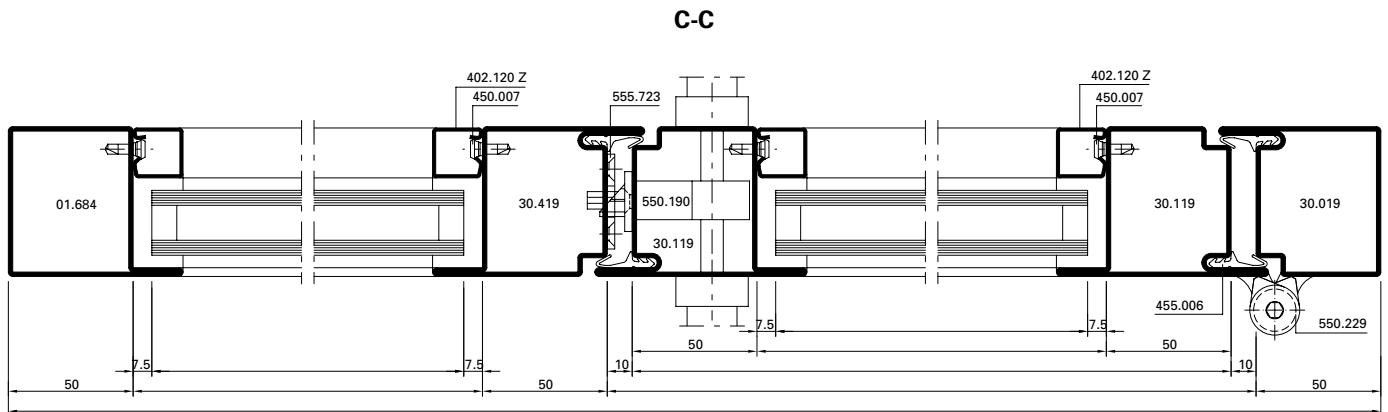
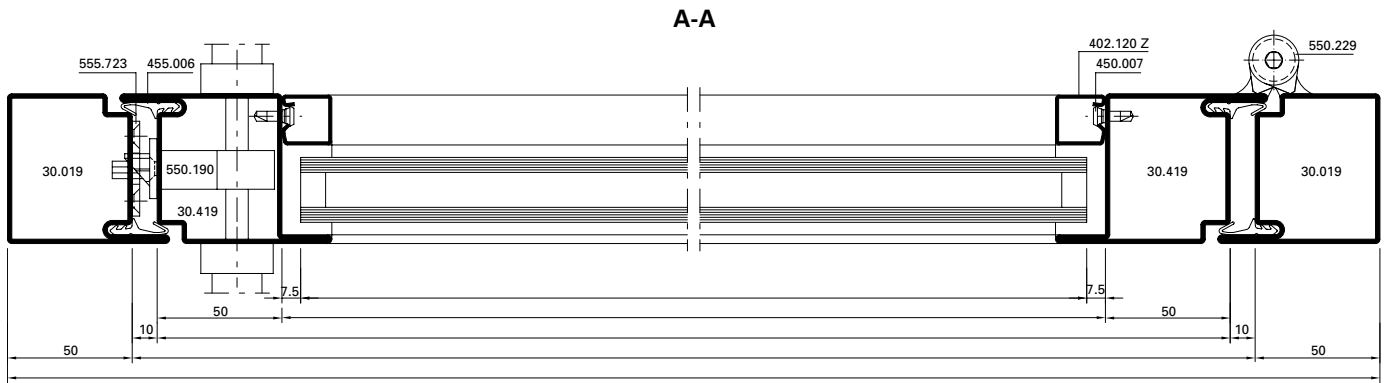

Alternative

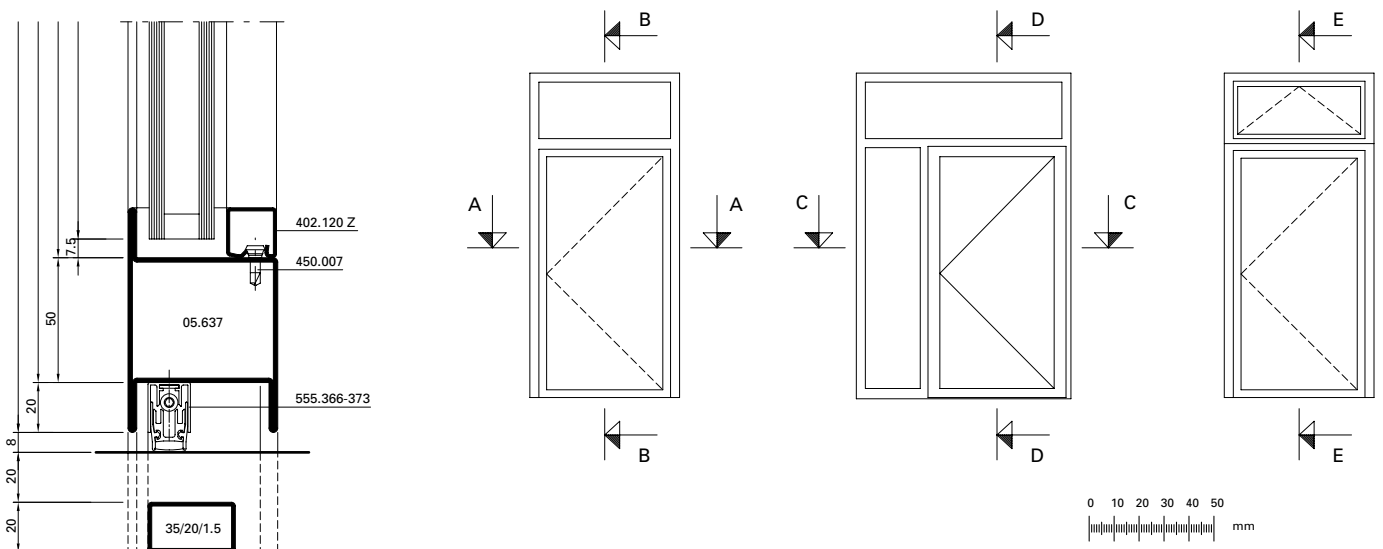

B-B

D-D

E-E

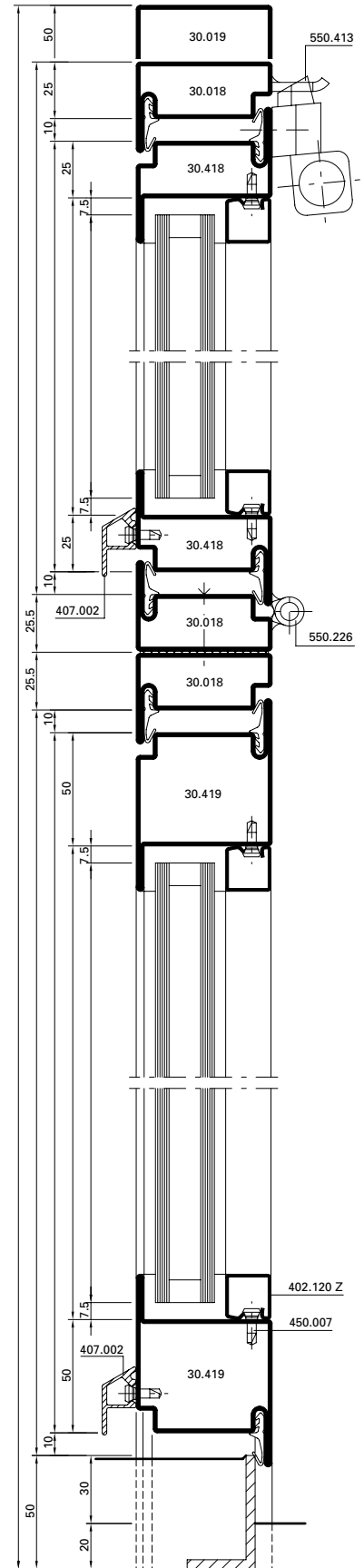
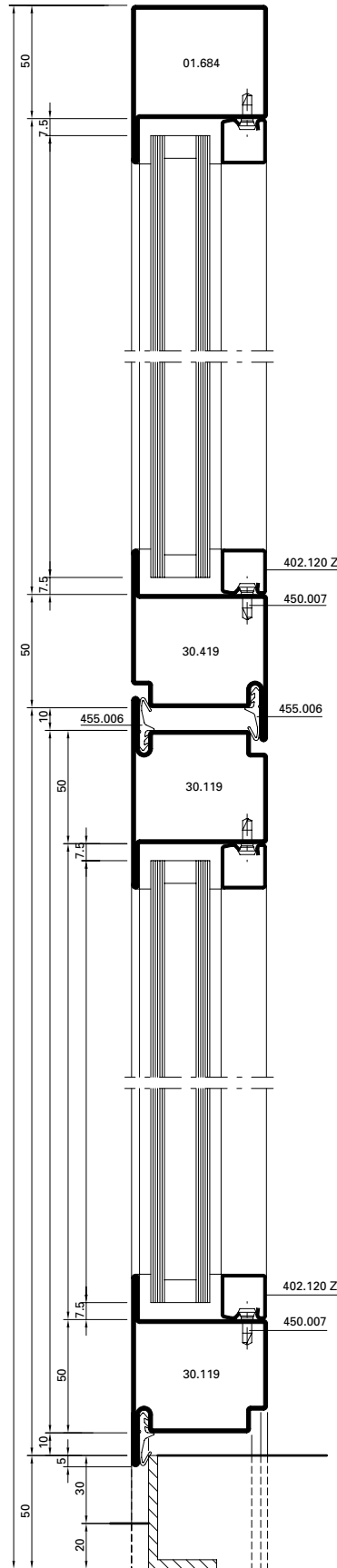
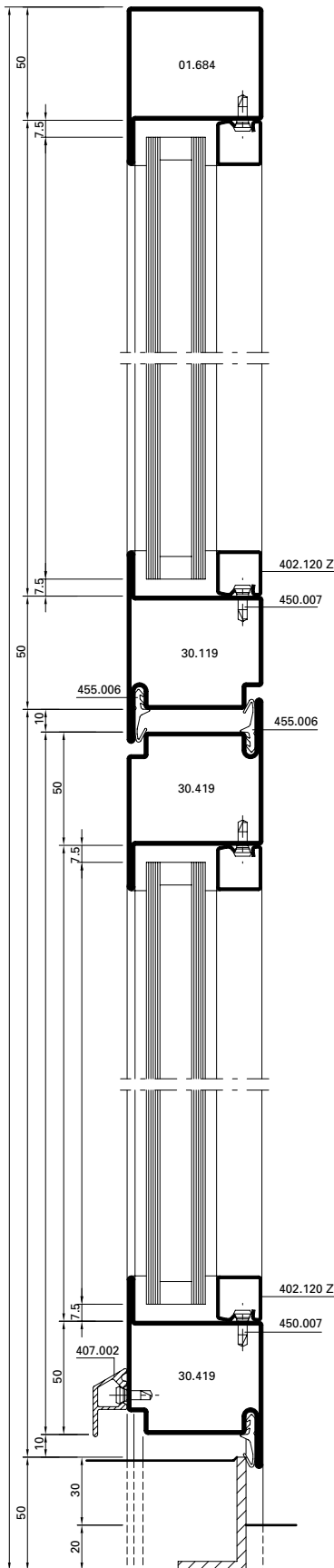

A-A

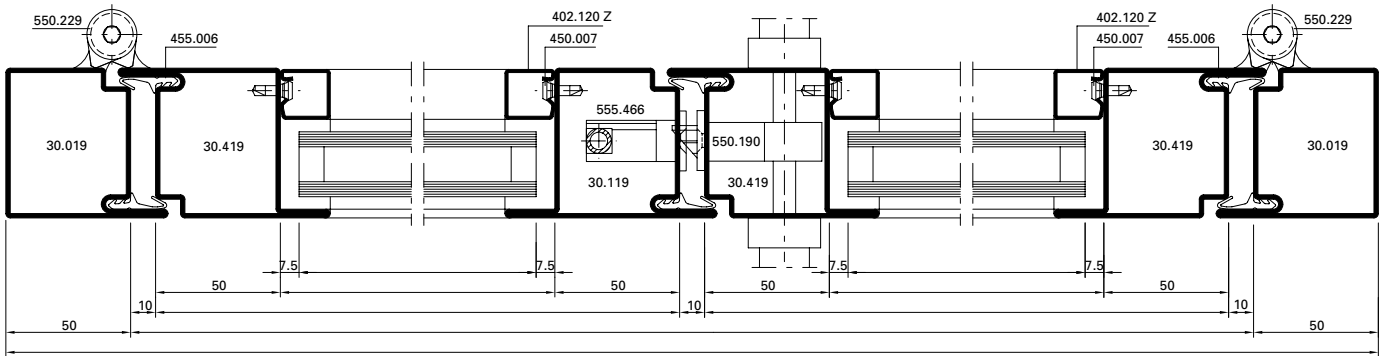

C-C

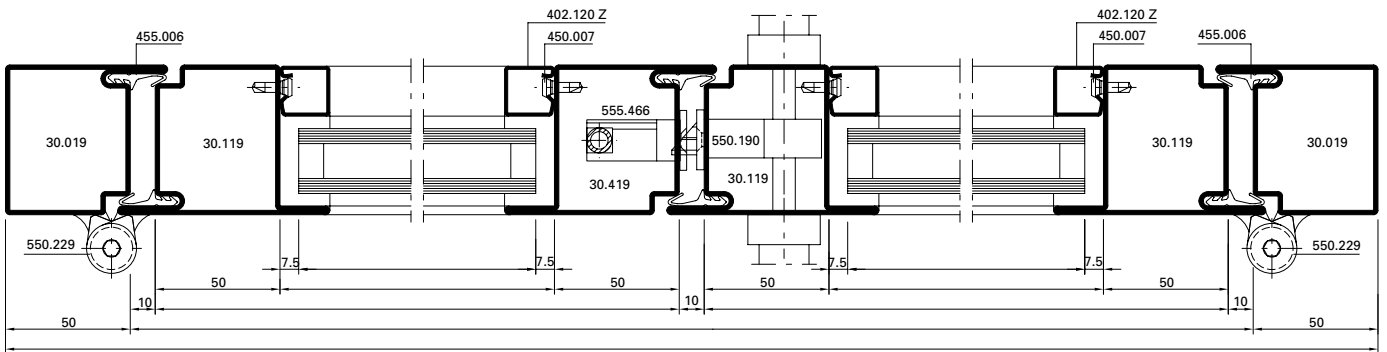

Alternative

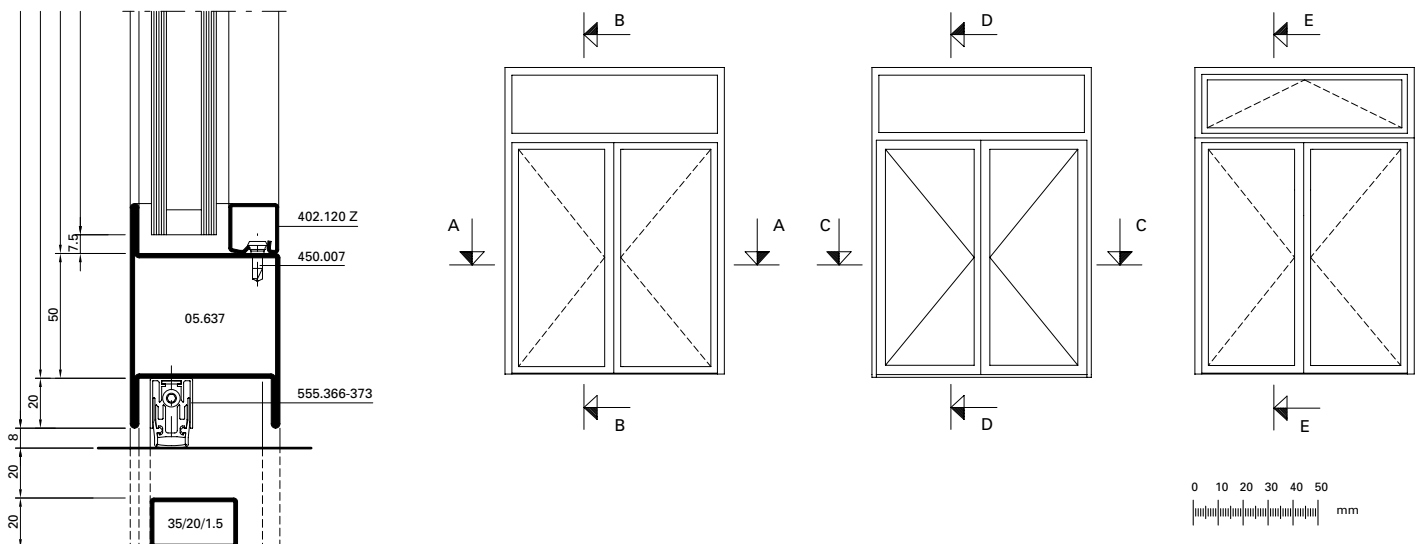

Fingerschutz-Türe

Porte anti-pince doigts

Anti-finger-trap door

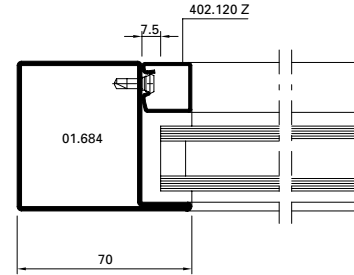
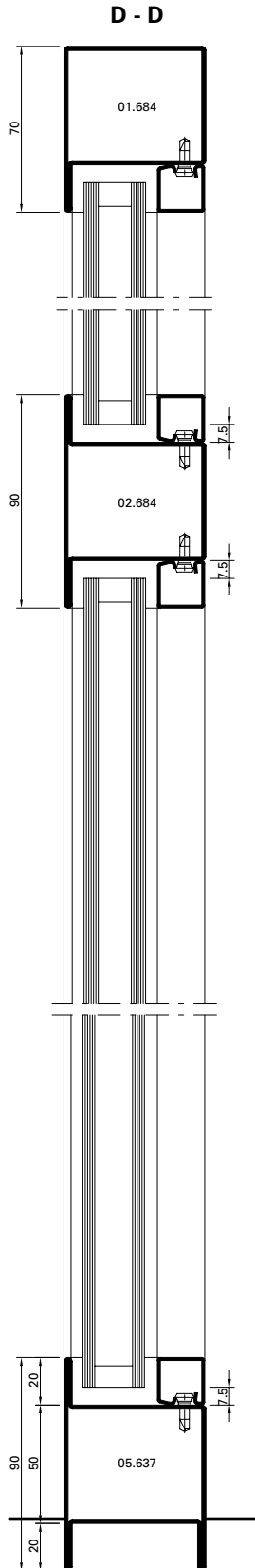
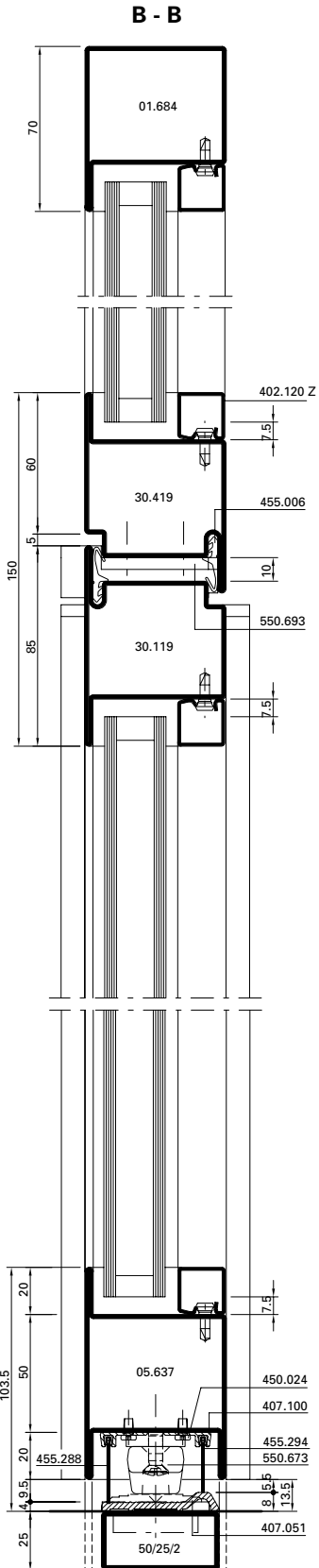

Fingerschutz-Türe

Porte anti-pince doigts

Anti-finger-trap door

C - C

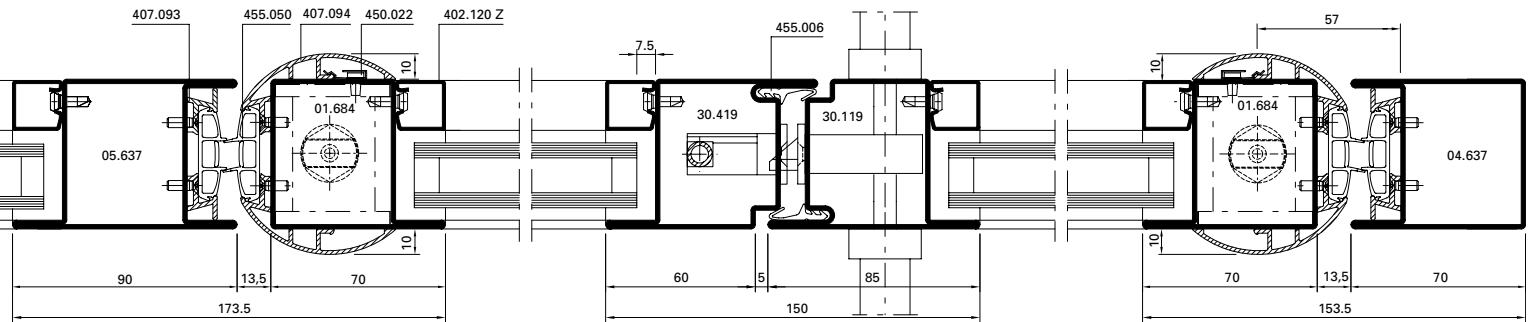

A - A

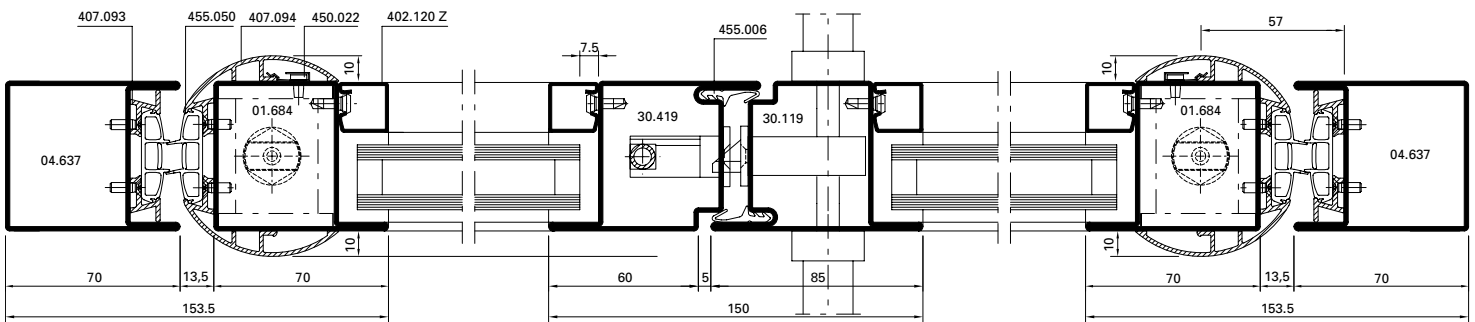

B

D

B

A

A

C

C

B

D

B

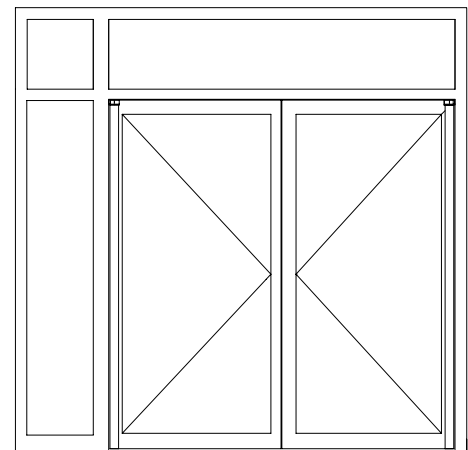
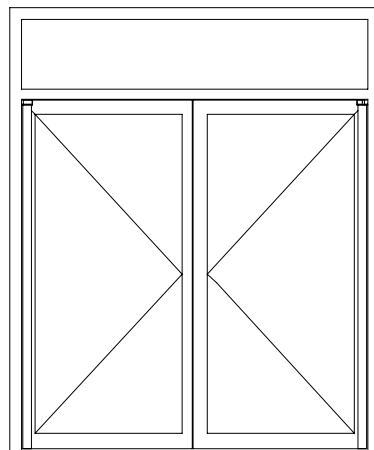

Verlangen Sie bei Bedarf
 die Dokumentation «Jansen-
 Economy 60 Fingerschutztüre»

En cas de besoin, faites la
 demande de la documentation
 «Porte anti-pince-doigts
 Jansen-Economy 60»

If required, request the
 documentation for
 «Jansen-Economy 60
 anti-finger-trap doors»

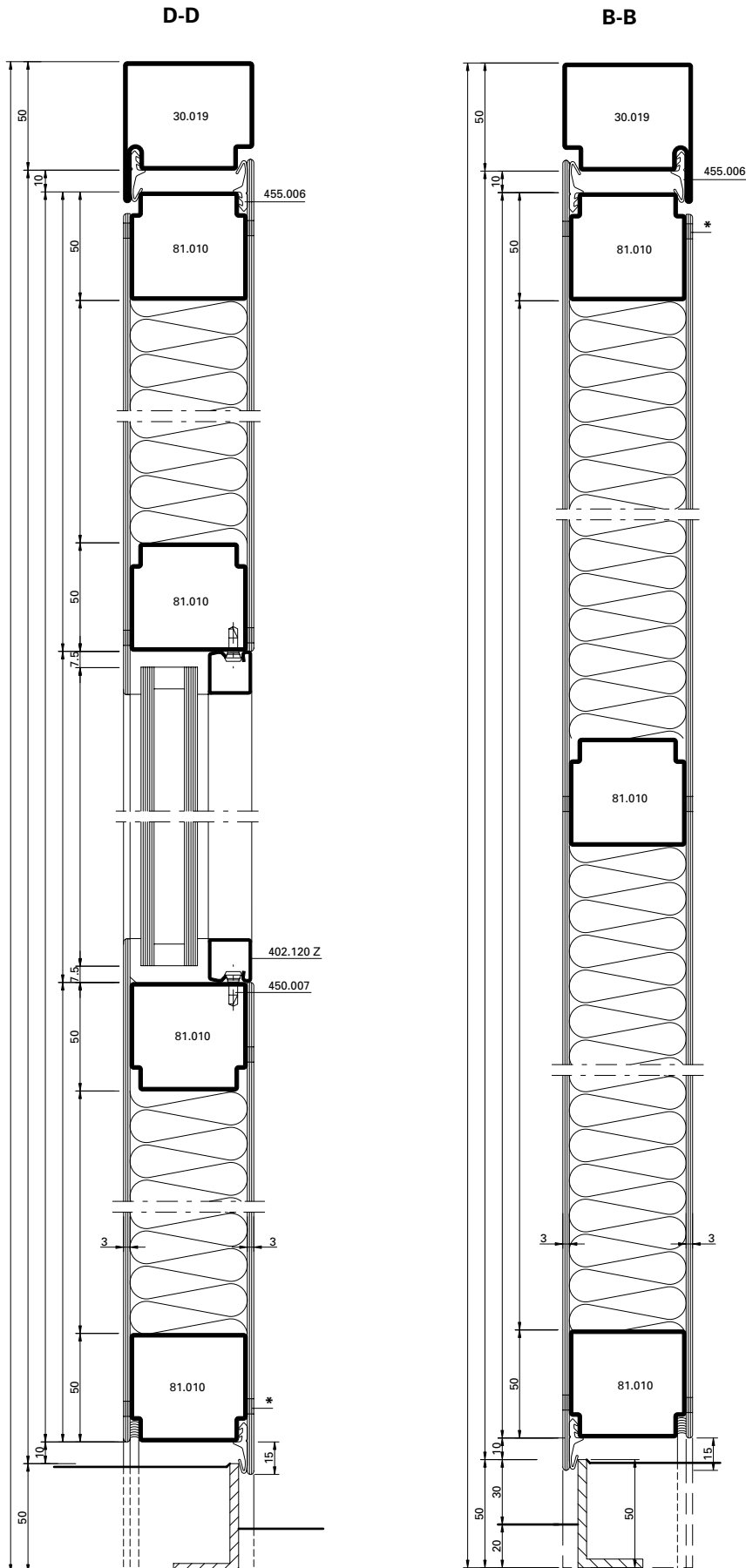

* **Hinweis Oberflächenbehandlung:**
 Wegen der Lochschweißungen empfehlen wir eine Nasslackierung mit vorgängigem Spachteln.

* **Indications sur le traitement de surface:**
 En raison des soudages en trou, nous recommandons un laquage avec vernis liquide précédé d'un rebouchage.

* **Surface treatment note:**
 We recommend wet lacquering preceded by priming, due to the plug welds.

Aufgrund möglicher Deformationen von verblechten Türen in exponierten Lagen mit Sonneneinstrahlung sollte diese Anwendung nicht eingesetzt werden, ansonsten ist eine Beschattung vorzusehen.

Au vu de déformations possibles, ne pas exposer les portes tôles au rayonnement direct du soleil (effet bimétal). Si possible prévoir une protection solaire.

Due to potential deformations of sheet metal clad doors in exposed locations with sunlight this application should not be used otherwise a shading must be provided.

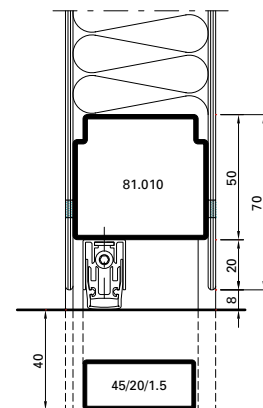

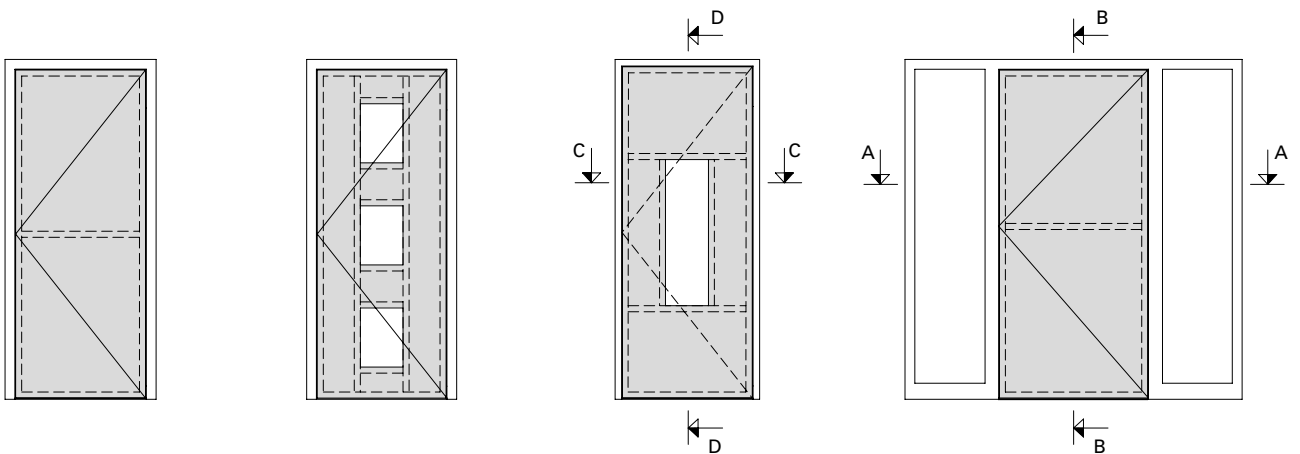
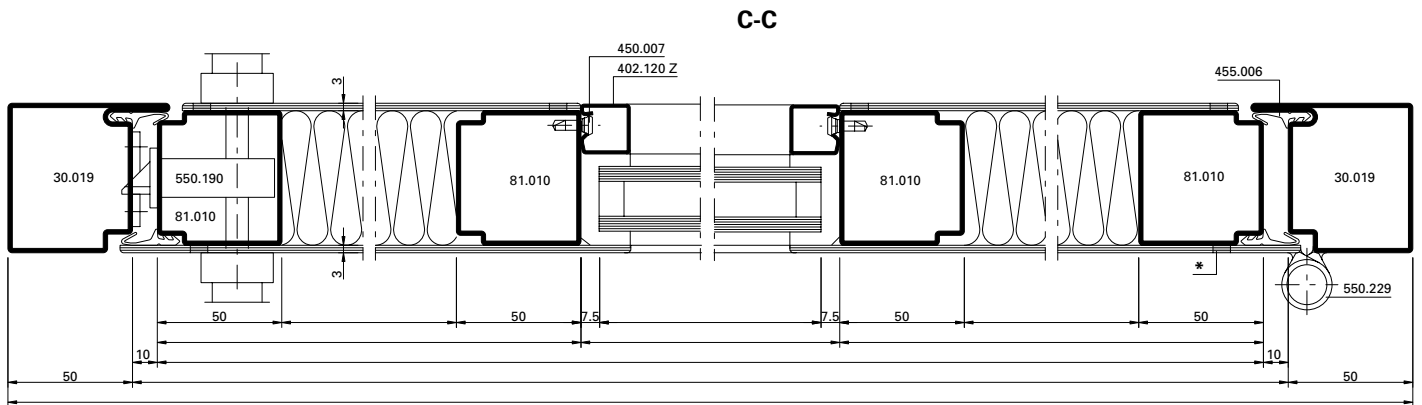
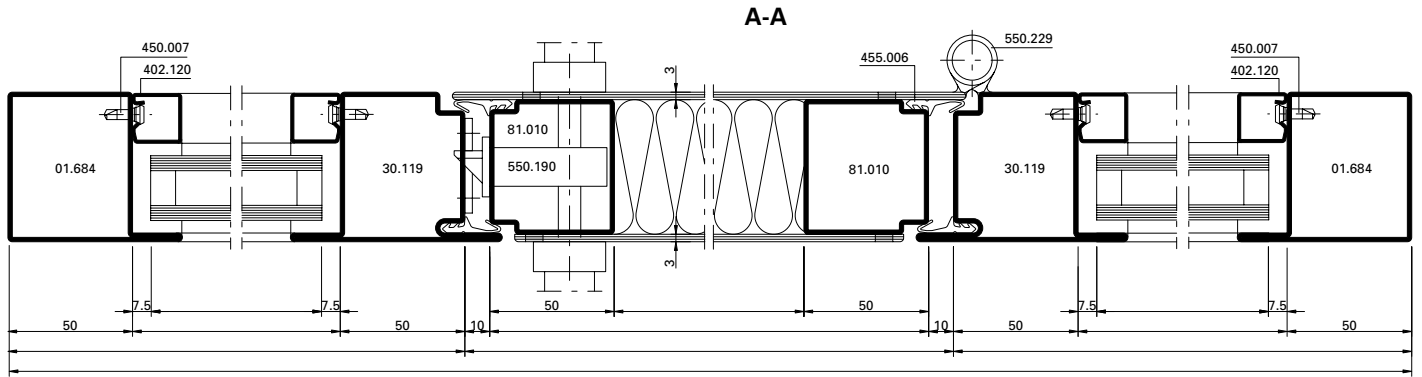

Türe durchschusshemmend FB 4 S/NS

Porte résistance aux balles FB 4 S/NS

Door bullet proofing FB 4 S/NS

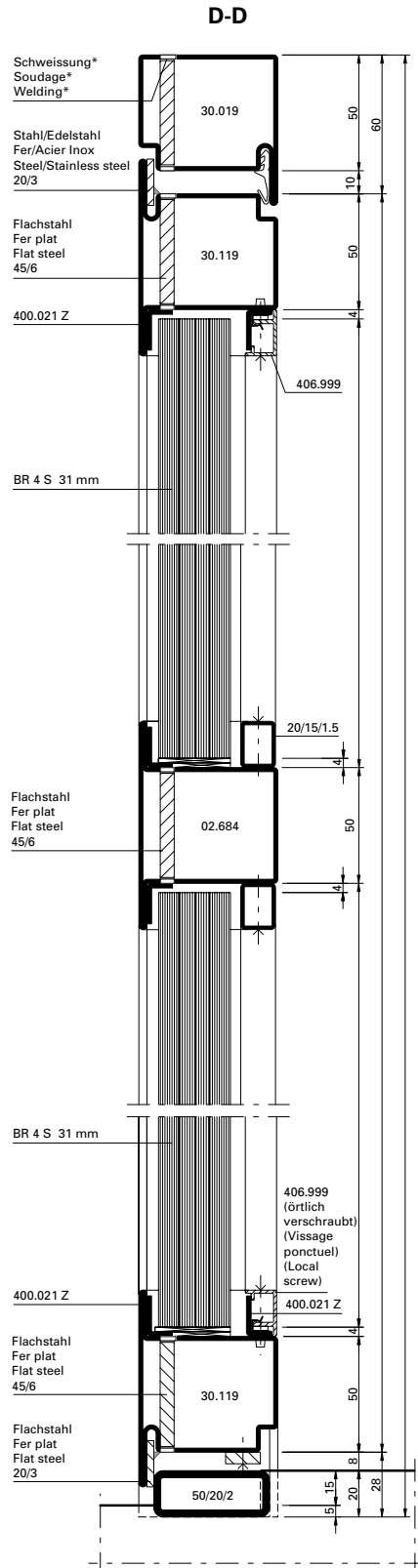
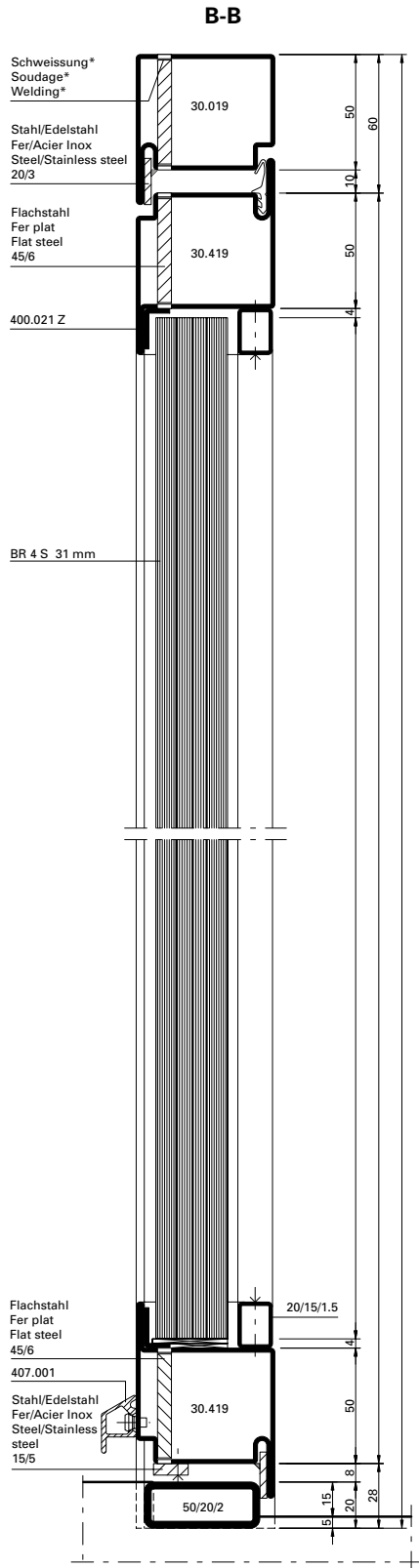

Detail E

Türe nach innen öffnend
 Porte ouvrant vers l'intérieur
 Door inward opening

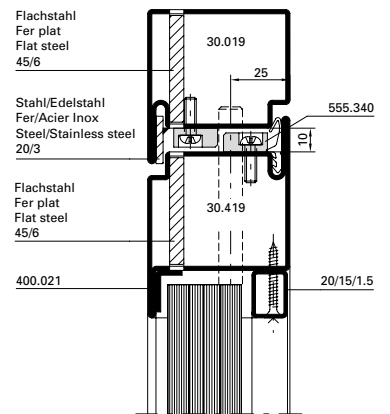

Detail E

Türe nach aussen öffnend
 Porte ouvrant vers l'extérieur
 Door outward opening

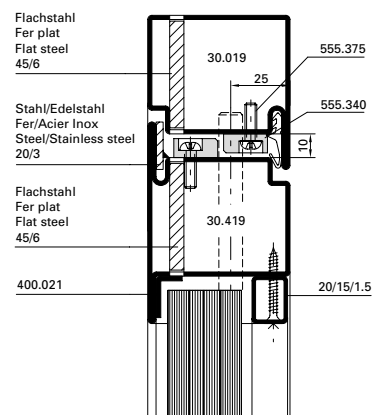

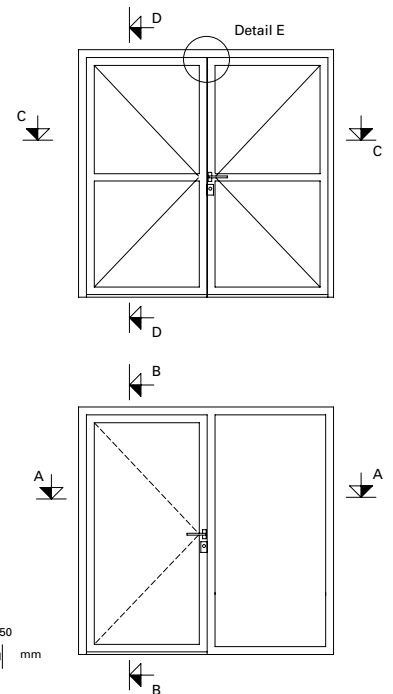
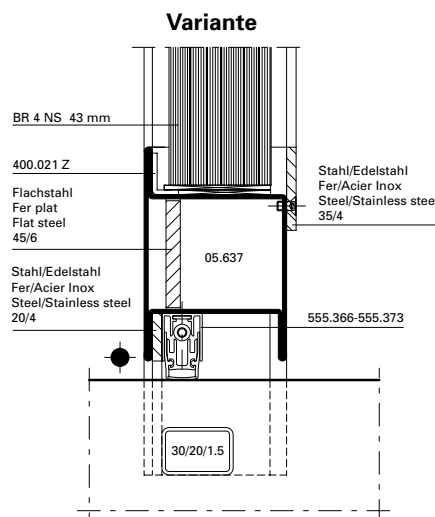
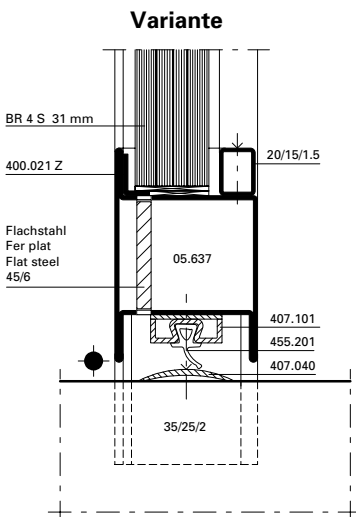
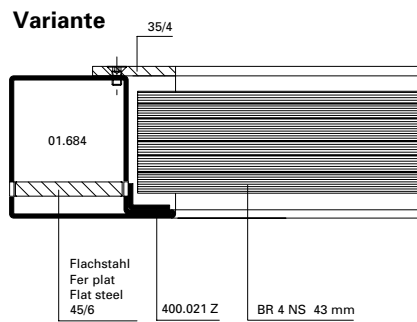
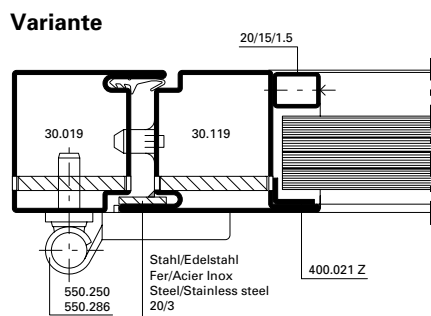
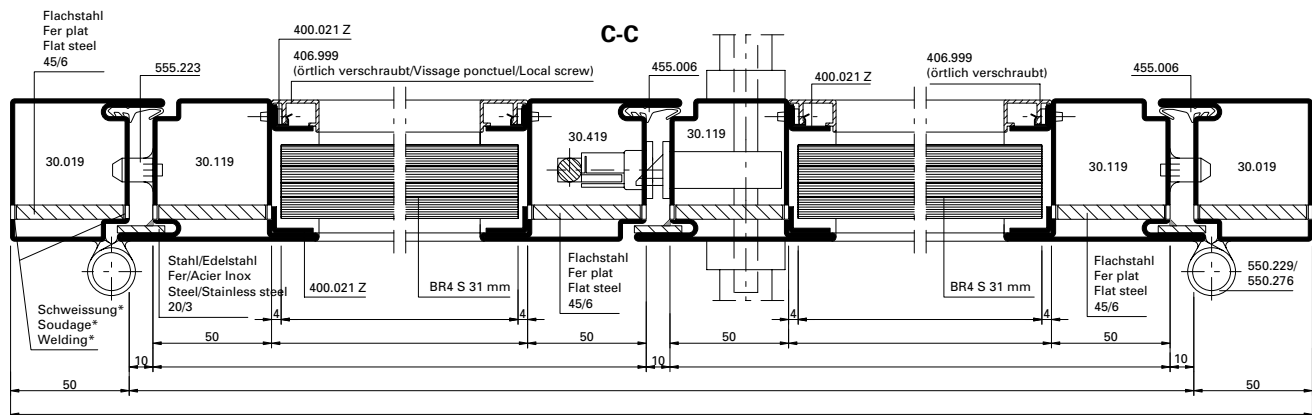
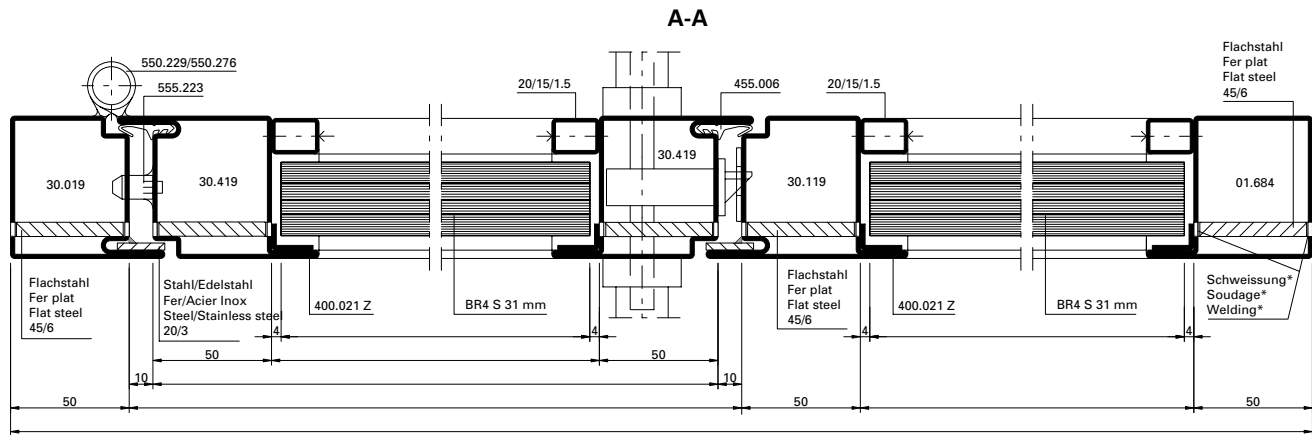

* Abstand Schweisspunkte ca. 300 mm
 * Intervalle entre points de soudage env. 300 mm
 * Distance of welding points approx. 300 mm

● Hinweis: Hier keine Durchschusshemmung
 Remarque: Ici pas de protection à l'effraction
 Note: Here no slug stoppage

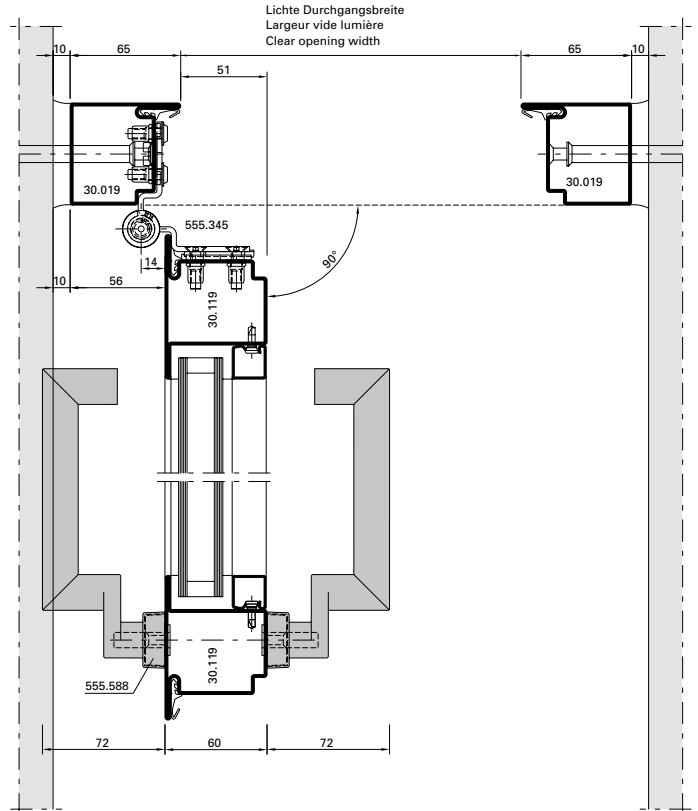
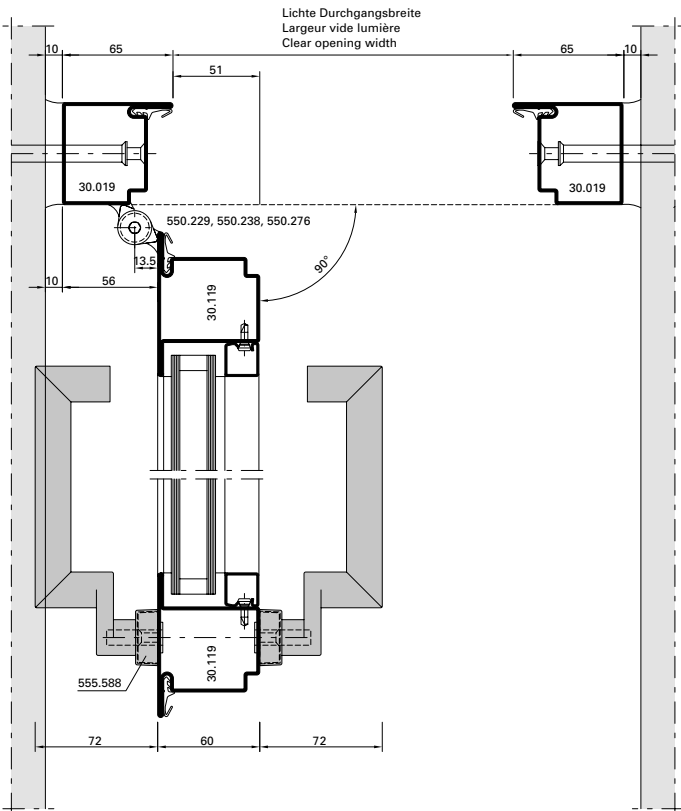

DXF **DWG** *D-250-E-016*

DXF **DWG** *D-250-E-018*

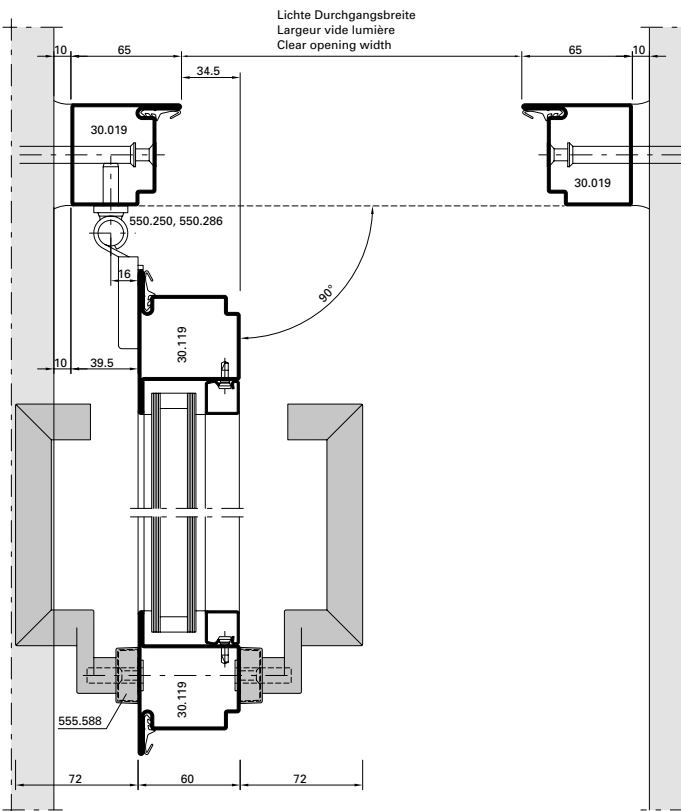

DXF **DWG** *D-250-E-020*

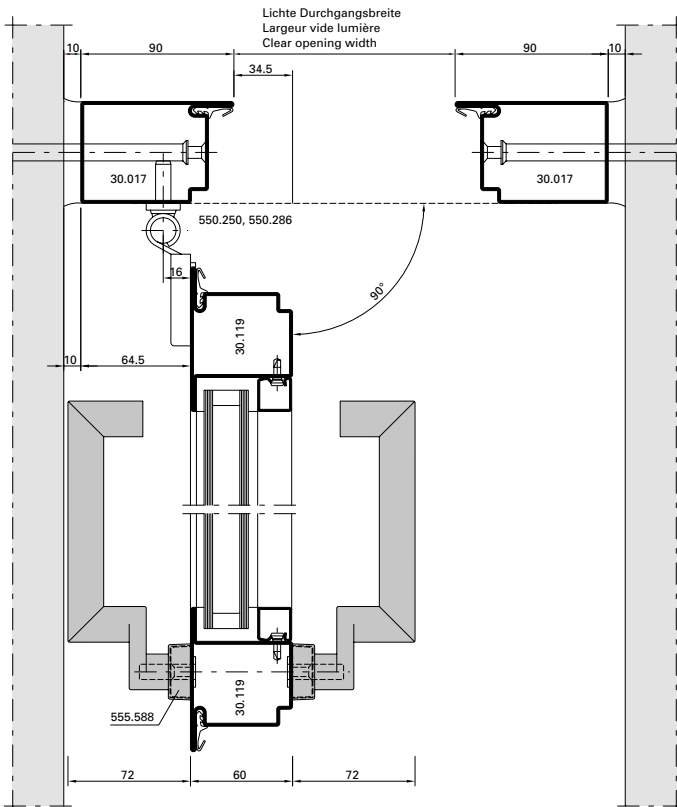

DXF **DWG** *D-250-E-021*

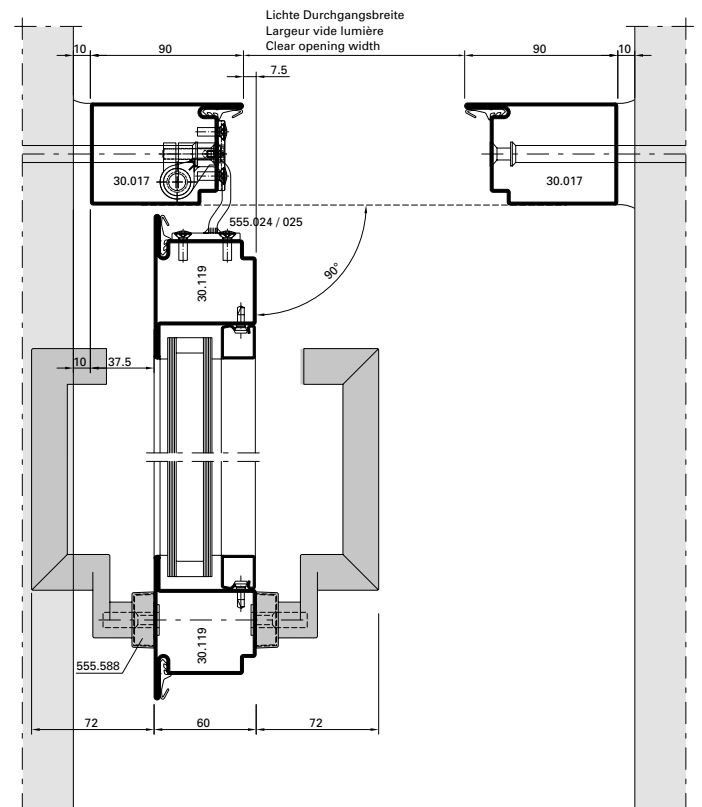

DXF **DWG** *D-250-E-025*

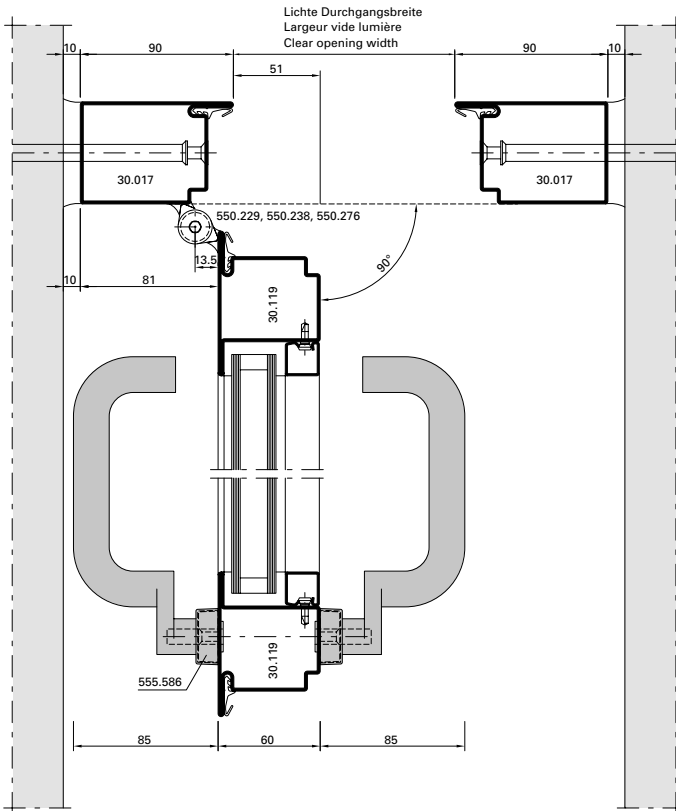

DXF **DWG** *D-250-E-017*

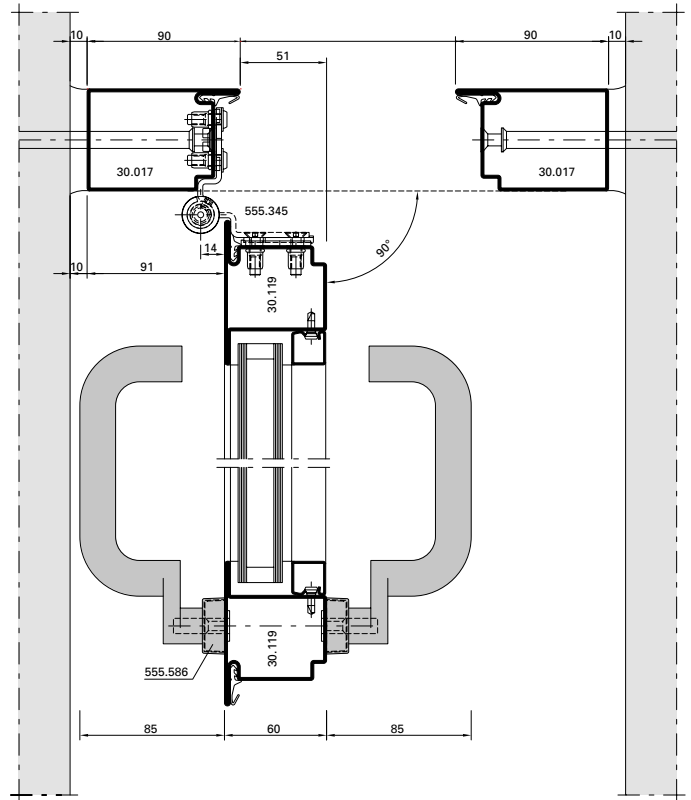

DXF **DWG** *D-250-E-019*

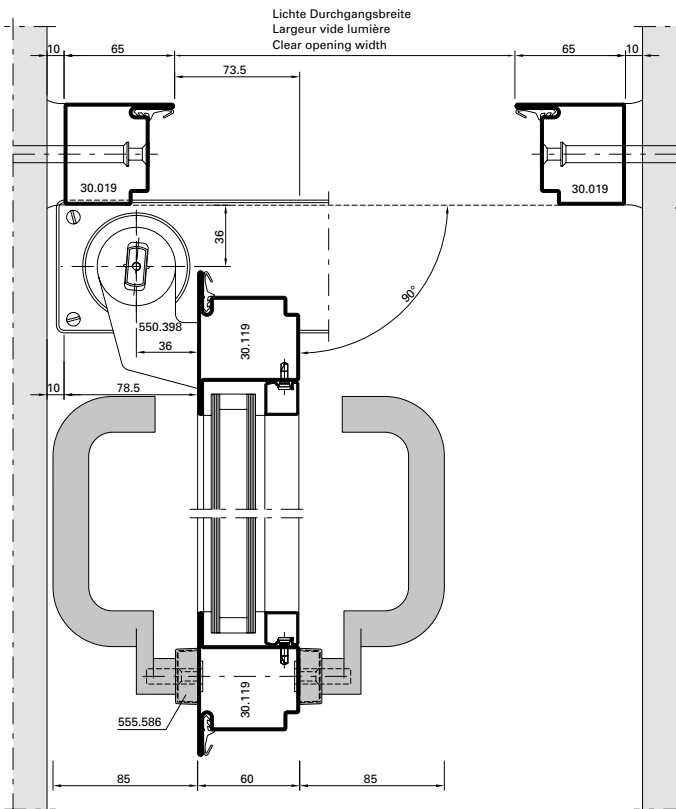

DXF **DWG** *D-250-E-022*

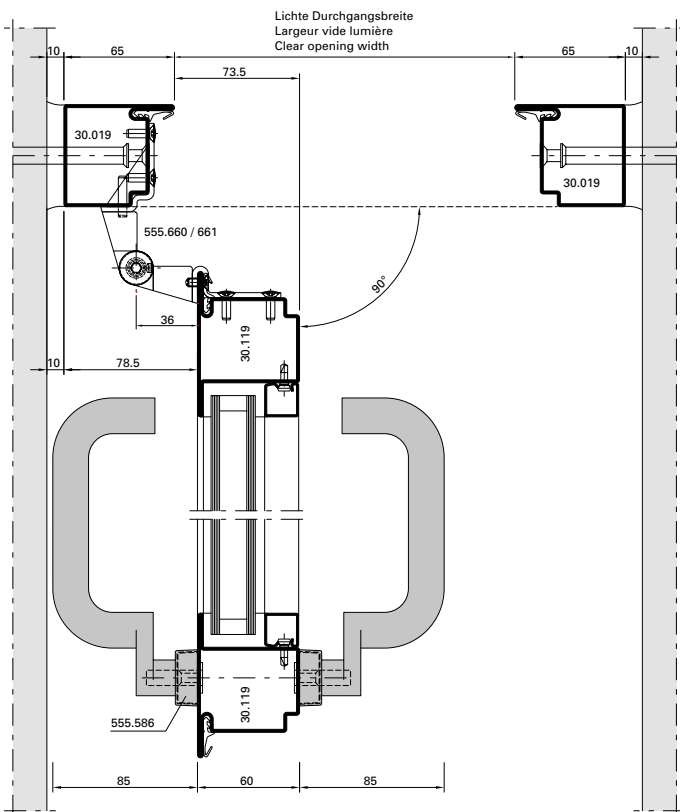

DXF **DWG** *D-250-E-023*

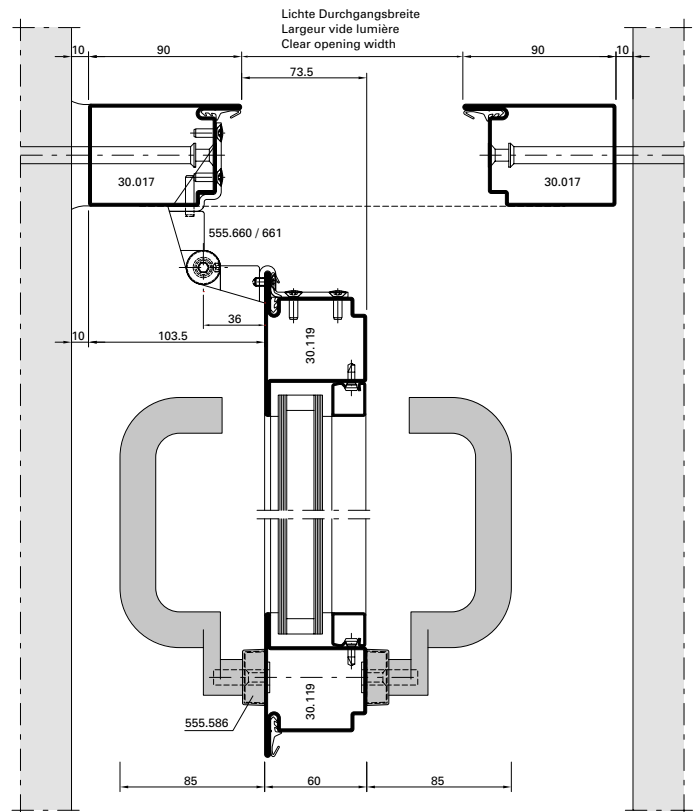

DXF **DWG** *D-250-E-024*

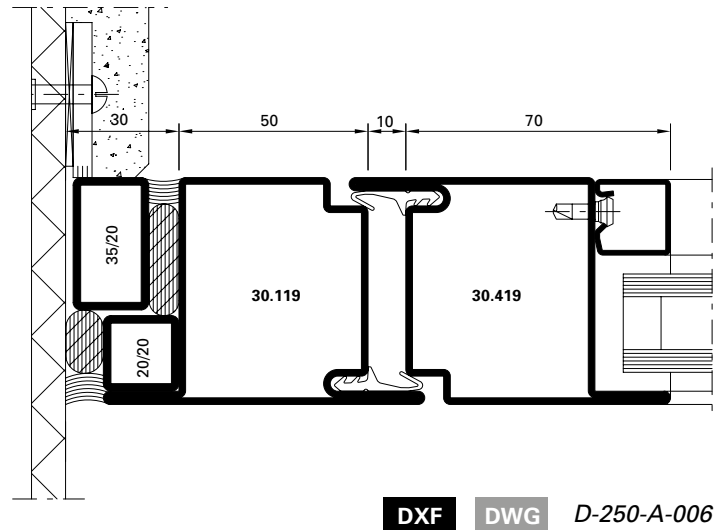
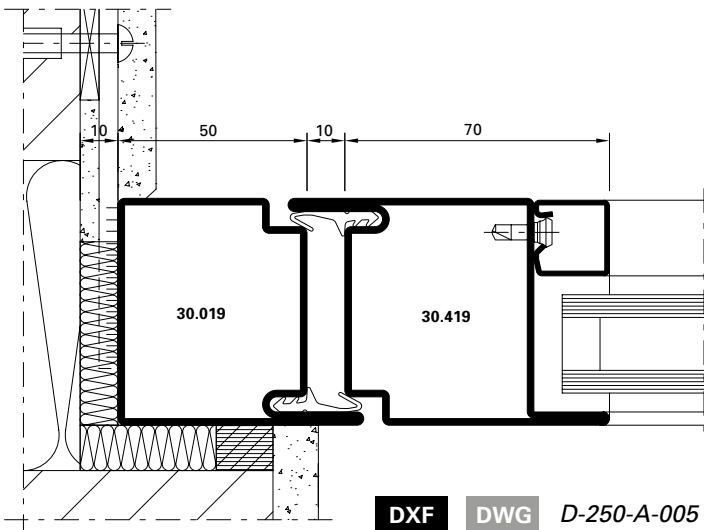
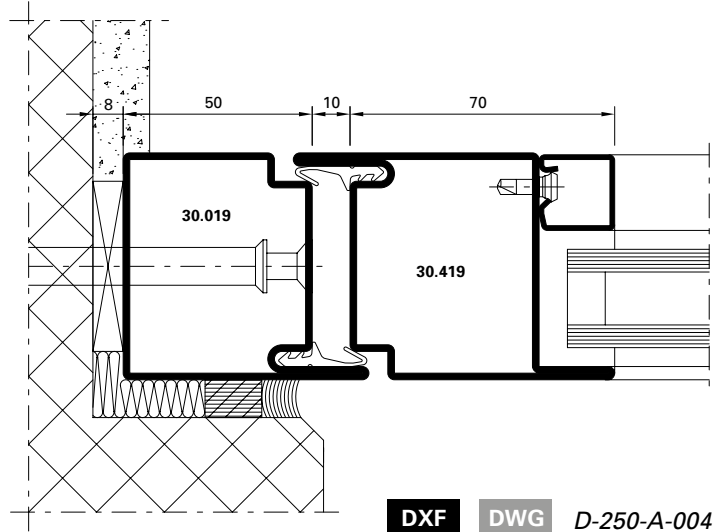
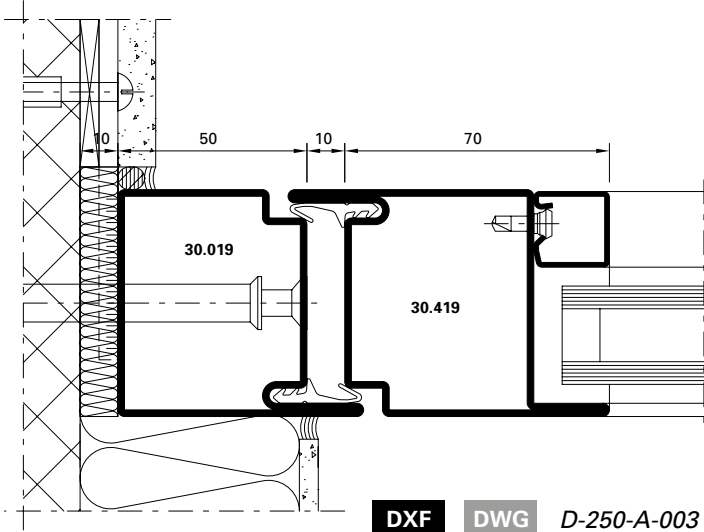
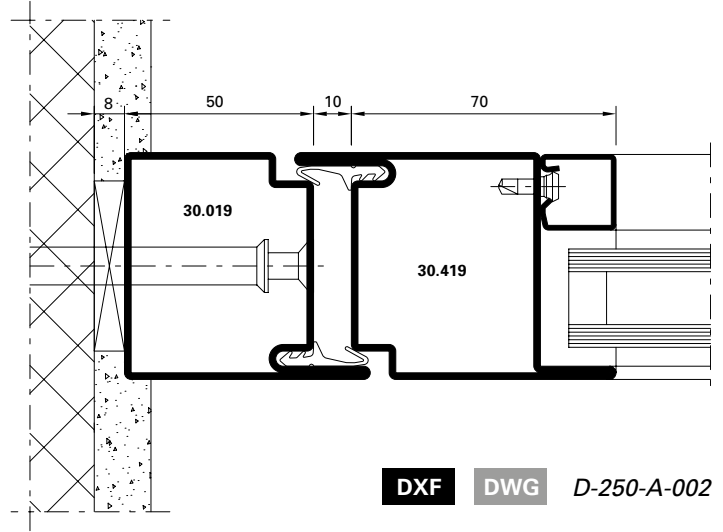
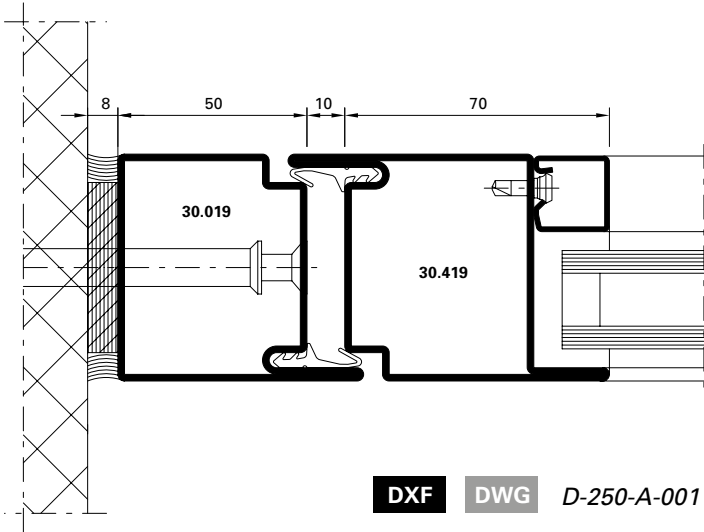

Anschlüsse am Bau im Masstab 1:2
Raccords au mur à l'échelle 1:2
Attachment to structure on scale 1:2

Jansen-Economy 60 Türen
Jansen-Economy 60 portes
Jansen-Economy 60 doors

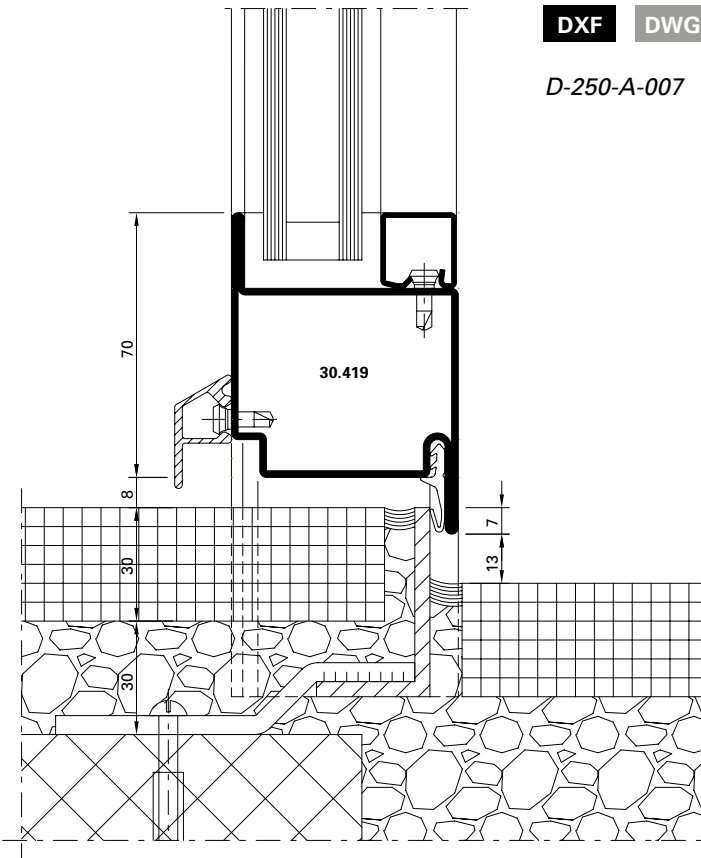

DXF **DWG**

D-250-A-007

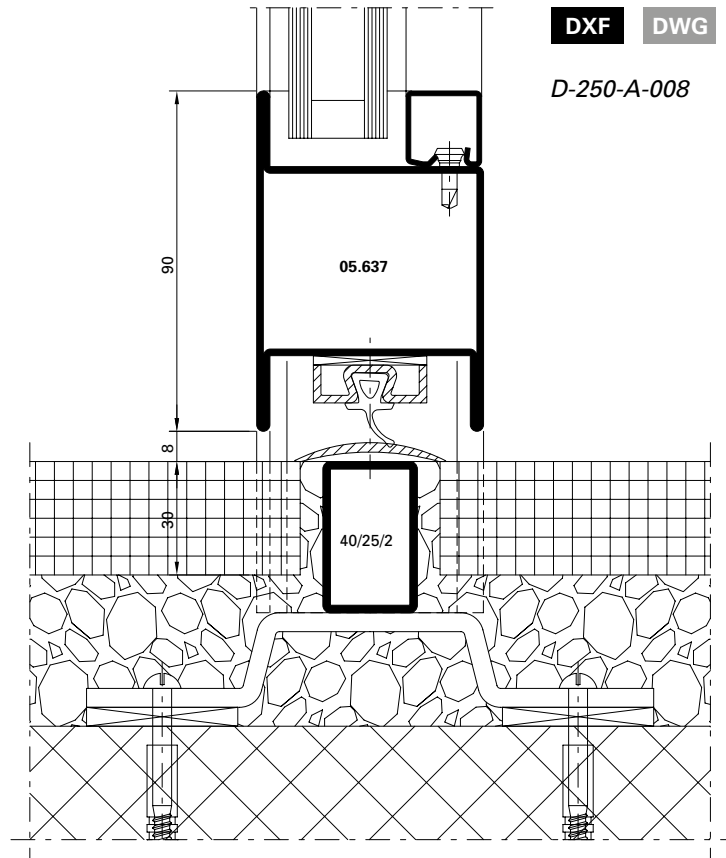

DXF **DWG**

D-250-A-008

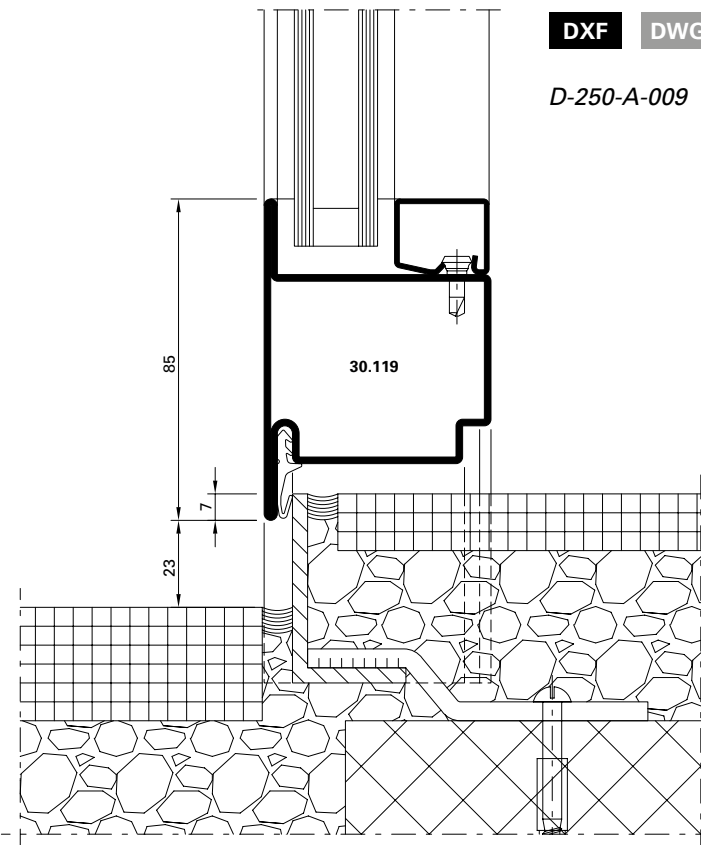

DXF **DWG**

D-250-A-009

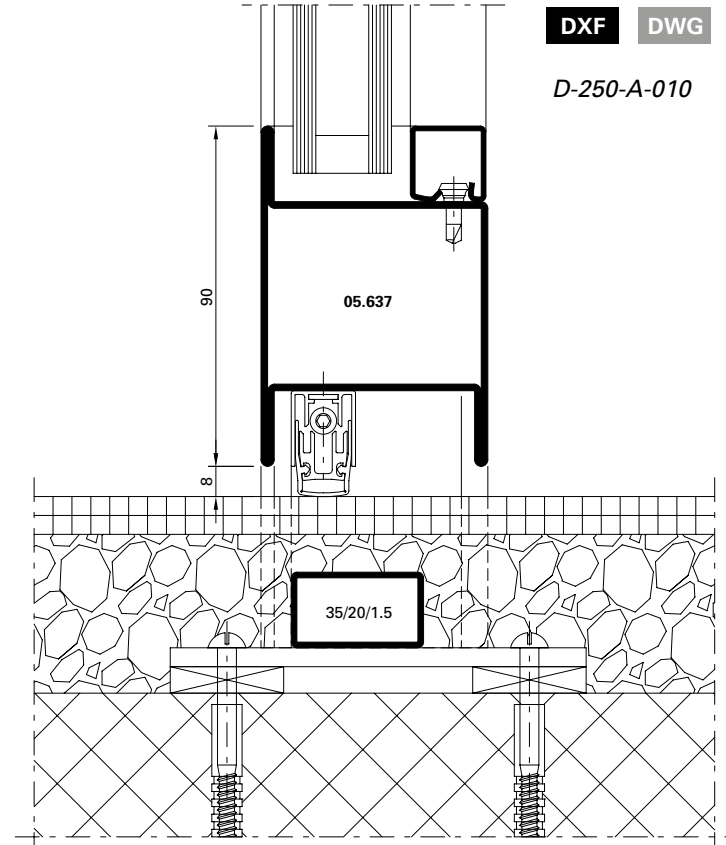

DXF **DWG**

D-250-A-010