

Systema®

TC110:

**Unterkonstruktionen für ALPHATON- und LONGOTON-Moeding –
Keramikplatten (verdeckte Klammerbefestigung)**

10



TC110:

holding tracks for ALPHATON- and LONGOTON-Moeding ceramic panels
(concealed clip-on fixing)

TC110:

ossature pour des plaques céramiques ALPHATON- et LONGOTON-Moeding
(attache avec crampe cachée)

TC110:

Unterkonstruktionen für ALPHATON- und LONGOTON-Moeding –
Keramikplatten (verdeckte Klammerbefestigung)

TC110:

holding tracks for ALPHATON- and LONGOTON-Moeding ceramic panels
(concealed clip-on fixing)

TC110:

ossature pour des plaques céramiques ALPHATON- et LONGOTON-Moeding
(attache avec crampe cachée)

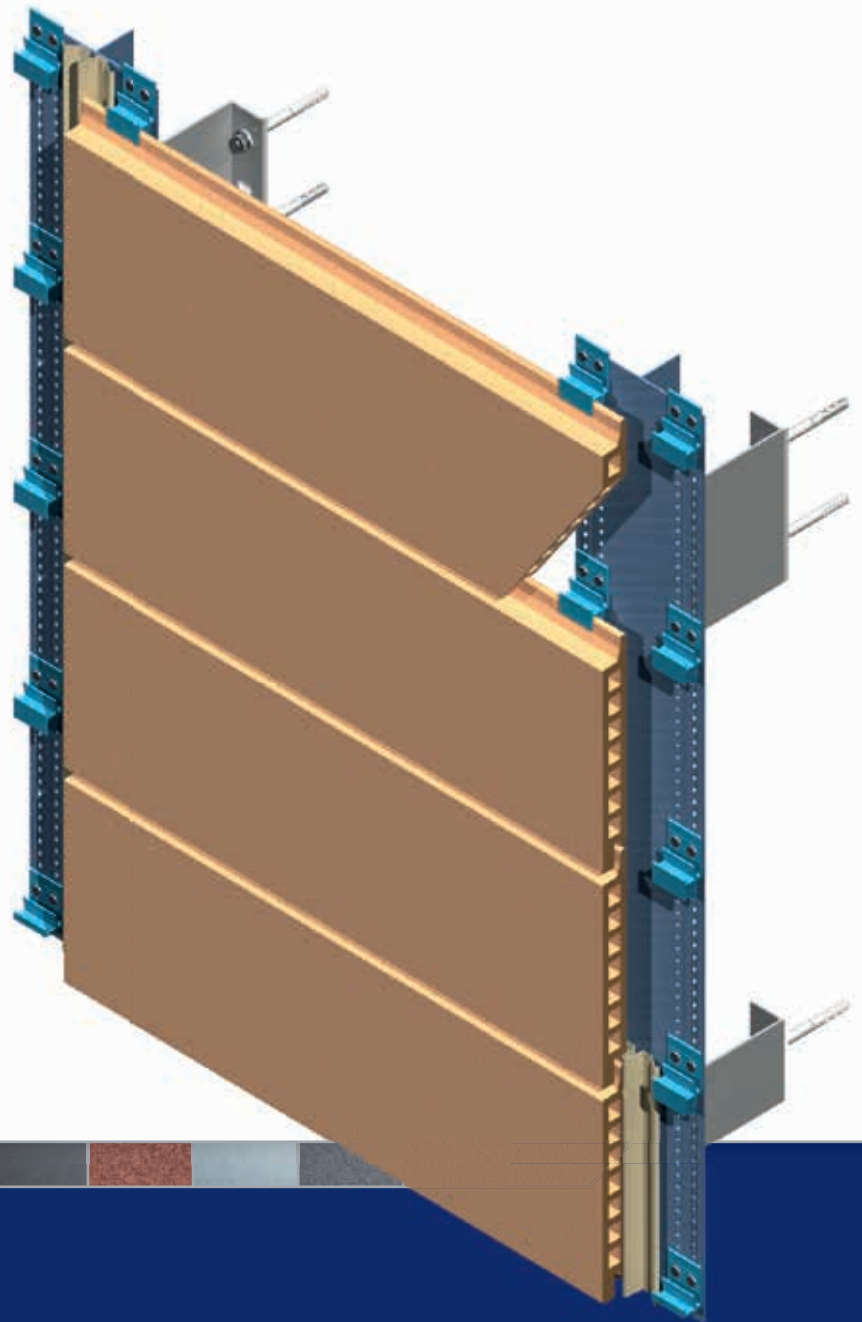

| | | | | |
|----------|---|--|--|--|
| System: | TC110 | | | |
| | Unterkonstruktionen für ALPHATON- und LONGOTON-Moeding – Keramikplatten (verdeckte Klammerbefestigung) | | | |
| System: | TC110 | holding tracks for ALPHATON- and LONGOTON-Moeding ceramic panels (concealed clip-on fixing) | | |
| Système: | TC110 | ossature pour des plaques céramiques ALPHATON- et LONGOTON-Moeding (attache avec crampe cachée) | | |
| Seite | | | | |
| page | | | | |
| page | | | | |
| 10.02 | Schnittübersicht ALPHATON | summary of sections ALPHATON | vue d'ensemble ALPHATON | |
| 10.03 | Isometrie ALPHATON | isometric view ALPHATON | dessin isométrique ALPHATON | |
| 10.04 | Schnitt horizontal ALPHATON | section horizontal ALPHATON | coupe horizontale ALPHATON | |
| 10.05 | Schnitt vertikal ALPHATON | section vertical ALPHATON | coupe verticale ALPHATON | |
| 10.06 | Innenecke ALPHATON | internal corner ALPHATON | coin intérieur ALPHATON | |
| 10.07 | Außenecke ALPHATON | external corner ALPHATON | coin extérieur ALPHATON | |
| 10.08 | Fenstersturz ALPHATON | window lintel ALPHATON | linteau ALPHATON | |
| 10.09 | Fensterlaibung ALPHATON | window recess ALPHATON | joue de fenêtre ALPHATON | |
| 10.10 | Fensterbank ALPHATON | window sill ALPHATON | bavette de fenêtre extérieure | |
| 10.11 | Schnittübersicht LONGOTON | summary of sections LONGOTON | vue d'ensemble LONGOTON | |
| 10.12 | Isometrie LONGOTON | isometric view LONGOTON | dessin isométrique LONGOTON | |
| 10.13 | Schnitt horizontal LONGOTON | section horizontal LONGOTON | coupe horizontale LONGOTON | |
| 10.14 | Schnitt vertikal LONGOTON | section vertical LONGOTON | coupe verticale LONGOTON | |
| 10.15 | Profilübersicht TC110 für Moeding ALPHATON und LONGOTON | profile list TC110 for Moeding ALPHATON and LONGOTON | ensemble de profil TC110 pour Moeding ALPHATON et LONGOTON | |

TC110 für ALPHATON-Moeding-Keramikplatten

TC110 for ALPHATON-Moeding ceramic panels

TC110 pour des plaques céramiques ALPHATON-Moeding

Schnittübersicht

summary of sections

vue d'ensemble

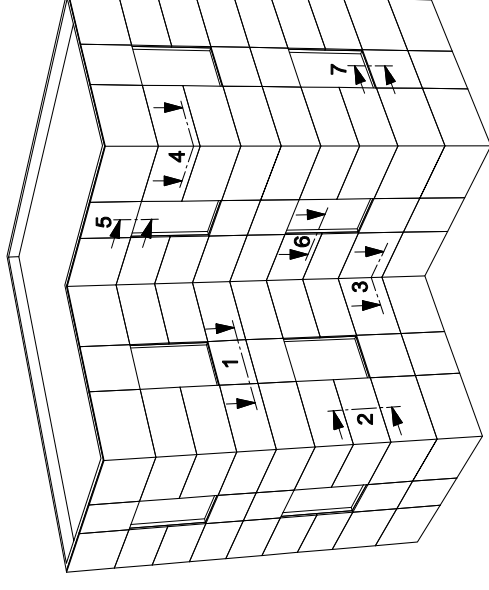

Schnitt 1 : horizontal
Schnitt 2 : vertikal
Schnitt 3 : Innenecke
Schnitt 4 : Außenecke
Schnitt 5 : Fenstersturz
Schnitt 6 : Fensterlaibung
Schnitt 7 : Fensterbank

section 1 : horizontal
section 2 : vertical
section 3 : internal corner
section 4 : external corner
section 5 : window lintel
section 6 : window recess
section 7 : windowsill

coupe 1 : horizontale
coupe 2 : verticale
coupe 3 : coin intérieur
coupe 4 : coin extérieur
coupe 5 : linteau
coupe 6 : joue de fenêtre
coupe 7 : bavette de fenêtre extérieure

Unterkonstruktionen für
ALPHATON-Moeding-
Keramikplatten (verdeckte
Klammerbefestigung)

holding tracks for
ALPHATON-Moeding
ceramic panels
(concealed clip-on fixing)

ossature pour des plaques
céramiques ALPHATON-
Moeding (attache avec
crampe cachée)

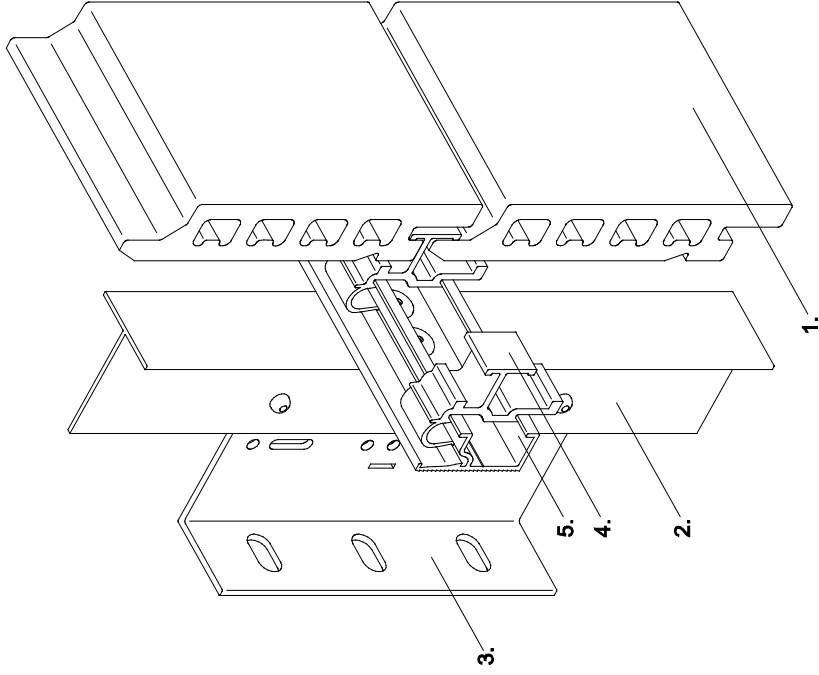

- | | | |
|--|---|---|
| 1. ALPHATON-Fassadenplatte | 1. ALPHATON cladding panel | 1. plaque de façade |
| 2. senkrechtes Tragprofil | 2. vertical holding track | ALPHATON |
| 3. System L-Wandkonsole | 3. System L-bracket | 2. profil support vertical |
| 4. Halter für Fassadenplatte | 4. holding track for cladding panel | 3. équerre en L Systema |
| 5. waagerechtes Tragprofil Generation 06 | 5. horizontal holding profile Generation 06 | 4. support de plaque de façade |
| | | 5. profil support horizontale Generation 06 |

Schnitt 1
horizontal
ALPHATON

section 1
horizontal
ALPHATON

coupe 1
horizontale
ALPHATON

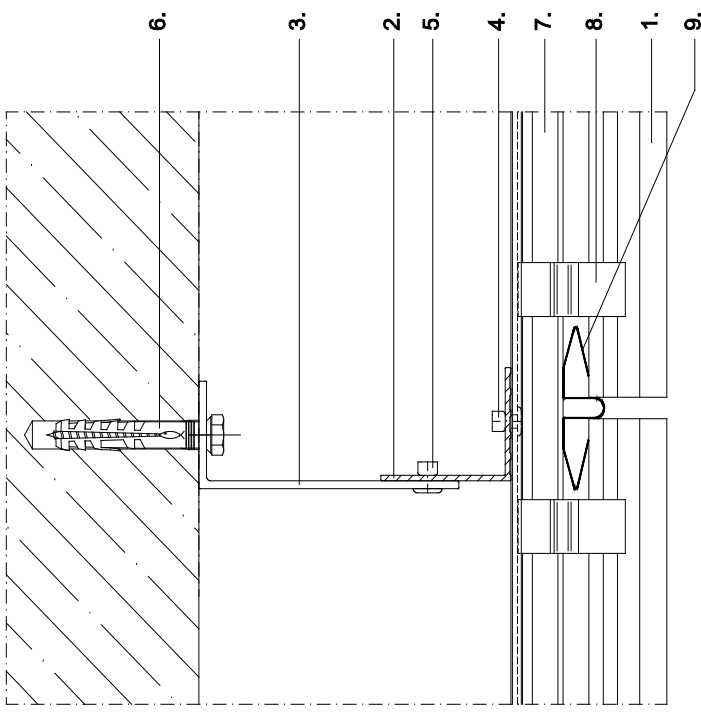

- | | | |
|--|---|---|
| 1. ALPHATON-Fassadenplatte | 1. ALPHATON cladding panel | 1. plaque de façade |
| 2. senkrechtes Tragprofil | 2. vertical holding track | ALPHATON |
| 3. System L-Wandkonsole | 3. System L-bracket | 2. profil support vertical |
| 4. Befestigungsniet | 4. fixing rivet | 3. équerre en L Systema |
| 5. Verbindungsniet | 5. connecting rivet | 4. rivet de fixation |
| 6. Verankerung | 6. fixing | 5. jonction |
| 7. waagerechtes Tragprofil Generation 06 | 7. horizontal holding profile Generation 06 | 6. ancrage |
| 8. Halter für Fassadenplatte | 8. holding track for cladding panel | 7. profil support horizontale Generation 06 |
| 9. Fugenprofil | 9. joint profile | 8. support pour plaque de façade |
| | | 9. profil de joint |

**Schnitt 2
vertikal**
ALPHATON

**section 2
vertical**
ALPHATON

**coupe 2
verticale**
ALPHATON

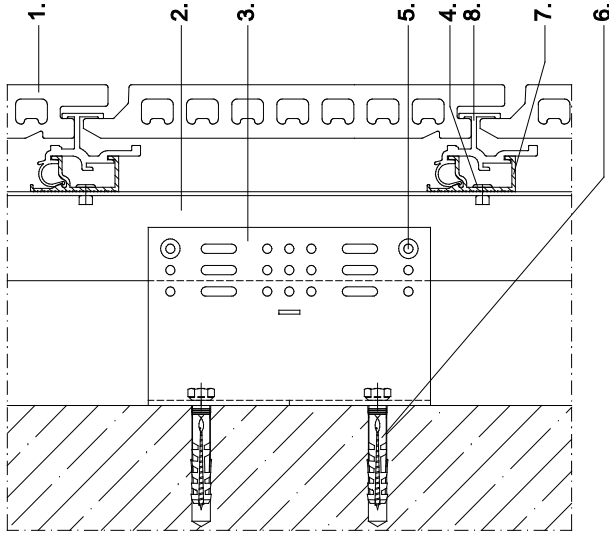

- | | |
|--|---|
| 1. ALPHATON-Fassadenplatte | 1. plaque de façade |
| 2. senkrechtes Tragprofil | 2. vertical holding track |
| 3. Systea L-Wandkonsole | 3. Systea L-bracket |
| 4. Befestigungsniet | 4. fixing rivet |
| 5. Verbindungsniet | 5. connecting rivet |
| 6. Verankerung | 6. fixing |
| 7. waagerechtes Tragprofil Generation 06 | 7. horizontal holding profile Generation 06 |
| 8. Halter für Fassadenplatte | 8. holding track for cladding panel |

**Schnitt 3
Innenecke**
ALPHATON

**section 3
internal corner**
ALPHATON

**coupe 3
coin intérieur**
ALPHATON

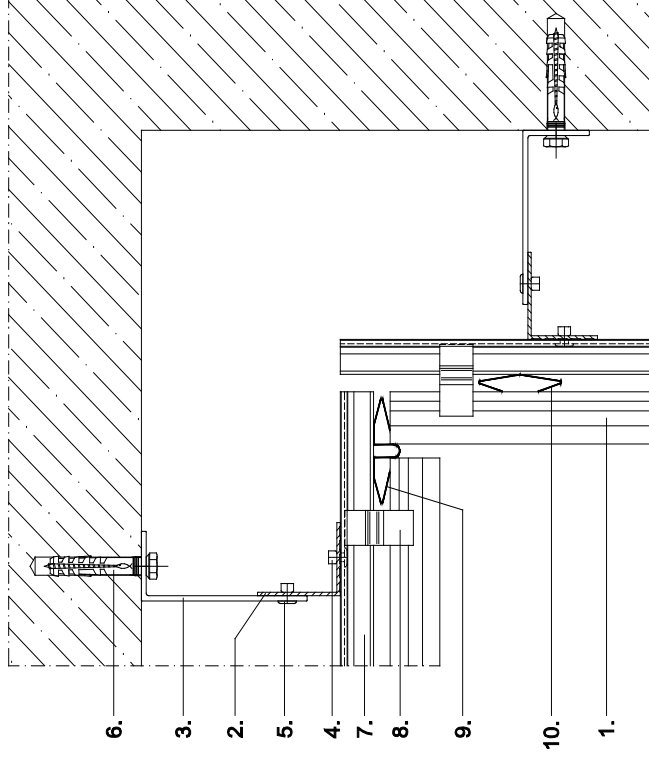

- | | |
|--|---|
| 1. ALPHATON-Fassadenplatte | 1. plaque de façade |
| 2. senkrechtes Tragprofil | 2. vertical holding track |
| 3. Systea L-Wandkonsole | 3. Systea L-bracket |
| 4. Befestigungsniet | 4. fixing rivet |
| 5. Verbindungsniet | 5. connecting rivet |
| 6. Verankerung | 6. fixing |
| 7. waagerechtes Tragprofil Generation 06 | 7. horizontal holding profile Generation 06 |
| 8. Halter für Fassadenplatte | 8. holding track for cladding panel |
| 9. Fugenprofil | 9. joint profile |
| 10. Federprofil | 10. spring profile |

Schnitt 4
Außenecke
ALPHATON

section 4
external corner
ALPHATON

coupe 4
coin extérieur
ALPHATON

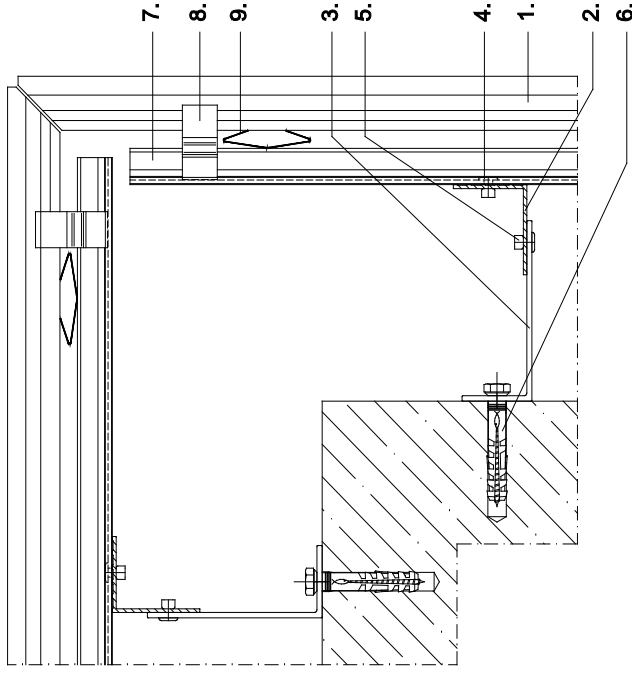

- | | |
|--|---|
| 1. ALPHATON-Fassadenplatte | 1. ALPHATON cladding panel |
| 2. senkrechtcs Tragprofil | 2. vertical holding track |
| 3. Systea L-Wandkonsole | 3. Systea L-bracket |
| 4. Befestigungsniel | 4. fixing rivet |
| 5. Verbindungsniel | 5. connecting rivet |
| 6. Verankerung | 6. fixing |
| 7. waagerechtes Tragprofil Generation 06 | 7. horizontal holding profile Generation 06 |
| 8. Halter für Fassadenplatte | 8. holding track for cladding panel |
| 9. Federprofil | 9. spring profile |

Schnitt 5
Fenstersturz
ALPHATON

section 5
window lintel
ALPHATON

coupe 5
linteau
ALPHATON

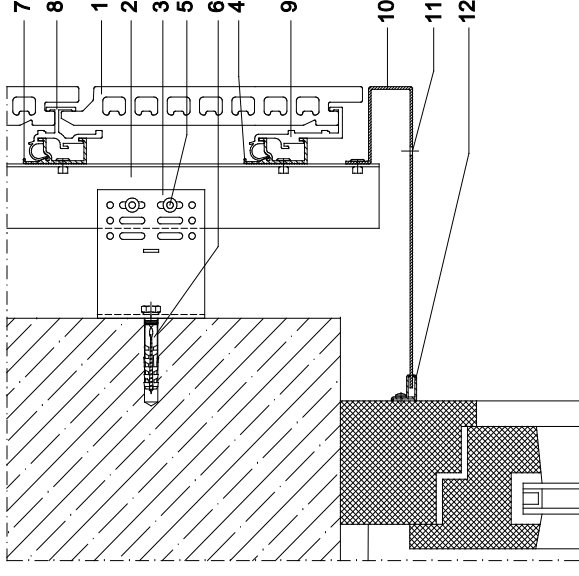

- | | |
|--|---|
| 1. ALPHATON-Fassadenplatte | 1. ALPHATON cladding panel |
| 2. senkrechtcs Tragprofil | 2. vertical holding track |
| 3. Systea L-Wandkonsole | 3. Systea L-bracket |
| 4. Befestigungsniel | 4. fixing rivet |
| 5. Verbindungsniel | 5. connecting rivet |
| 6. Verankerung | 6. fixing |
| 7. waagerechtes Tragprofil Generation 06 | 7. horizontal holding profile Generation 06 |
| 8. Halter für Fassadenplatte | 8. holding track for cladding panel |
| 9. Halter für Fassadenplatte unten | 9. lower holding track for cladding panel |
| 10. Fensterzarge | 10. window frame |
| 11. Belüftungsöffnung | 11. ventilation opening |
| 12. Systea Stimmgabelprofil | 12. Systea F-profile (diapason) |

Schnitt 6
Fensterlaibung
ALPHATON

section 6
window recess
ALPHATON

coupe 6
joue de fenêtre
ALPHATON

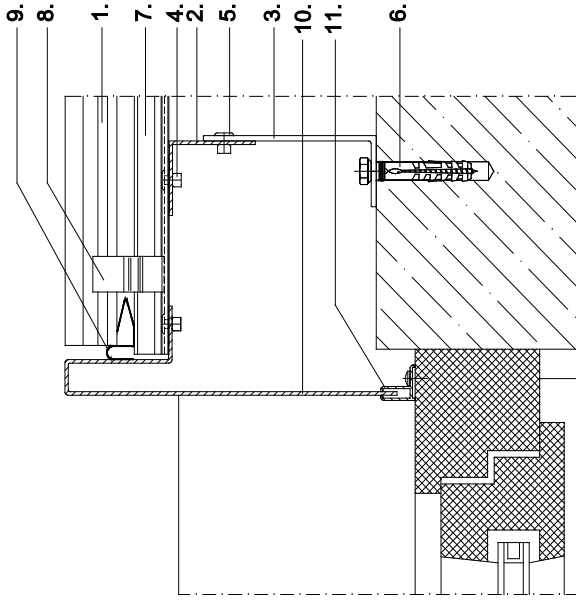

- | | | |
|--|---|--|
| 1. ALPHATON-Fassadenplatte | 1. ALPHATON cladding panel | 1. plaque de façade |
| 2. senkrechtcs Tragprofil | 2. vertical holding track | ALPHATON |
| 3. Systea L-Wandkonsole | 3. Systea L-bracket | 2. profil support vertical |
| 4. Befestigungsniet | 4. fixing rivet | 3. équerre en L Systea |
| 5. Verbindungsniet | 5. connecting rivet | 4. rivet de fixation |
| 6. Verankerung | 6. fixing | 5. jonction |
| 7. waagerechtes Tragprofil Generation 06 | 7. horizontal holding profile Generation 06 | 6. ancrage |
| 8. Halter für Fassadenplatte | 8. holding track for cladding panel | 7. profil support horizontal Generation 06 |
| 9. Fugenprofil | 9. joint profile | 8. support pour plaque de façade |
| 10. Fensterzarge | 10. window frame | 9. profil de joint |
| 11. Systea Stimmgabelprofil | 11. Systea F-profile | 10. châssis |
| | | 11. profil F Systea (diapason) |

Schnitt 7
Fensterbank
ALPHATON

section 7
windowsill
ALPHATON

coupe 7
bavette de fenêtre
extérieure
ALPHATON

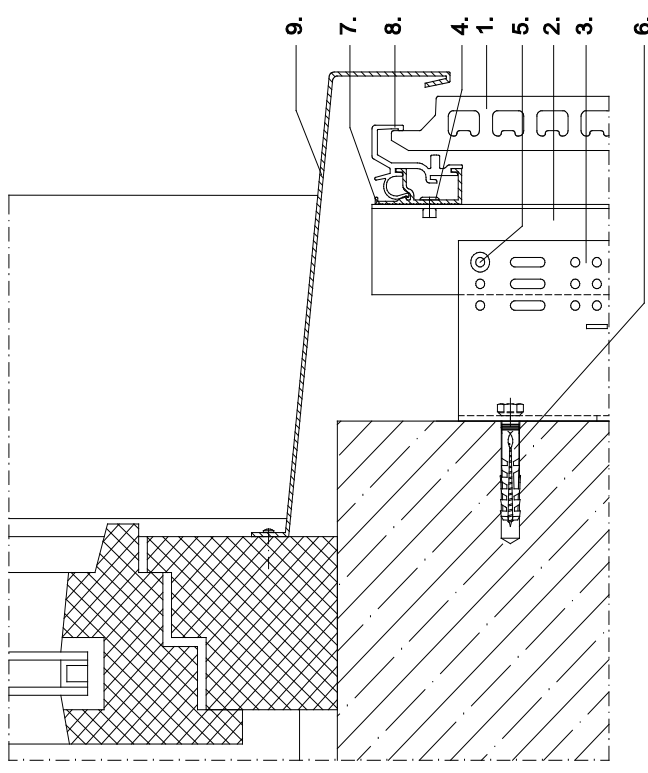

- | | | |
|--|---|--|
| 1. ALPHATON-Fassadenplatte | 1. ALPHATON cladding panel | 1. plaque de façade |
| 2. senkrechtcs Tragprofil | 2. vertical holding track | ALPHATON |
| 3. Systea L-Wandkonsole | 3. Systea L-bracket | 2. profil support vertical |
| 4. Befestigungsniet | 4. fixing rivet | 3. équerre en L Systea |
| 5. Verbindungsniet | 5. connecting rivet | 4. rivet de fixation |
| 6. Verankerung | 6. fixing | 5. jonction |
| 7. waagerechtes Tragprofil Generation 06 | 7. horizontal holding profile Generation 06 | 6. ancrage |
| 8. Halter für Fassadenplatte oben | 8. upper holding track for cladding panel | 7. profil support horizontal Generation 06 |
| 9. Systea Fensterbank | 9. Systea windowsill | 8. support pour plaque de façade haut |
| | | 9. bavette Systea |

TC110 für LONGOTON-
Moeding-Keramikplatten

Schnittübersicht

TC110 for LONGOTON-
Moeding ceramic panels

summary of sections

TC110 pour des plaques
céramiques LONGOTON-
Moeding

vue d'ensemble

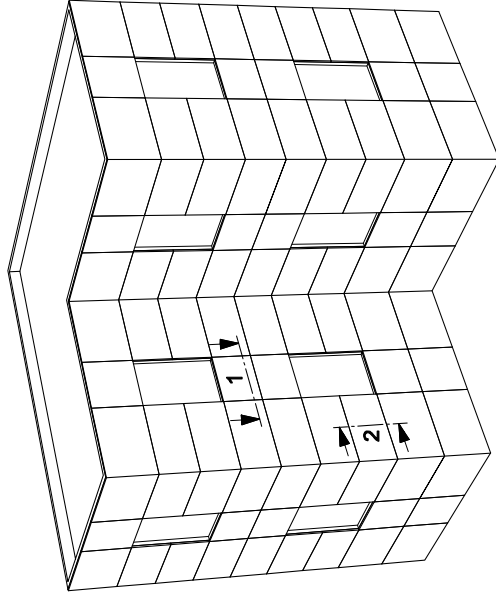

Schnitt 1: horizontal
Schnitt 2: vertikal

section 1: horizontal
section 2: vertical

coupe 1: horizontale
coupe 2: verticale

TC110

Unterkonstruktionen für
LONGOTON-Moeding-
Keramikplatten (verdeckte
Klammerbefestigung)

holding tracks for
LONGOTON-Moeding
ceramic panels
(concealed clip-on fixing)

ossature pour des plaques
céramiques LONGOTON-
Moeding (attache avec
crampe cachée)

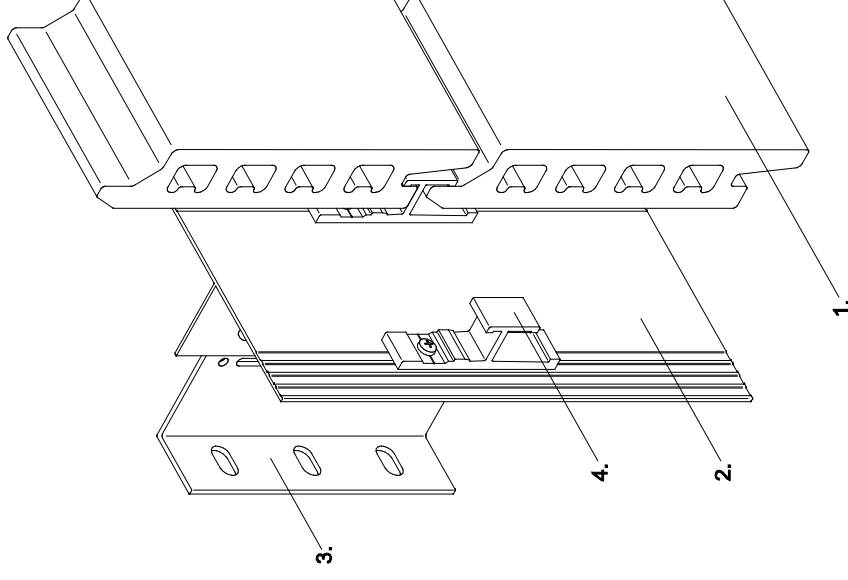

1. LONGOTON-Fassaden-
platte
2. senkrechtes Tragprofil
3. Systea L-Wandkonsole
4. Halter für Fassadenplatte

1. LONGOTON cladding panel
2. vertical holding track
3. Systea L-bracket
4. holding track for cladding
panel
1. plaque de façade
LONGOTON
2. profil support vertical
3. équerre en L Systea
4. support pour plaque de
façade

Schnitt 1
horizontal
LONGOTON

section 1
horizontal
LONGOTON

coupe 1
horizontale
LONGOTON

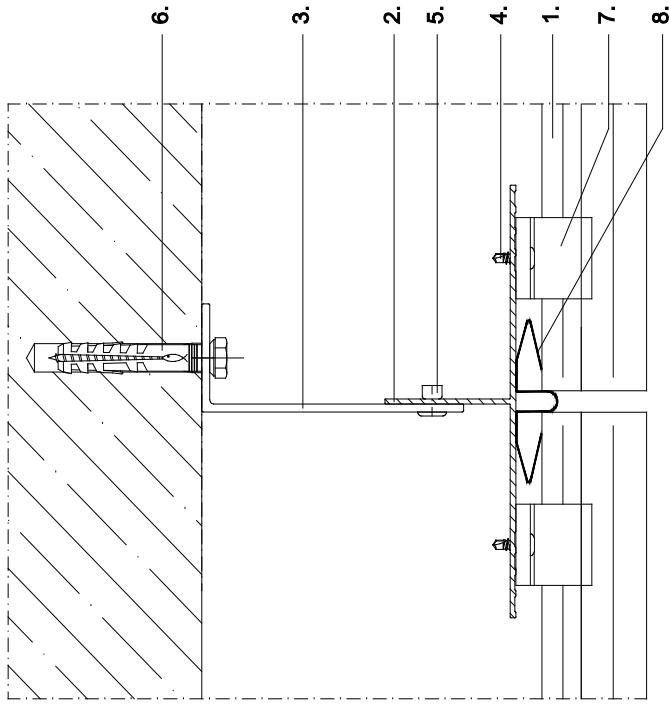

- | | |
|------------------------------|-------------------------------------|
| 1. LONGOTON-Fassadenplatte | 1. LONGOTON cladding panel |
| 2. senkrechtes Tragprofil | 2. vertical holding track |
| 3. Systea L-Wandkonsole | 3. Systea L-bracket |
| 4. Befestigungselement | 4. fixing element |
| 5. Verbindungsniet | 5. connecting rivet |
| 6. Verankerung | 6. fixing |
| 7. Halter für Fassadenplatte | 7. holding track for cladding panel |
| 8. Fugenprofil | 8. joint profile |

Schnitt 2
vertikal
LONGOTON

section 2
vertical
LONGOTON

coupe 2
verticale
LONGOTON

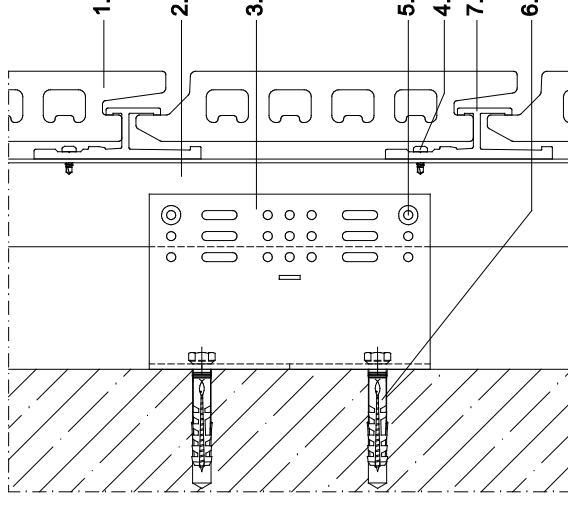

- | | |
|------------------------------|-------------------------------------|
| 1. LONGOTON-Fassadenplatte | 1. LONGOTON cladding panel |
| 2. senkrechtes Tragprofil | 2. vertical holding track |
| 3. Systea L-Wandkonsole | 3. Systea L-bracket |
| 4. Befestigungselement | 4. fixing element |
| 5. Verbindungsniet | 5. connecting rivet |
| 6. Verankerung | 6. fixing |
| 7. Halter für Fassadenplatte | 7. holding track for cladding panel |
| | 8. joint profile |

Inhaltsverzeichnis Profilübersicht TC110 für Moeding ALPHATON und LONGOTON
 Contents profile list TC110 for Moeding ALPHATON and LONGOTON
 Index ensemble de profil TC110 pour Moeding ALPHATON et LONGOTON

| Seite page | Profile | profiles | profilés |
|---------------|---|---|--|
| 10.16 | vertikale Tragprofile Winkelprofil 45/45 Wanddicke 2mm prof. Winkelprofil 42/50 Typ I prof. T-Profil 40/55 | vertical holding tracks L-profile 45/45 wall thickness 2mm prof. L-profile 42/50 Typ I prof. T-profile 40/55 | rails porteurs verticaux profil L 45/45 épaisseur du mur 2mm prof. profil L 42/50 Typ I prof. profil T 40/55 |
| 10.17 | T-Profil 65/50 Wanddicke 2mm T-Profil 80/50 Wanddicke 2mm T-Profil 110/45 Wanddicke 2mm, gelocht | T-profile 65/50 wall thickness 2mm T-profile 80/50 wall thickness 2mm T-profile 110/45 wall thickness 2mm, punched | profil T 65/50 épaisseur du mur 2mm profil T 80/50 épaisseur du mur 2mm profil T 110/45 épaisseur du mur 2mm, troué |
| 10.18 | T-Profil 160/50 Wanddicke 2mm prof., ohne Lochung T-Profil 160/50 Wanddicke 2mm prof., gelocht | T-profile 160/50 wall thickness 2mm prof., unperforated T-profile 160/50 wall thickness 2mm prof., punched | profil T 160/50 épaisseur du mur 2mm prof., sans perforation profil T 160/50 épaisseur du mur 2mm prof., troué |
| 10.19 | L-Wandkonsolen WB 0 - 85/160/250mm | L-brackets WB 0 - 85/160/250mm | équerres en L WB 0 - 85/160/250mm |
| 10.20 | WB 1-6 - 85/160/250mm | WB 1-6 - 85/160/250mm | WB 1-6 - 85/160/250mm |
| 10.21 | WB 7-9,5 - 85/160/250 | WB 7-9,5 - 85/160/250 | WB 7-9,5 - 85/160/250 |
| 10.22 | WB 10-14 - 85/160/250mm | WB 10-14 - 85/160/250mm | WB 10-14 - 85/160/250mm |

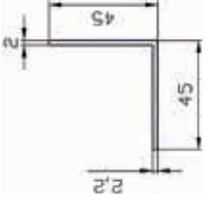
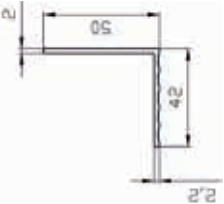
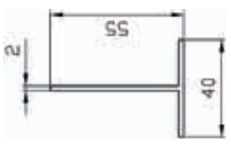

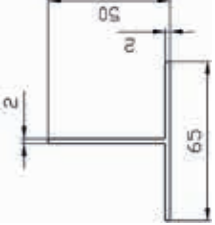
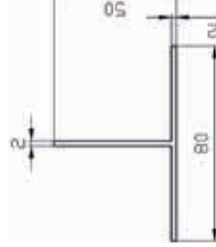
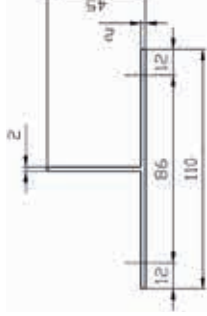
| Profiltyp profile type type de profil | Länge (mm) length (mm) longueur (mm) | Material material matériel | Einzelpreis unit price prix unitaire |
|--|--|----------------------------------|--|
|  <p>Winkelprofil 45/45 Wanddicke 2mm prof. L-profile 45/45 wall thickness 2mm prof. profil L 45/45 épaisseur du mur 2mm prof.</p> | 5600 | EN AW 6063 T66 | |
| | 6000 | | |
|  <p>Winkelprofil 42/50 Typ I prof. L-profile 42/50 Typ I prof. profil L 42/50 Typ I prof.</p> | 3000 | EN AW 6063 T66 | |
| | 6000 | | |
|  <p>T-Profil 40/55 T-profile 40/55 profil T 40/55</p> | 5600 | EN AW 6063 T66 | |
| | 6000 | | |

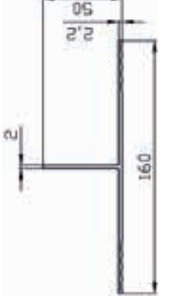
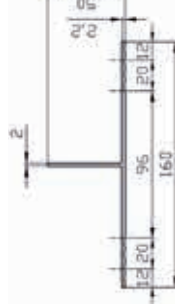
| Profiltyp profile type type de profil | Länge (mm) length (mm) longueur (mm) | Material material matériel | Einzelpreis unit price prix unitaire |
|---|--|----------------------------------|--|
|  <p>T-Profil 65/50 Wanddicke 2mm T-profile 65/50 wall thickness 2mm profilé T 65/50 épaisseur du mur 2mm</p> | 5600 | EN AW 6063 T66 | |
| | 6000 | | |
|  <p>T-Profil 80/50 Wanddicke 2mm T-profile 80/50 wall thickness 2mm profilé T 80/50 épaisseur du mur 2mm</p> | 5600 | EN AW 6063 T66 | |
| | 6000 | | |
|  <p>T-Profil 110/45 Wanddicke 2mm, gebocht T-profile 110/45 wall thickness 2mm, punched profilé T 110/45 épaisseur du mur 2mm, troué</p> | 6000 | EN AW 6063 T66 | |
| | | | |

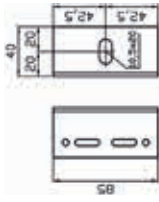
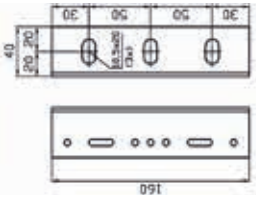
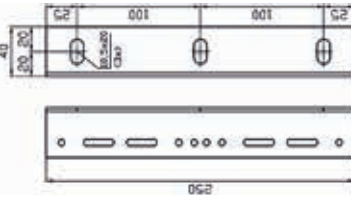
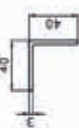
| Profiltyp profile type type de profil | Länge (mm) length (mm) longueur (mm) | Material material matériel | Einzelpreis unit price prix unitaire |
|--|--|----------------------------------|--|
|  <p>T-Profil 160/50 Wanddicke 2mm prof., ohne Lochung T-profile 160/50 wall thickness 2mm prof., unperforated profilé T 160/50 épaisseur du mur 2mm prof., sans perforation</p> | 6000 | EN AW 6063 T66 | |
| | | | |
|  <p>T-Profil 160/50 Wanddicke 2mm prof., gelocht T-profile 160/50 wall thickness 2mm prof., punched profilé T 160/50 épaisseur du mur 2mm prof., troué</p> | 6000 | EN AW 6063 T66 | |
| | | | |
| | | | |

| Profiltyp profile type type de profil | Länge (mm) length (mm) longueur (mm) | Material material matériau | Einzelpreis unit price prix unitaire |
|---|--|----------------------------------|--|
|     | WB0 40/40/3-85 | EN AW 6063 T66 | |
| | WB0 40/40/3-160 | EN AW 6063 T66 | |
| | WB0 40/40/3-250 | EN AW 6063 T66 | |

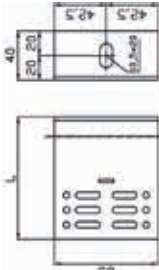
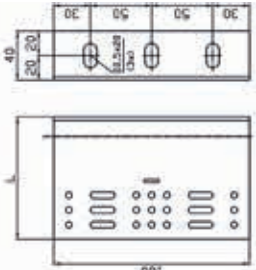
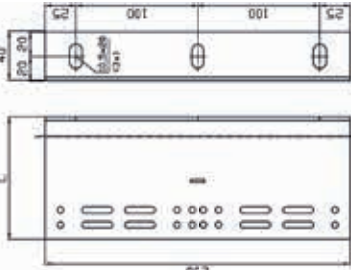
WB0 40/40/3 - 85/160/250mm

| Profiltyp profile type type de profil | Länge (mm) length (mm) longueur (mm) | Material material matériau | Einzelpreis unit price prix unitaire |
|---|--|----------------------------------|--|
|     | WB1 40/60/3-85 WB2 40/80/3-85 WB3 40/100/3-85 WB4 40/120/3-85 WB5 40/140/3-85 WB6 40/160/3-85 | EN AW 6063 T66 | |
| | WB1 40/60/3-160 WB2 40/80/3-160 WB3 40/100/3-160 WB4 40/120/3-160 WB5 40/140/3-160 WB6 40/160/3-160 | EN AW 6063 T66 | |
| | WB1 40/60/3-250 WB2 40/80/3-250 WB3 40/100/3-250 WB4 40/120/3-250 WB5 40/140/3-250 WB6 40/160/3-250 | EN AW 6063 T66 | |

| | |
|--|-----------------------------------|
| L-Wandkonsole L-bracket équerre en L | Länge L length L longueur L |
| WB1 | 60 mm |
| WB2 | 80 mm |
| WB3 | 100 mm |
| WB4 | 120 mm |
| WB5 | 140 mm |
| WB6 | 160 mm |

WB 1-6 - 85/160/250mm

| Profiltyp profile type type de profil | Länge (mm) length (mm) longueur (mm) | Material material matériau | Einzelpreis unit price prix unitaire |
|---|--|----------------------------------|--|
| | WB7 40/180/4/3-85 WB8 40/200/4/3-85 WB8.5 40/210/4/3-85 WB9 40/220/4/3-85 WB9.5 40/230/4/3-85 | EN AW 6063 T66 | |
| | WB7 40/180/4/3-160 WB8 40/200/4/3-160 WB8.5 40/210/4/3-160 WB9 40/220/4/3-160 WB9.5 40/230/4/3-160 | EN AW 6063 T66 | |
| | WB7 40/180/4/3-250 WB8 40/200/4/3-250 WB8.5 40/210/4/3-250 WB9 40/220/4/3-250 WB9.5 40/230/4/3-250 | EN AW 6063 T66 | |

| L-Wandkonsole L-bracket équerre en L | Länge L length L longueur L |
|--|-----------------------------------|
| WB7 | 180 mm |
| WB8 | 200 mm |
| WB8.5 | 210 mm |
| WB9 | 220 mm |
| WB9.5 | 230 mm |

WB7-9.5 - 85/160/250mm

| Profiltyp profile type type de profil | Länge (mm) length (mm) longueur (mm) | Material material matériau | Einzelpreis unit price prix unitaire |
|---|---|----------------------------------|--|
| | WB10 43/240/4/3-85 WB11 43/260/4/3-85 WB12 43/280/4/3-85 WB13 43/300/4/3-85 WB14 43/320/4/3-85 | EN AW 6063 T66 | |
| | WB10 43/240/4/3-160 WB11 43/260/4/3-160 WB12 43/280/4/3-160 WB13 43/300/4/3-160 WB14 43/320/4/3-160 | EN AW 6063 T66 | |
| | WB10 43/240/4/3-250 WB11 43/260/4/3-250 WB12 43/280/4/3-250 WB13 43/300/4/3-250 WB14 43/320/4/3-250 | EN AW 6063 T66 | |

| L-Wandkonsole L-bracket équerre en L | Länge L length L longueur L |
|--|-----------------------------------|
| WB10 | 240 mm |
| WB11 | 260 mm |
| WB12 | 280 mm |
| WB13 | 300 mm |
| WB14 | 320 mm |

WB10-14 - 85/160/250mm

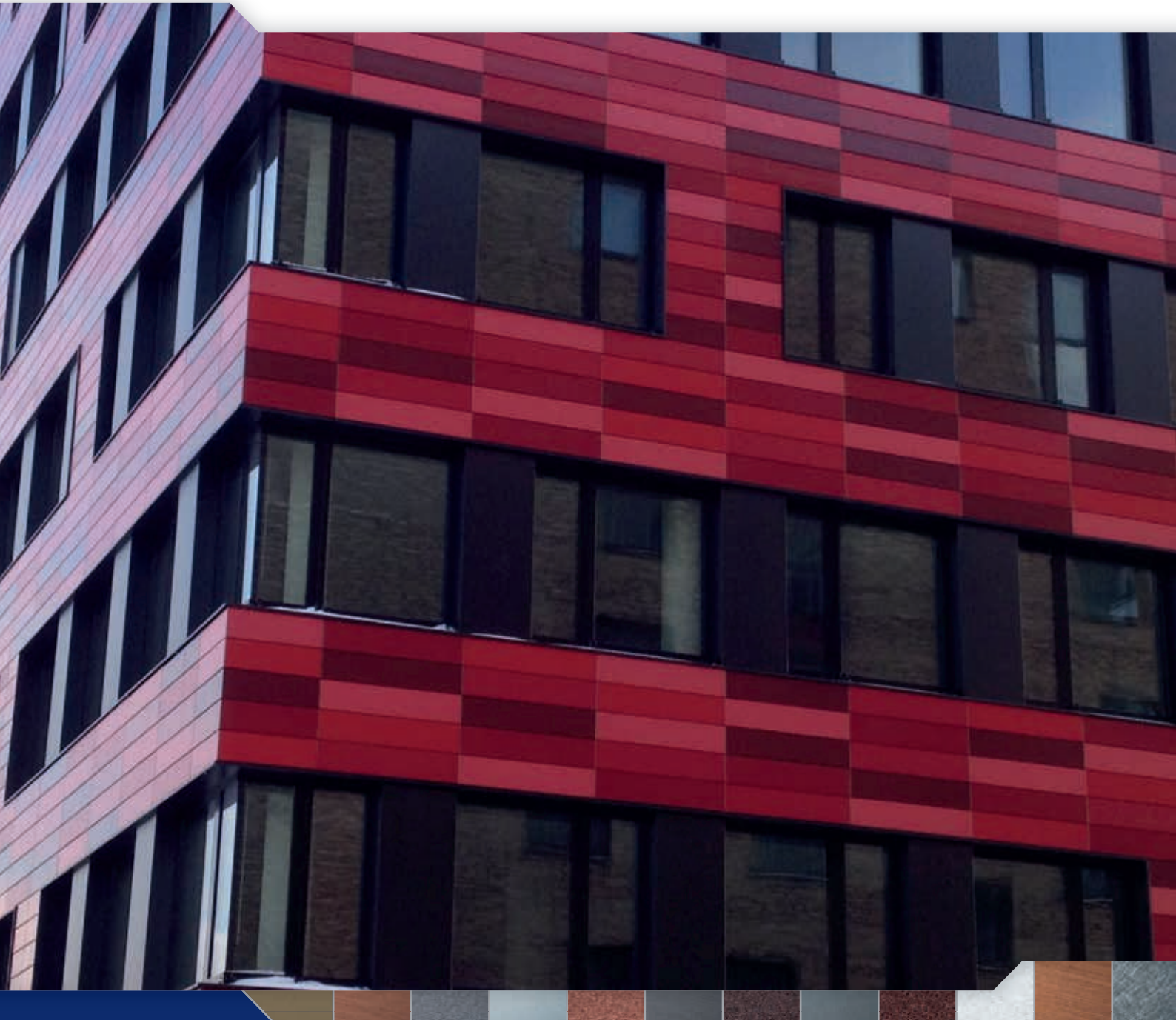

Systema[®]

Systema GmbH

Margarete-Steiff-Str. 6
D-24558 Henstedt-Ulzburg
Deutschland / Germany

Fon: +49 (0) 41 93 / 99 11-0
Fax: +49 (0) 41 93 / 99 11-49

info@systema.systems
www.systema.systems

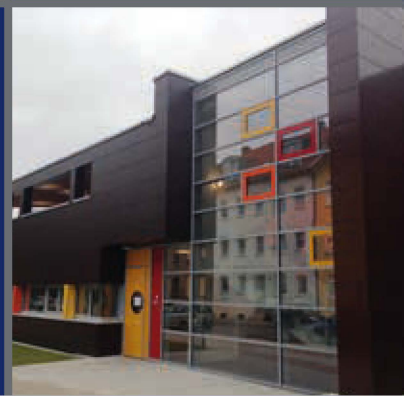

Bitte besuchen Sie uns für weitere
technische Informationen und
eine Vielzahl von Referenzen
im Internet: www.systema.systems