

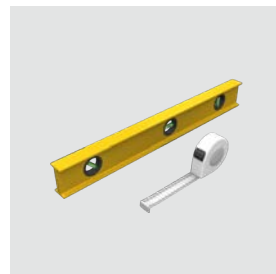

# Fundo Riolito Neo, Riolito, Riofino

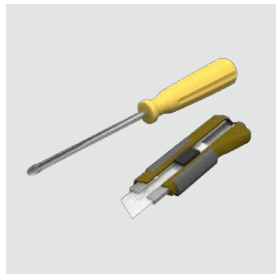

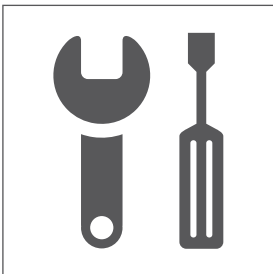

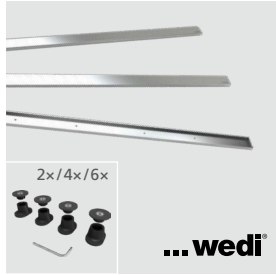
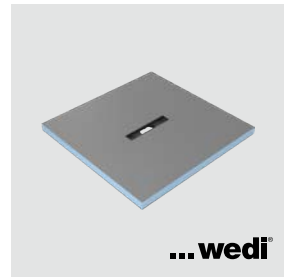
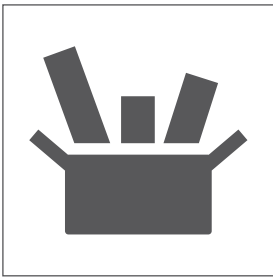
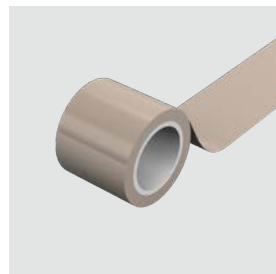
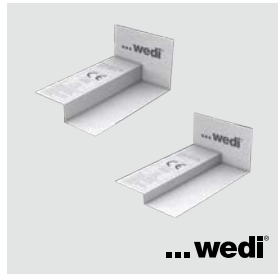
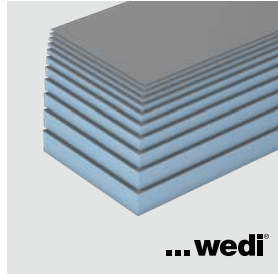
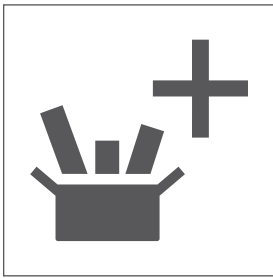

 <p>0799 (System 2+)</p>
<p>wedi GmbH Hollefeldstraße 51 48282 Emsdetten</p> <p>13 0799-CPR-132 DoP 0001</p>
<p>ETA-13/0385 ETAG 022 Teil 3</p>
<p>Bausatz mit wasserdichten Platten und weiteren Komponenten zur Herstellung einer Abdichtung unter einer Nuttschicht für die Verwendung in innen liegenden Nassbereichen Klassifizierung des Systems und deklarierte Produkt- und Systemeigenschaften siehe Anhang 1 der ETA-13/0385</p>

### Fundo Riolito Neo



Fundo Riolito



Fundo Riofino

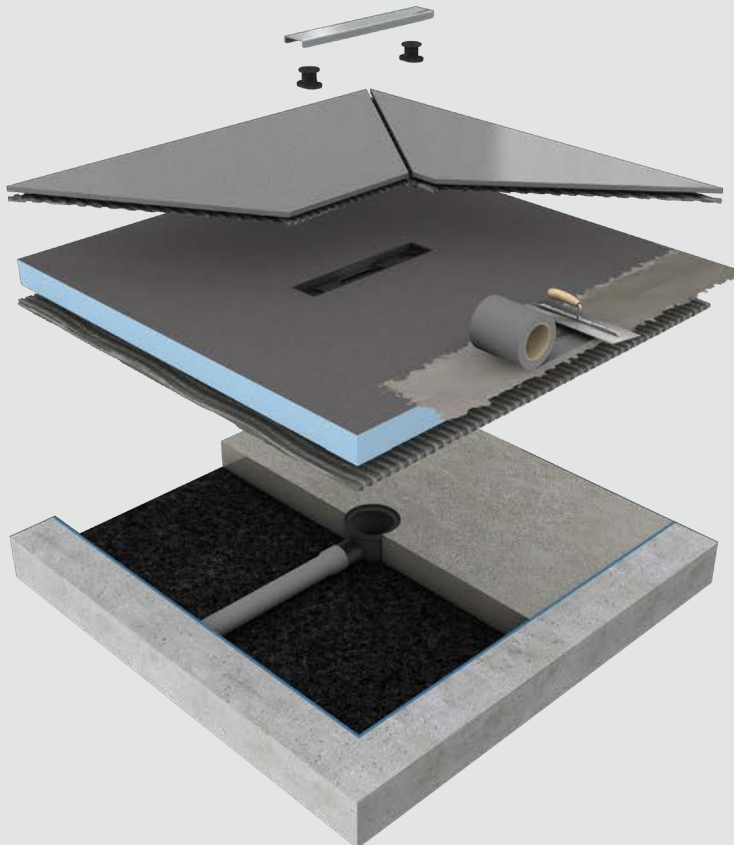

### Fundo Riolito Neo

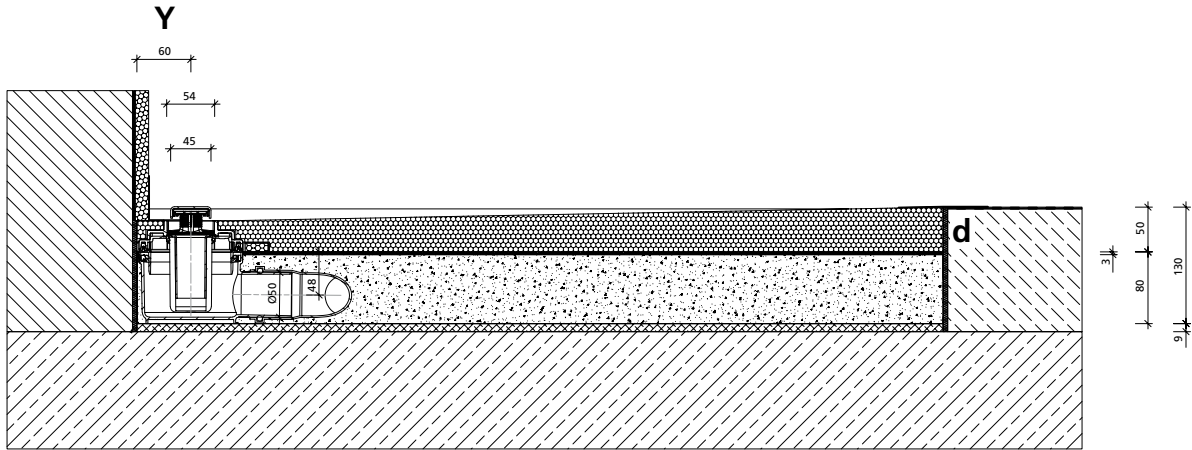

### Fundo Riolito

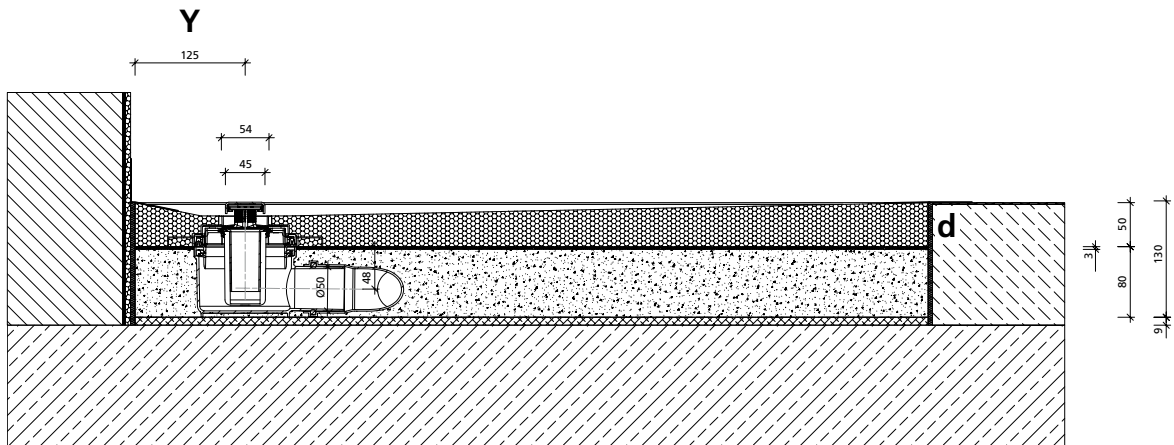

### Fundo Riofino

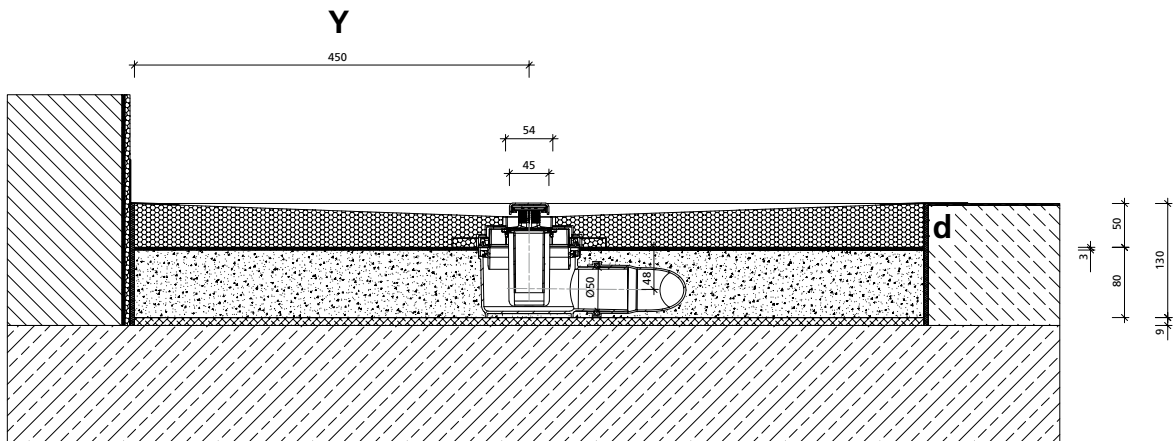



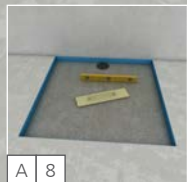
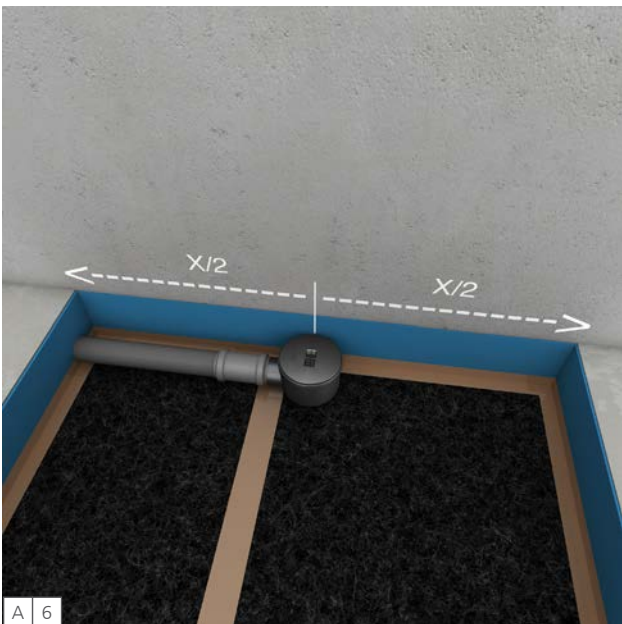
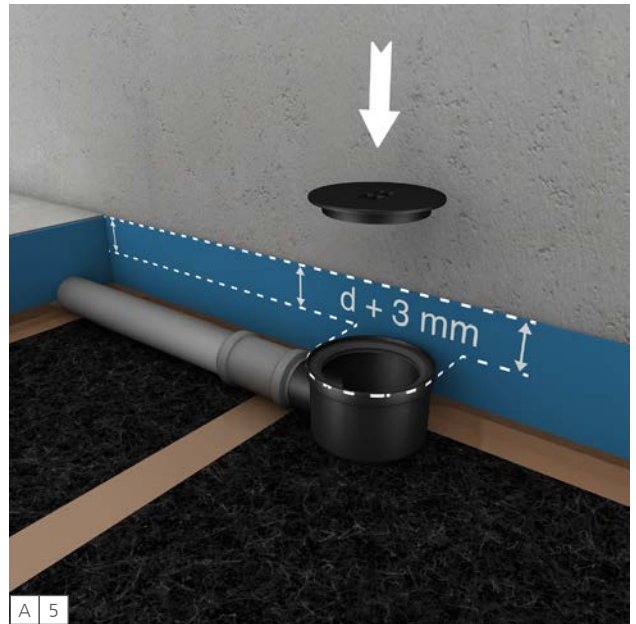
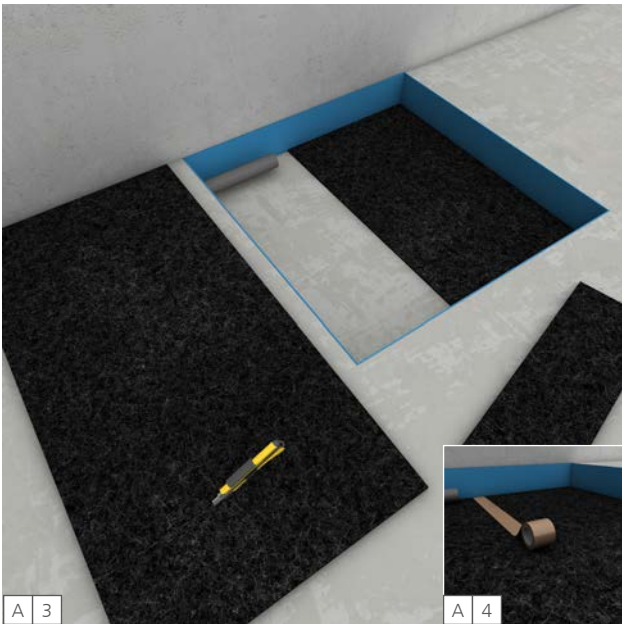
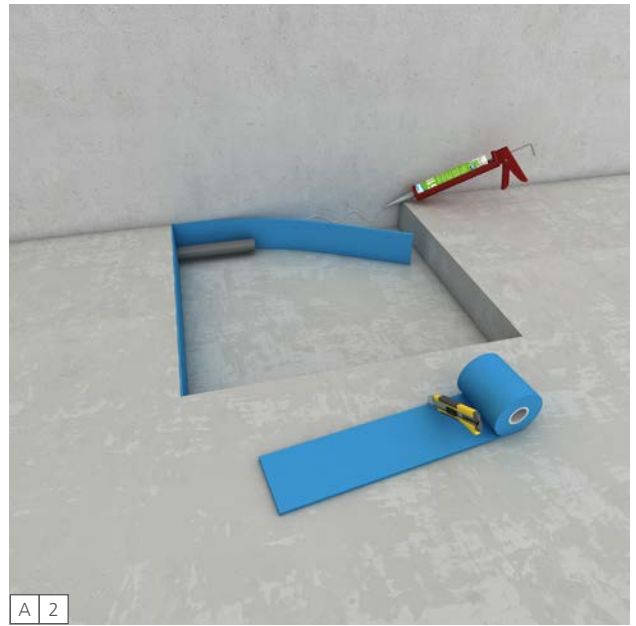
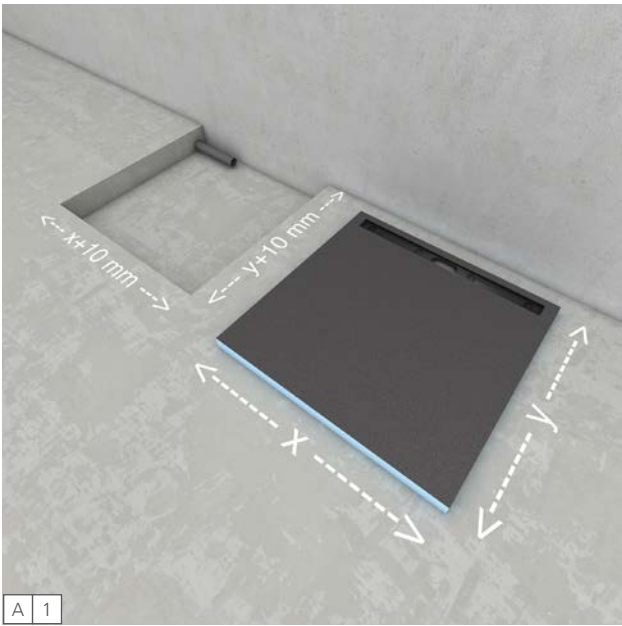

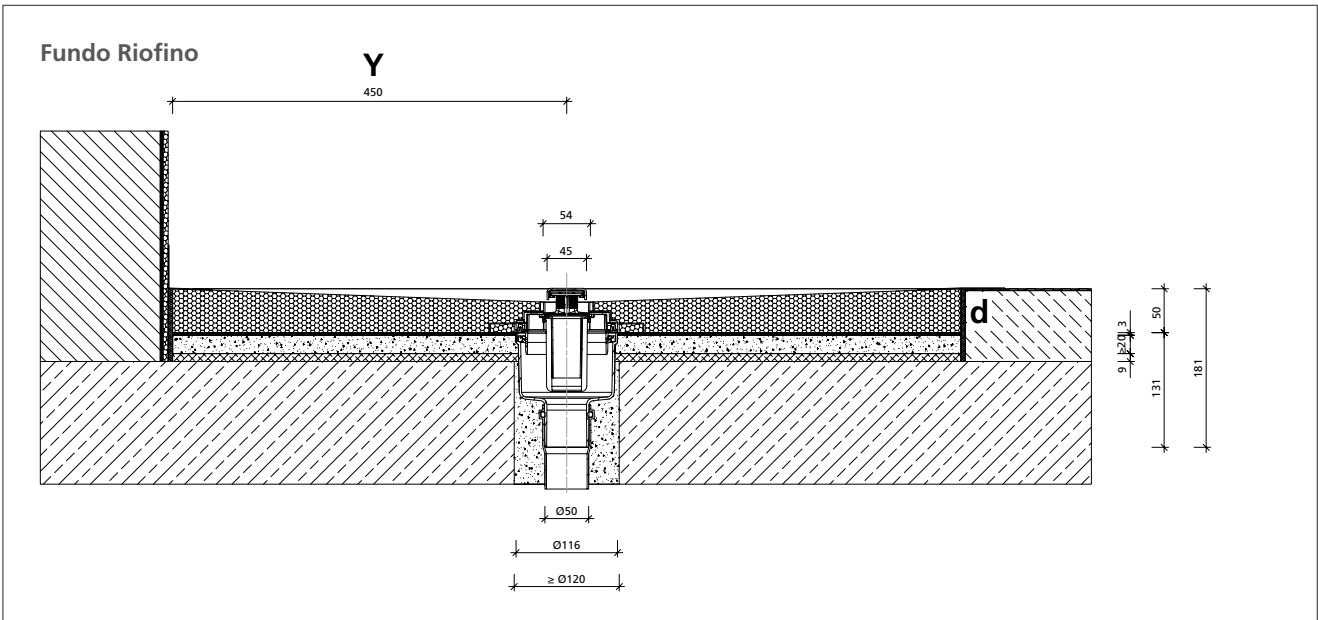
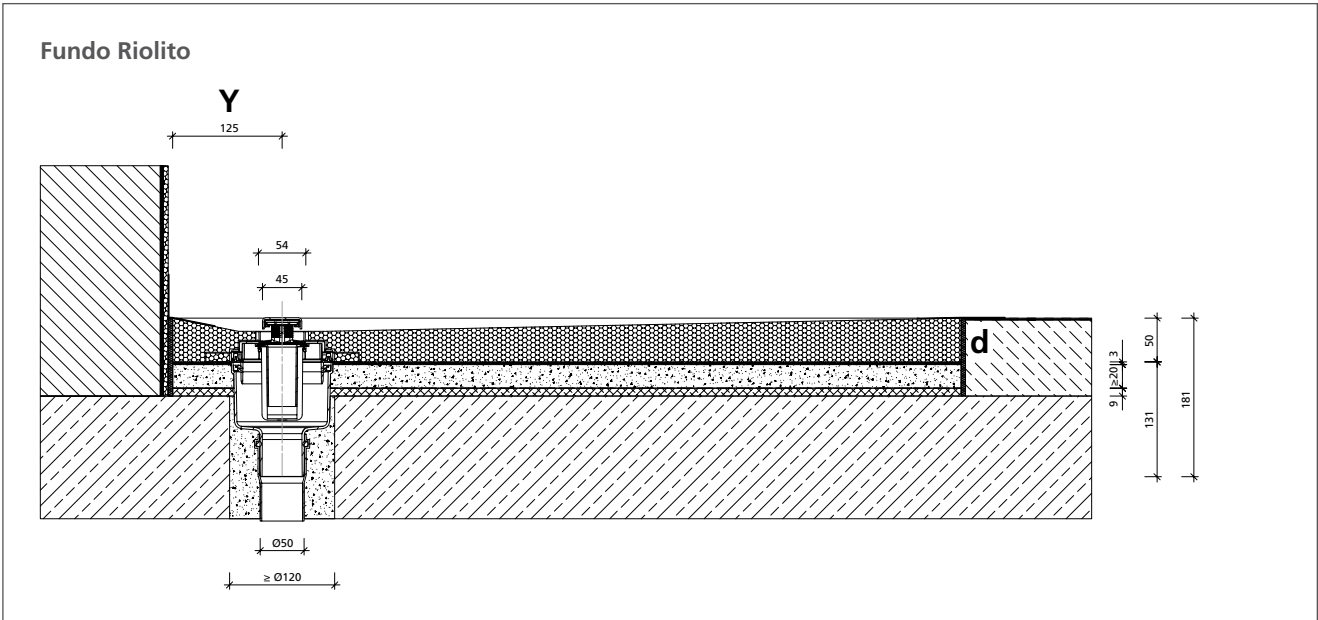
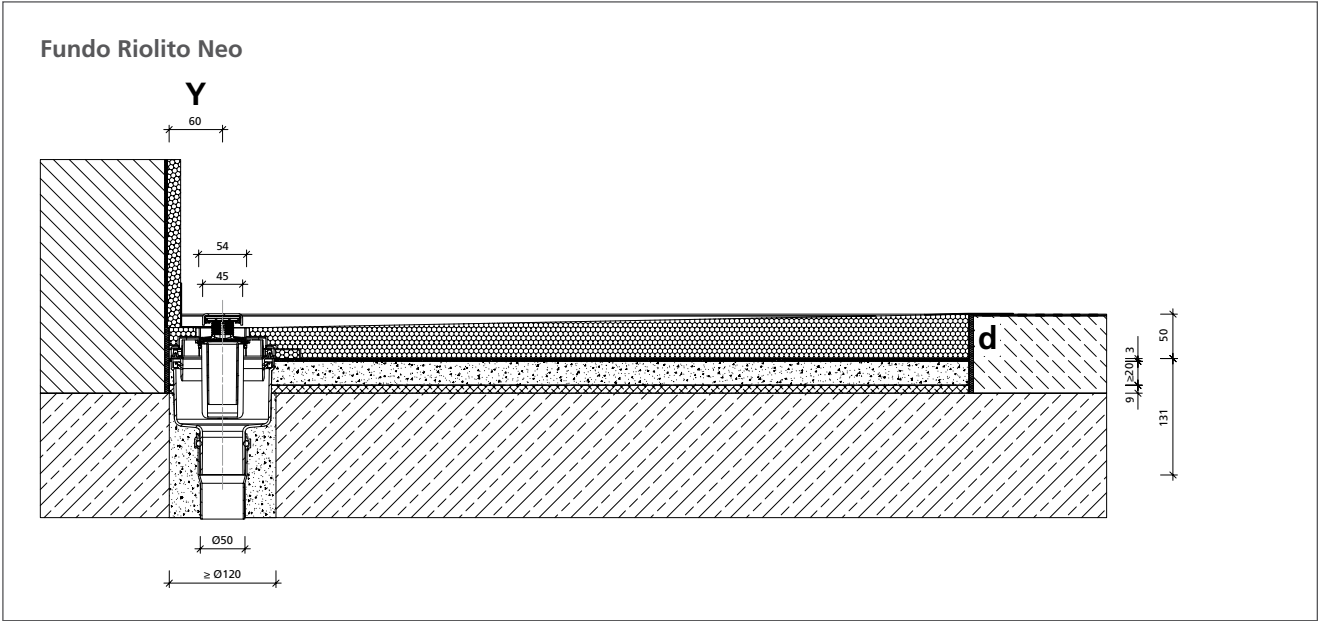



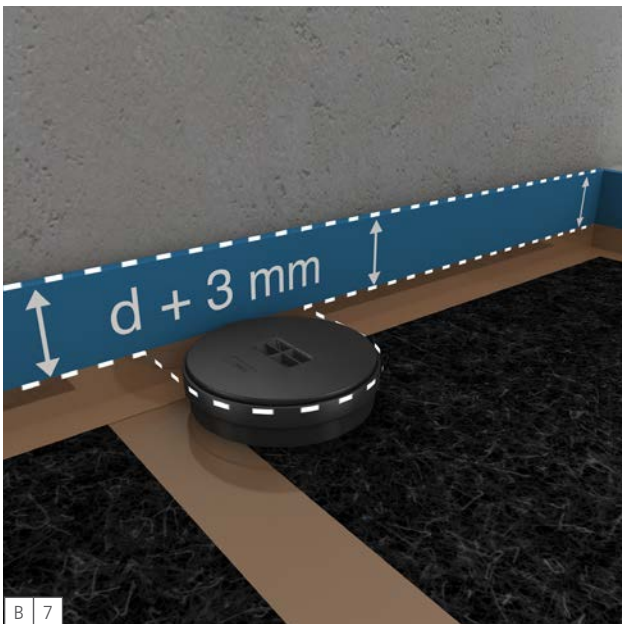
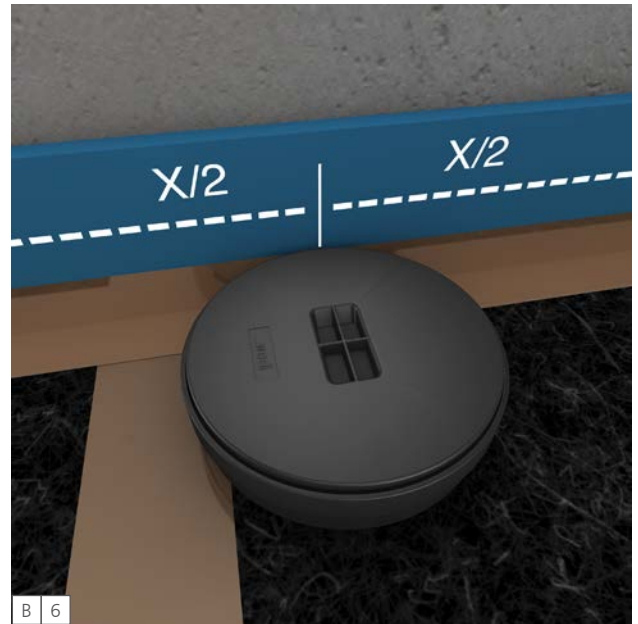
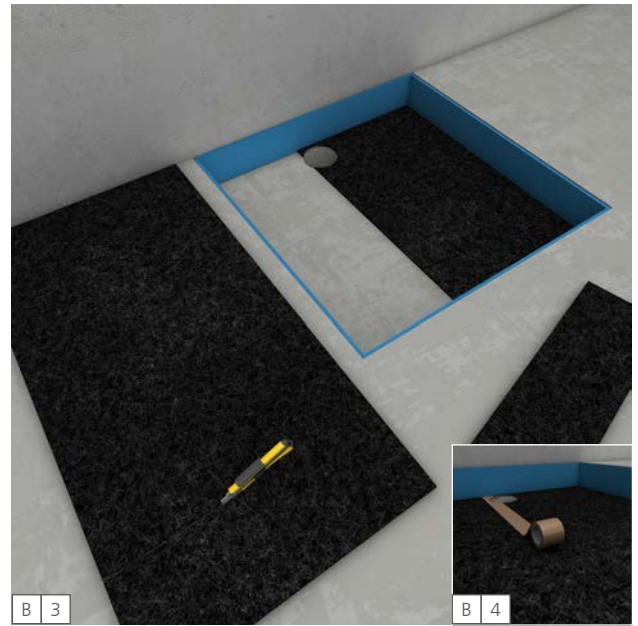
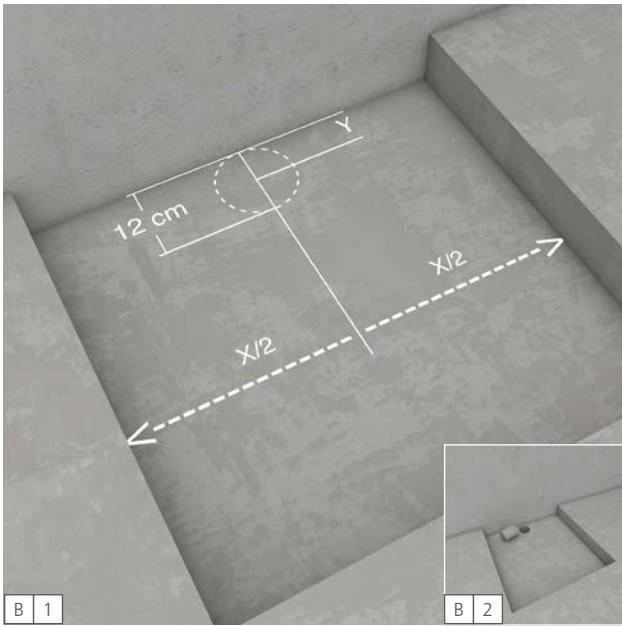

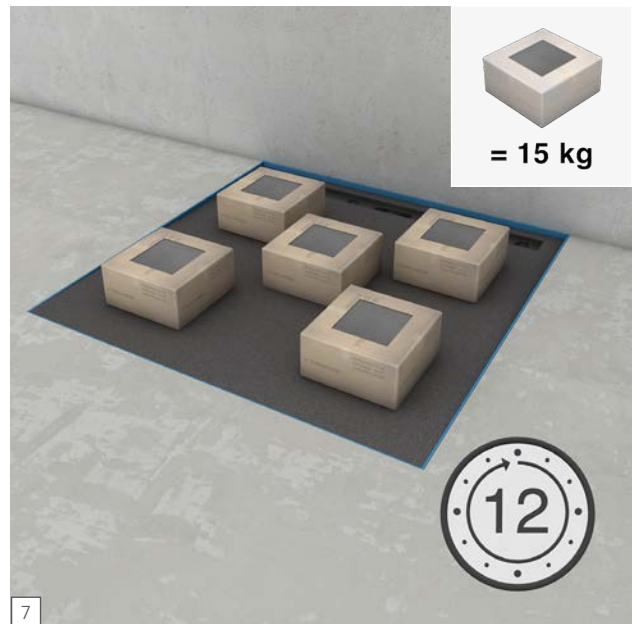
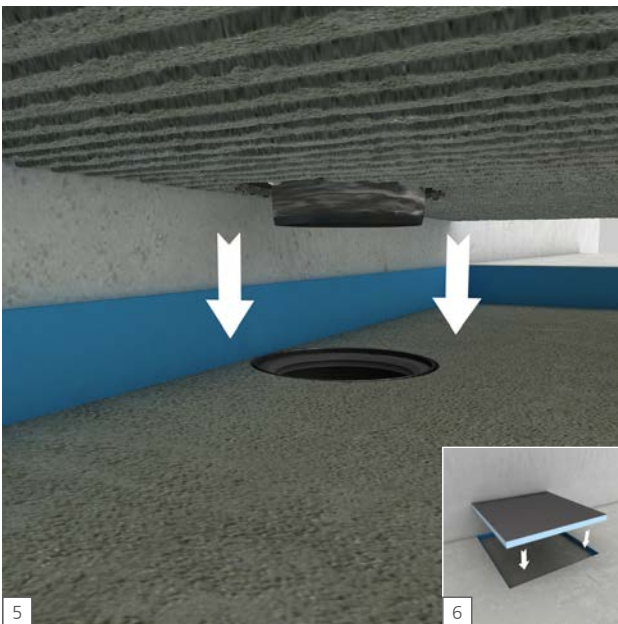
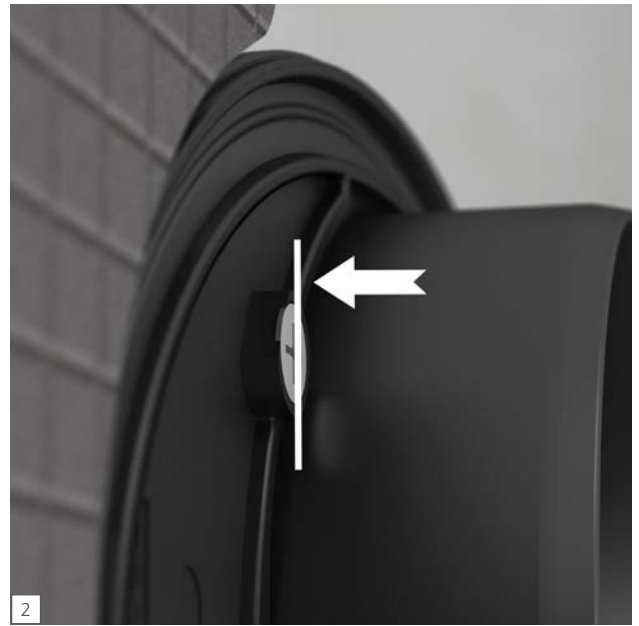
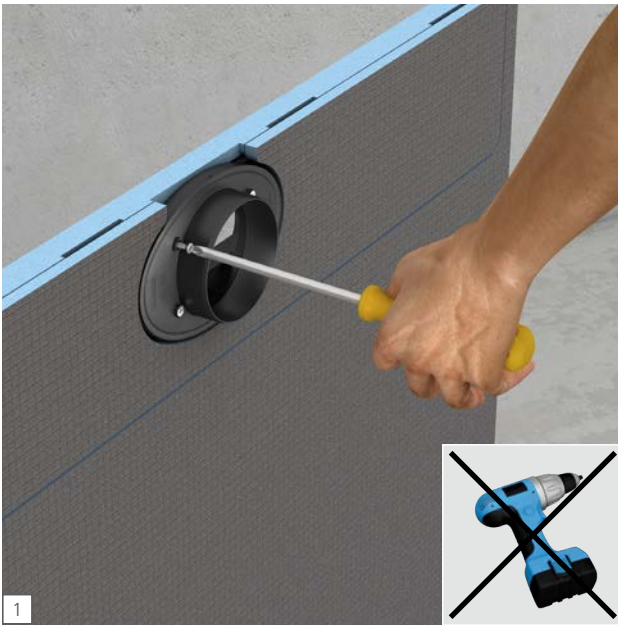



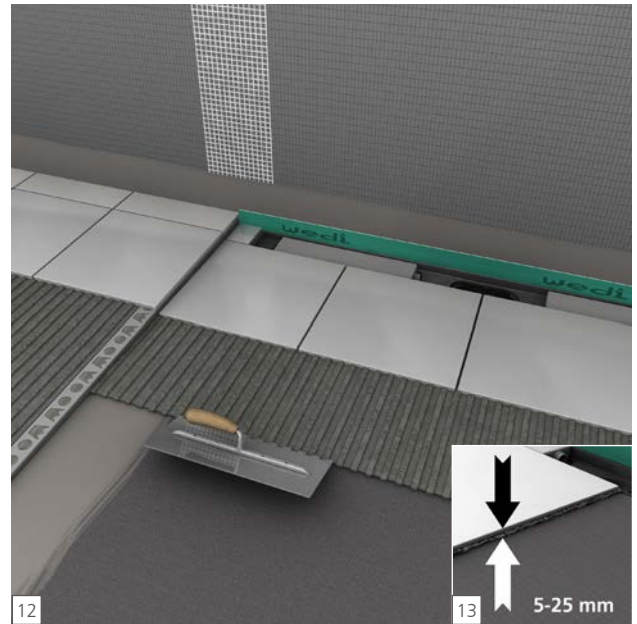
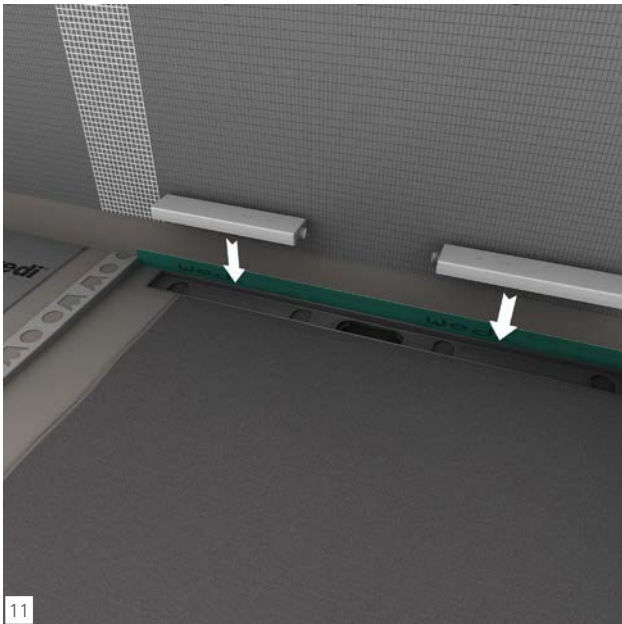
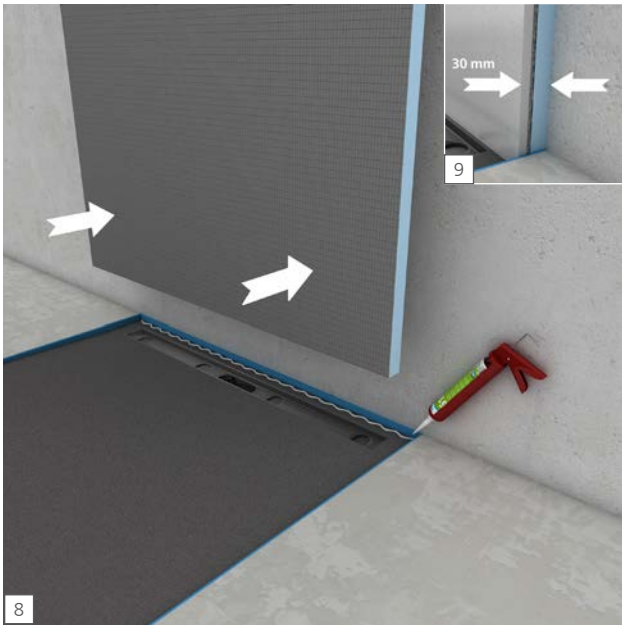

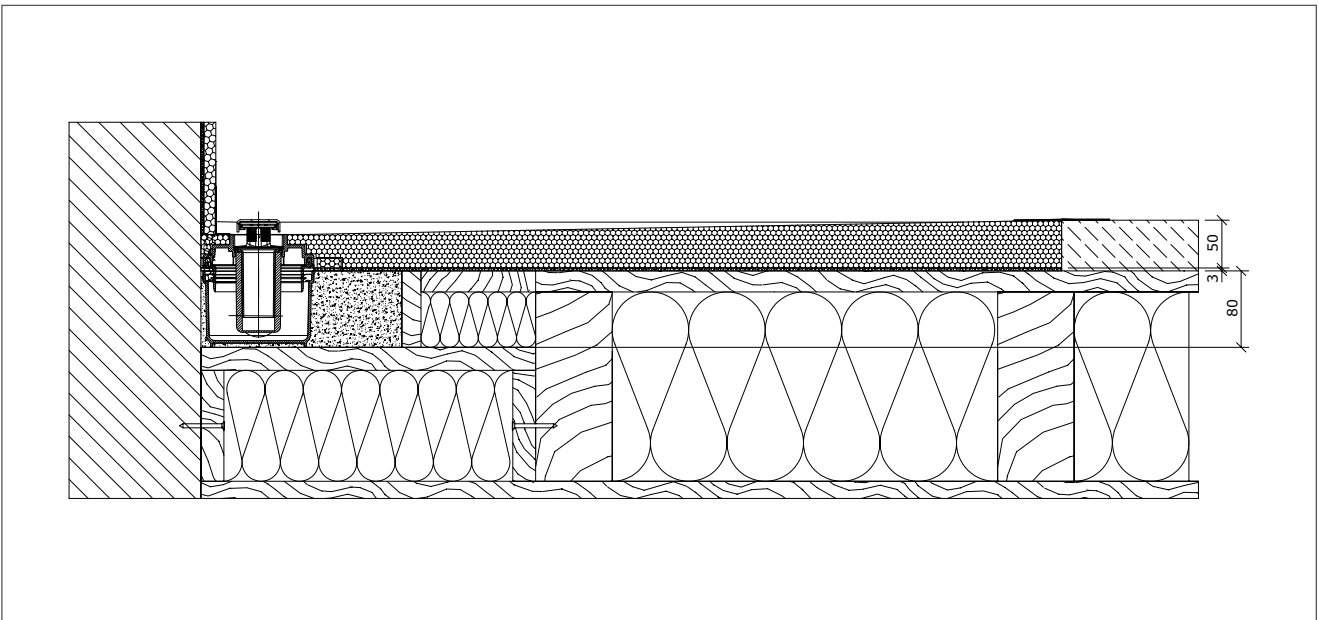
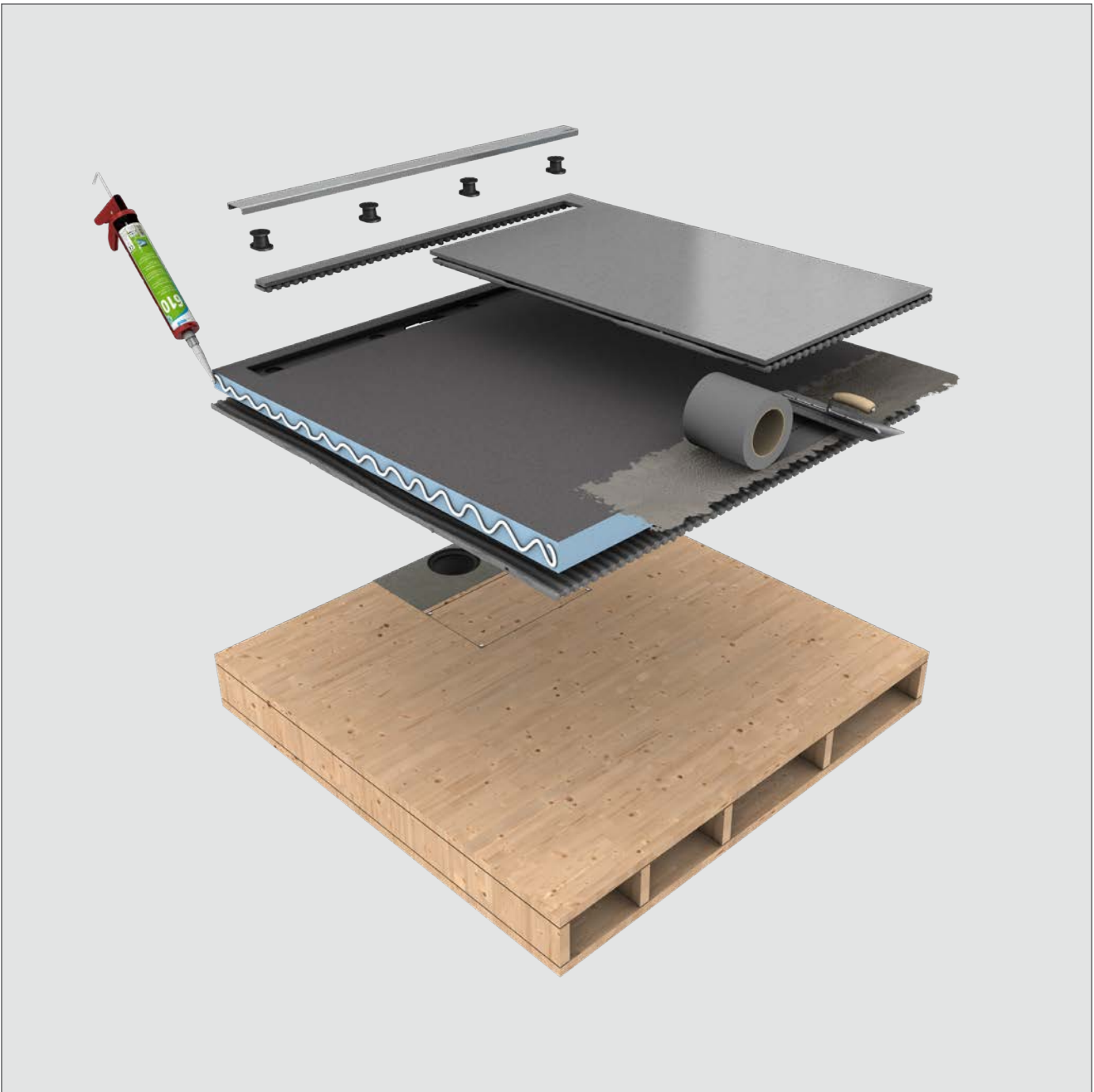

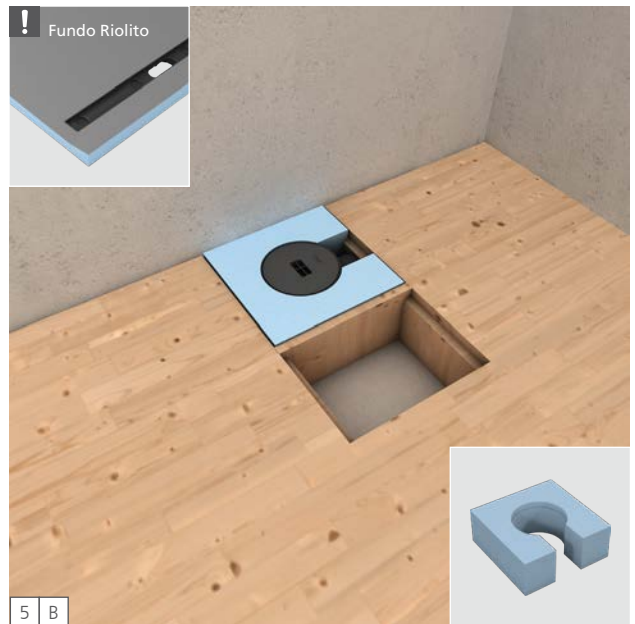
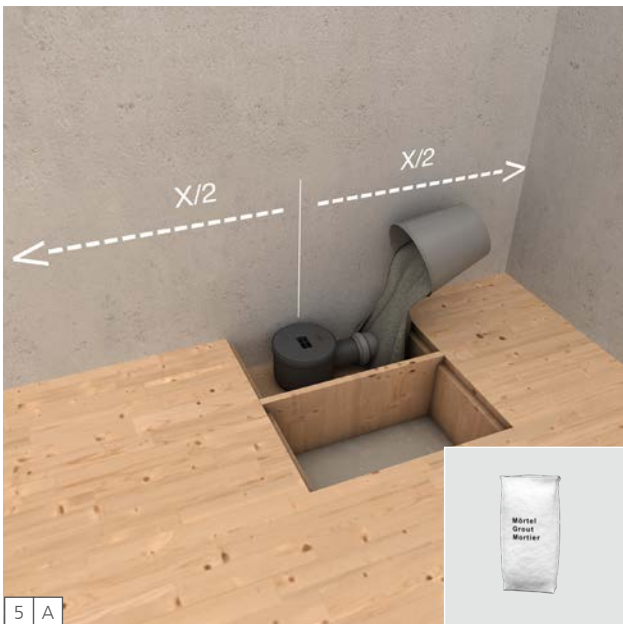
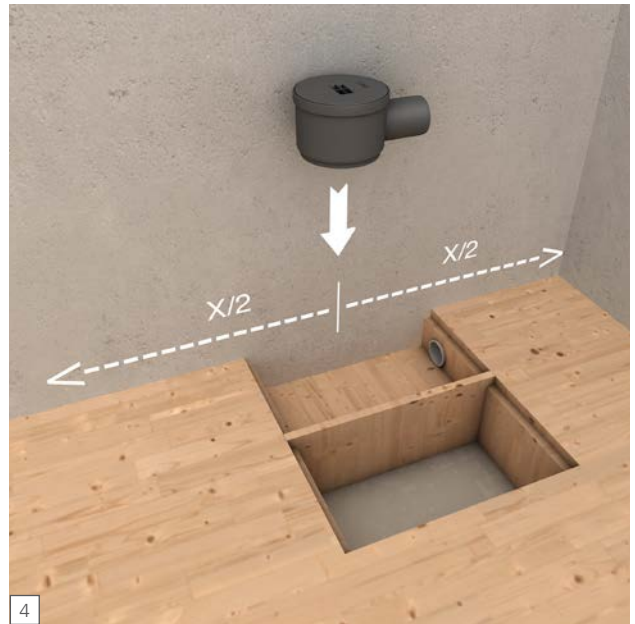
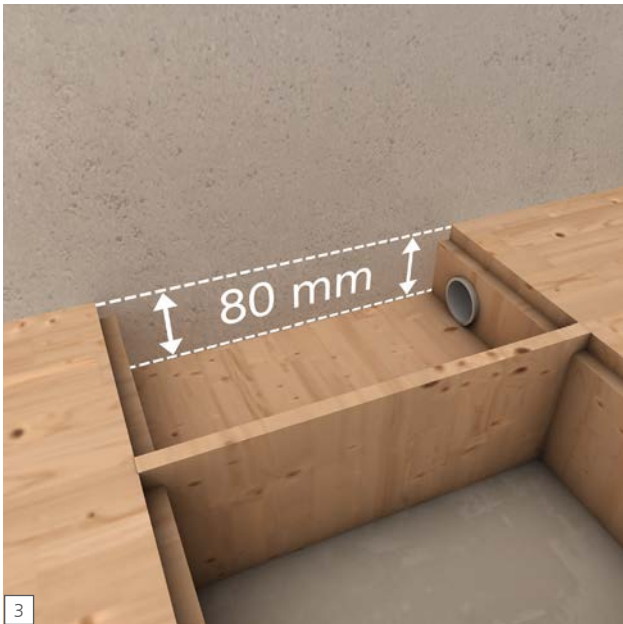
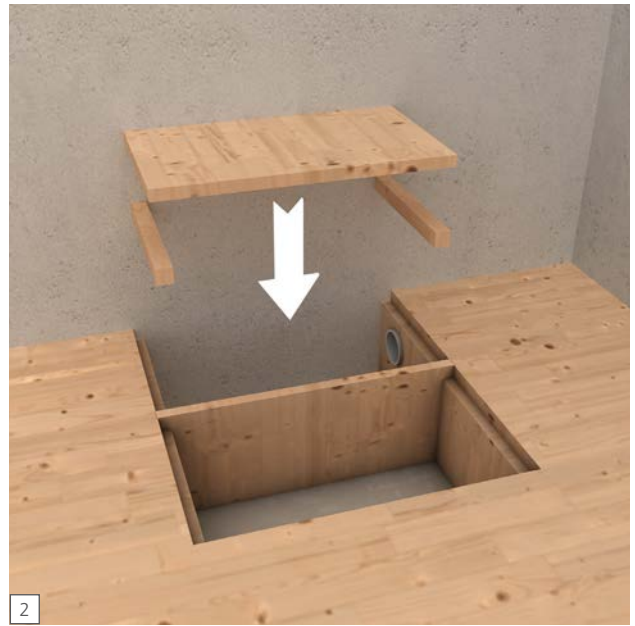
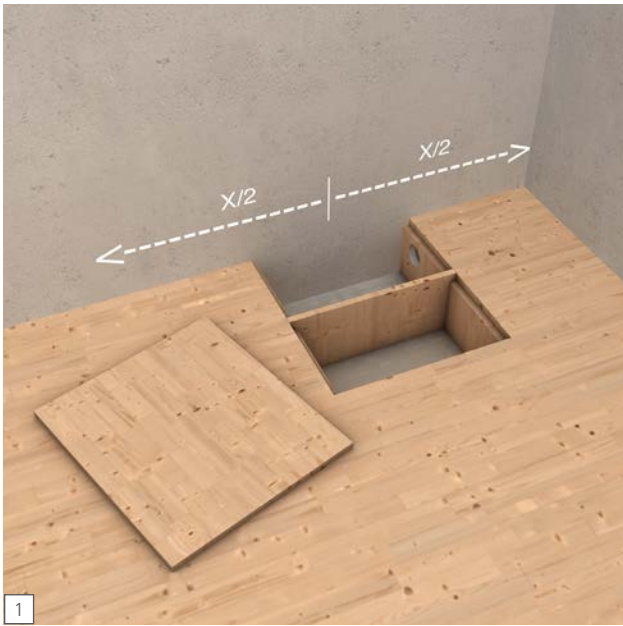



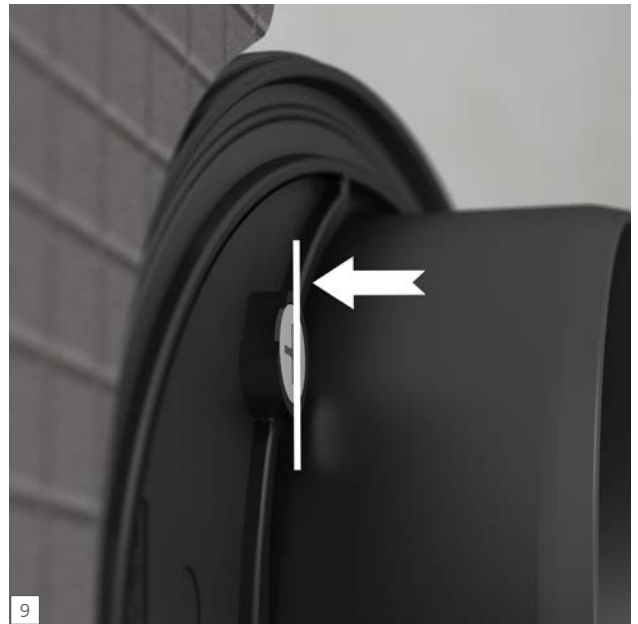
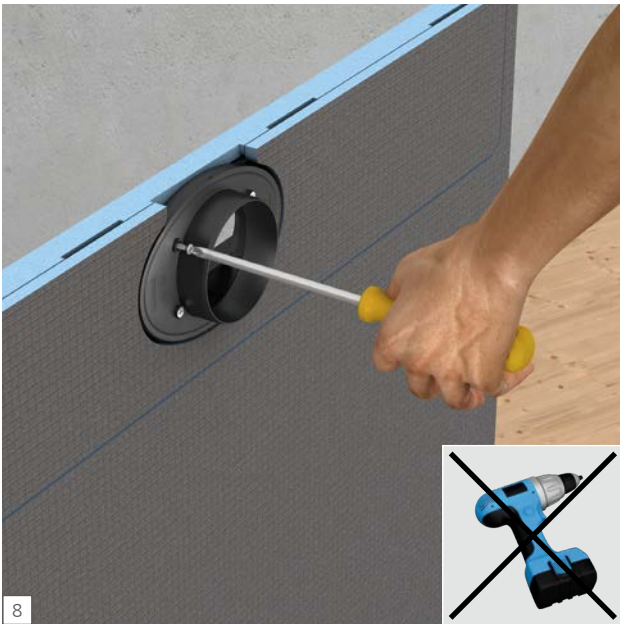
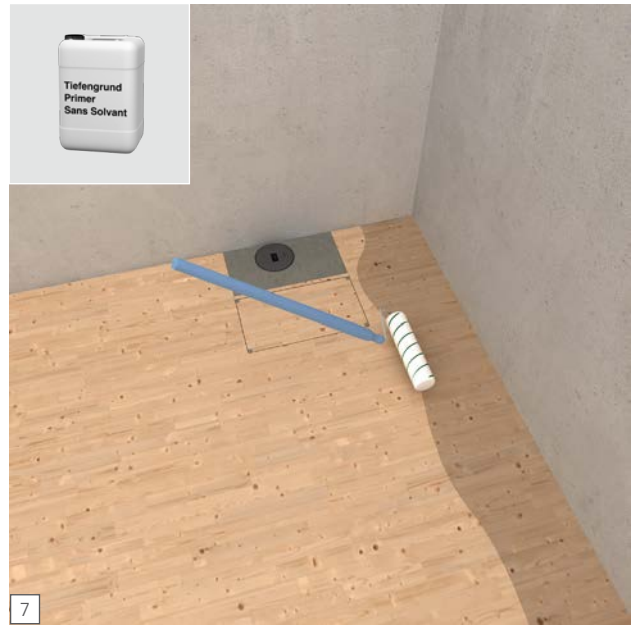



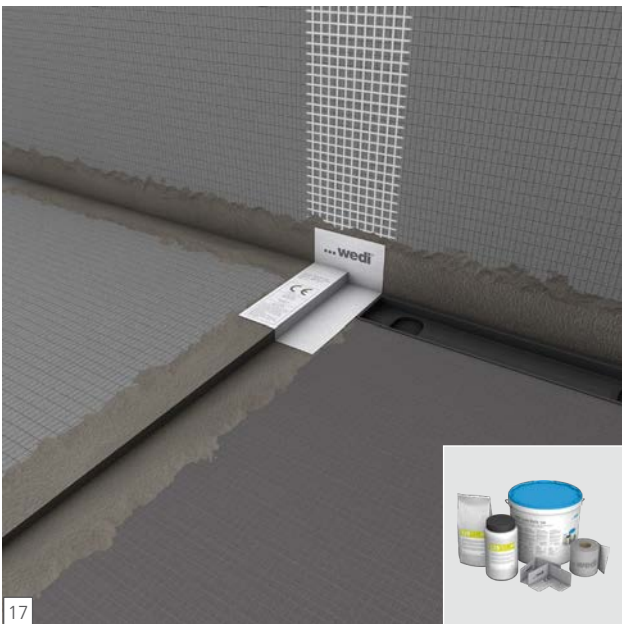
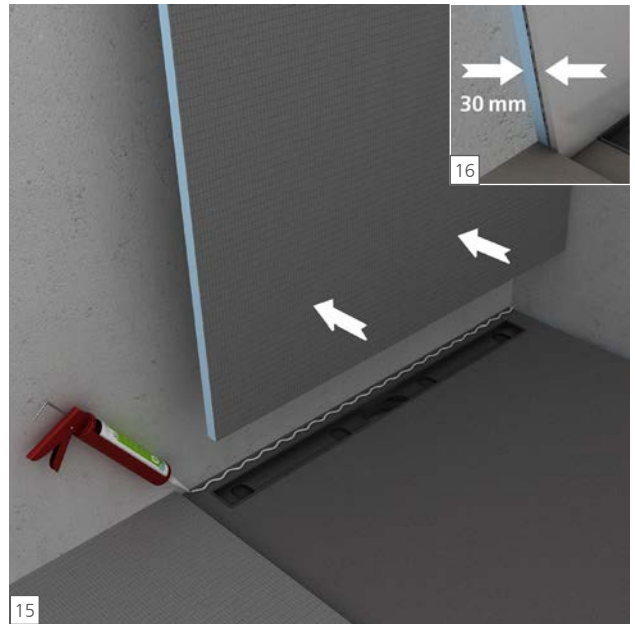
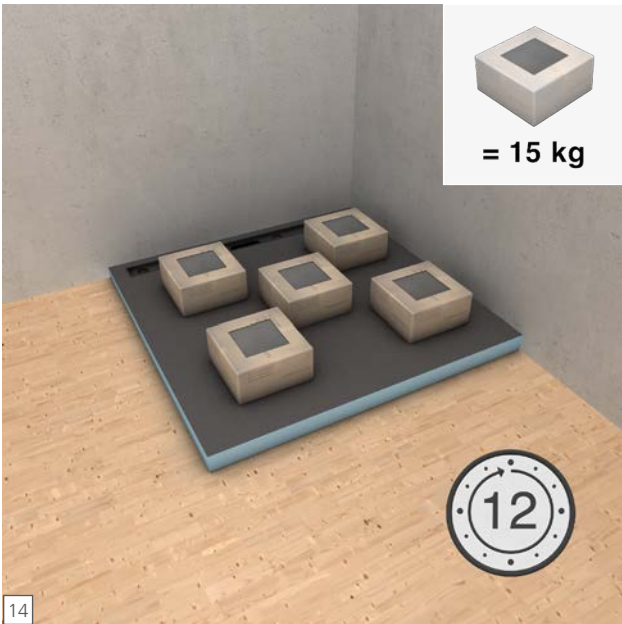
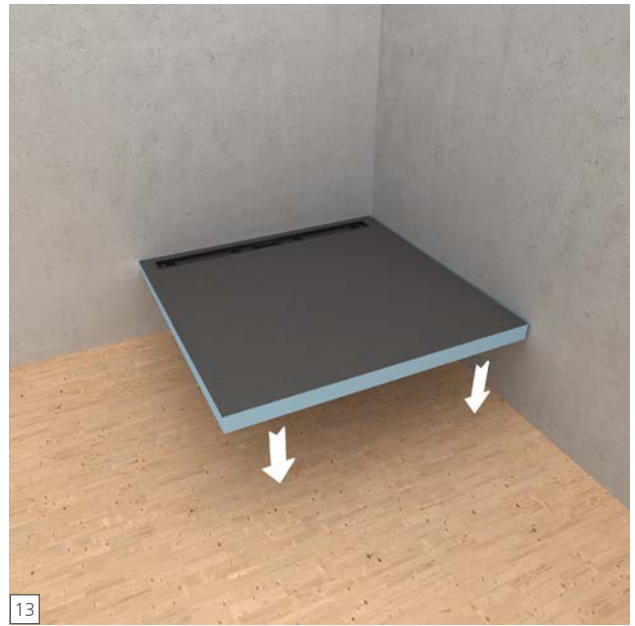
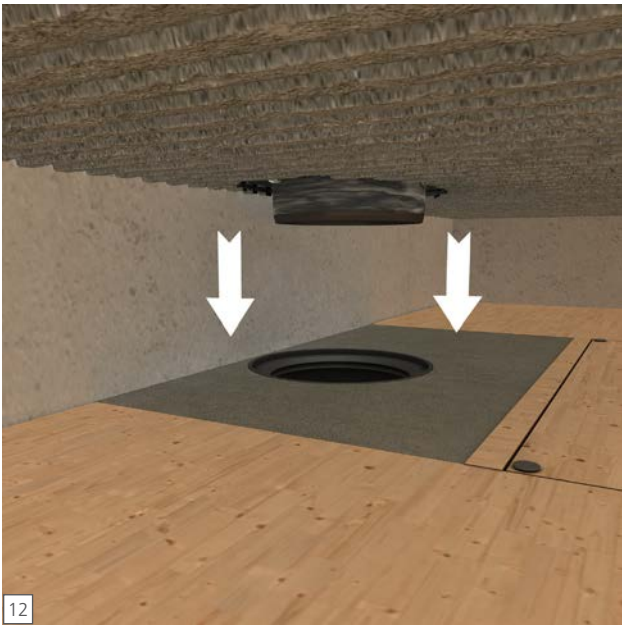

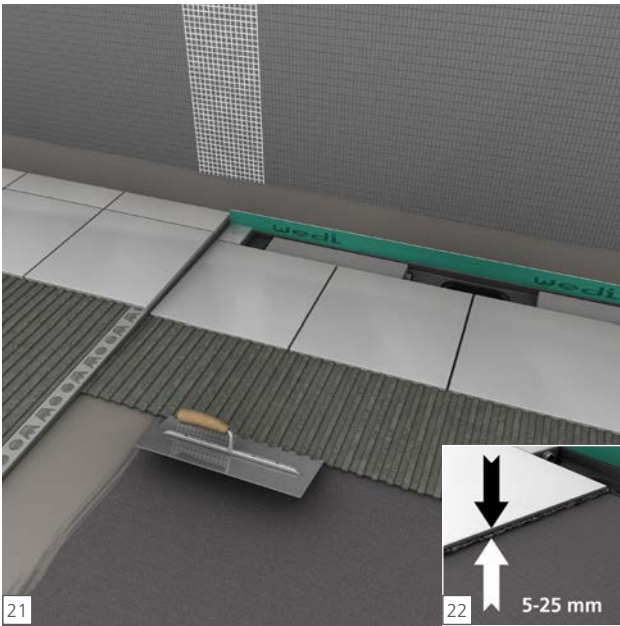
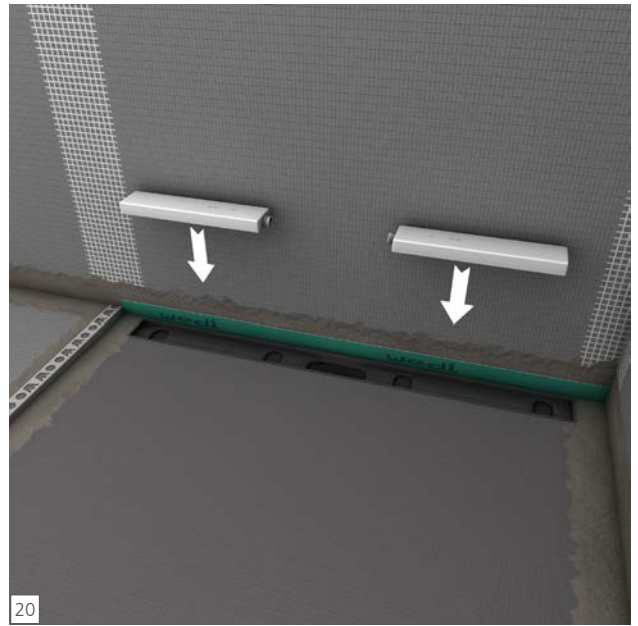
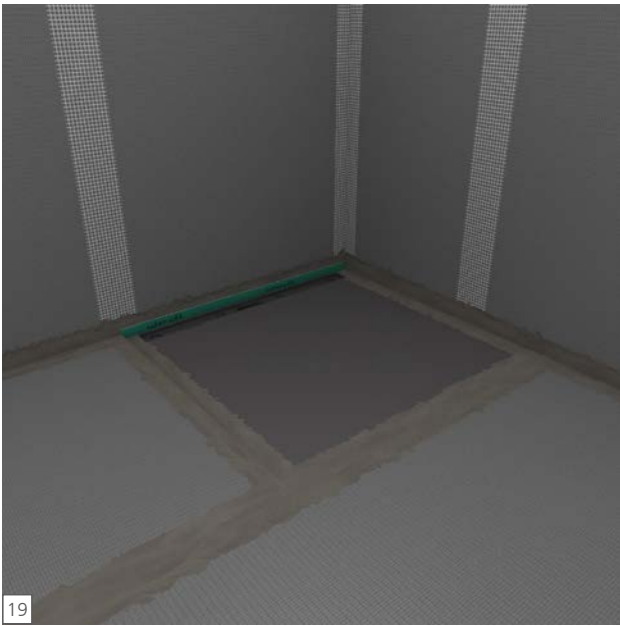









**wedi GmbH**

Hollefeldstraße 51  
48282 Emsdetten  
Deutschland

Telefon +49 25 72 156-0  
Telefax +49 25 72 156-133

info@wedi.de  
www.wedi.net